

Drawing name: K:\TAM_Civil\145187 - Aventura\000 - Clearwater\CADD\Exhibit\Preservation Zoning Modification Plan.dwg PRESERVATION ZONING MOD Mar. 25, 2021 12:31pm by: brion-naught

This document, together with the concepts and designs presented herein, is intended only for the specific purpose and client for which it was prepared. Use of and improper reliance on this document without written authorization and adaptation by Kimley-Horn and Associates, Inc. shall be without liability to Kimley-Horn and Associates, Inc.

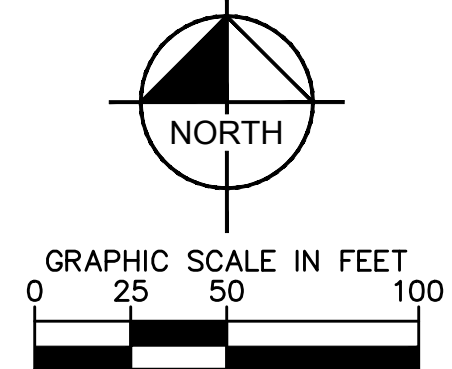
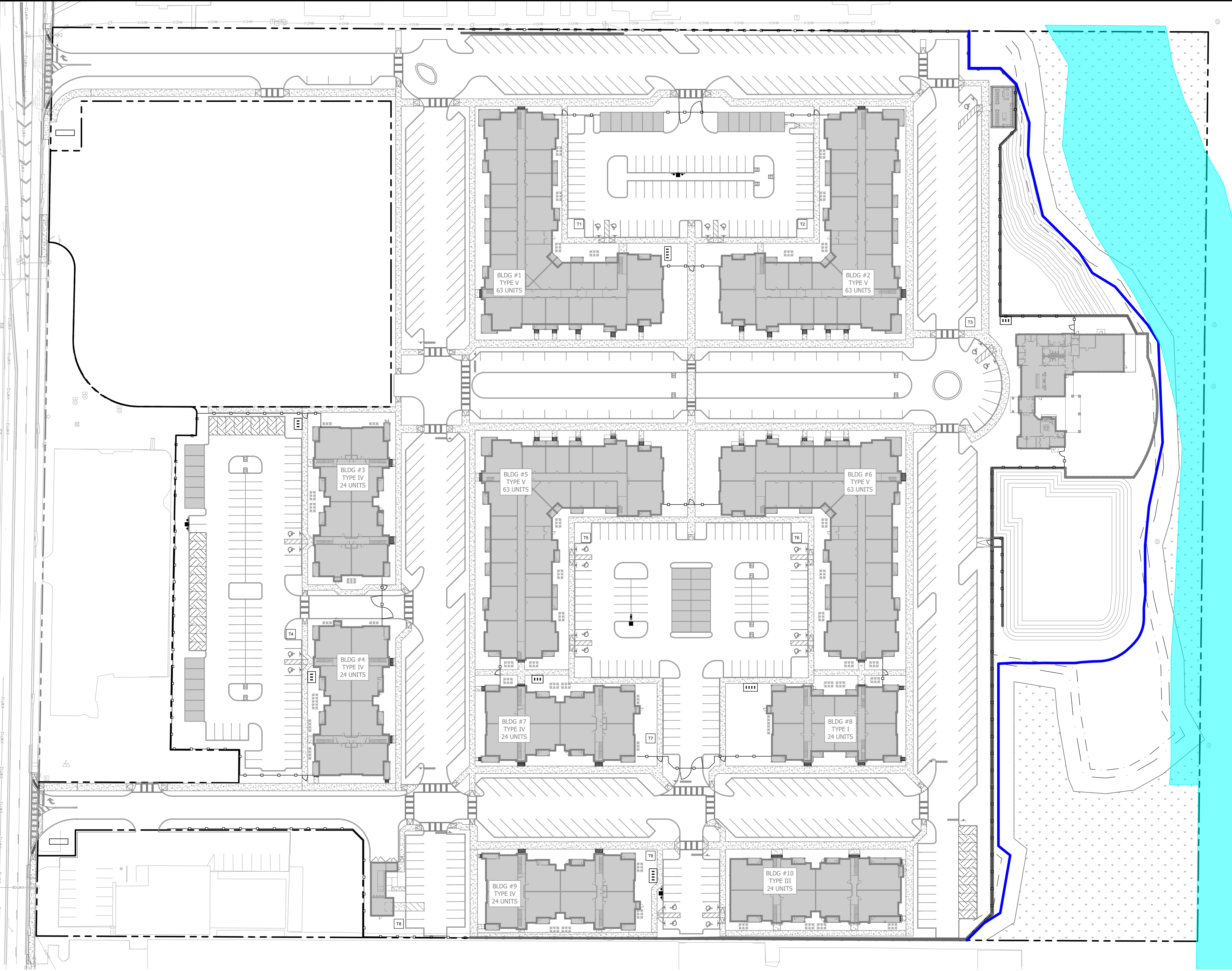

- LEGEND**
- PROPERTY LINE
 - - - 16' FT WETLAND BUFFER LINE (MIN.)
 - - - 25' WETLAND BUFFER LINE
 - AVERAGE WETLAND BUFFER
 - ▨ JD WETLAND BOUNDARY
 - PRESERVATION ZONING

NO.	REVISIONS	DATE	BY
1	SW/FMD / ECS FIRST REVIEW	03/12/21	MRF

Kimley-Horn
 © 2021 KIMLEY-HORN AND ASSOCIATES, INC.
 655 NORTH FRANKLIN STREET, SUITE 150, TAMPA, FL 33602
 PHONE: 813-620-1460
 WWW.KIMLEY-HORN.COM

DESIGN ENGINEER:
MATTHEW R. FEJAL, P.E.
 FLORIDA REGISTRATION NUMBER:
66397
 DATE:

SCALE:
 DESIGNED BY: DL
 DRAWN BY: BFN
 CHECKED BY: MRF

**PRESERVATION ZONING
 MODIFICATION PLAN**

**AVENTON
 CLEARWATER, FL
 SUNSET POINT RD & US 19**
 CITY OF CLEARWATER FLORIDA

DATE
 03/12/2021
 PROJECT NO.
 145187000

SHEET NUMBER
PZM

GROUNDWATER / DEWATERING NOTE:
 THE PRESENCE OF GROUNDWATER SHOULD BE ANTICIPATED ON THIS PROJECT. CONTRACTORS BID SHALL INCLUDE CONSIDERATION FOR THIS ISSUE, WHEN PERFORMING GRADING OPERATIONS DURING PERIODS OF WET WEATHER. PROVIDE ADEQUATE DEWATERING, DRAINAGE AND GROUND WATER MANAGEMENT TO CONTROL MOISTURE OF SOILS.

