

Z/LU-20-08

Location Map

Zoning

From: R-4 - One, Two & Three Family Residential

To: RM - Multi-Family Residential (3.95 acres)

Land Use

From: Residential Urban

To: Residential Low Medium (5.7 acres)

Multiple parcels (see staff report)

Prepared by: Pinellas County Planning Division



Date: 7/30/2020



1 inch = 4.5 miles



Z/LU-20-08
Current Land Use & Zoning

Zoning From: R-4 - One, Two & Three Family Residential
 To: RM - Multi-Family Residential (3.95 acres)

Land Use From: Residential Urban
 To: Residential Low Medium (5.7 acres)

Multiple parcels (see staff report)

Prepared by: Pinellas County Planning Division



Date: 7/30/2020



1 inch = 0.09 miles



Z/LU-20-08

Aerial Map

Zoning

From: R-4 - One, Two & Three Family Residential

To: RM - Multi-Family Residential (3.95 acres)

Land Use

From: Residential Urban

To: Residential Low Medium (5.7 acres)



Multiple parcels (see staff report)

Prepared by: Pinellas County Planning Division



Date: 7/30/2020

1 inch = 0.09 miles

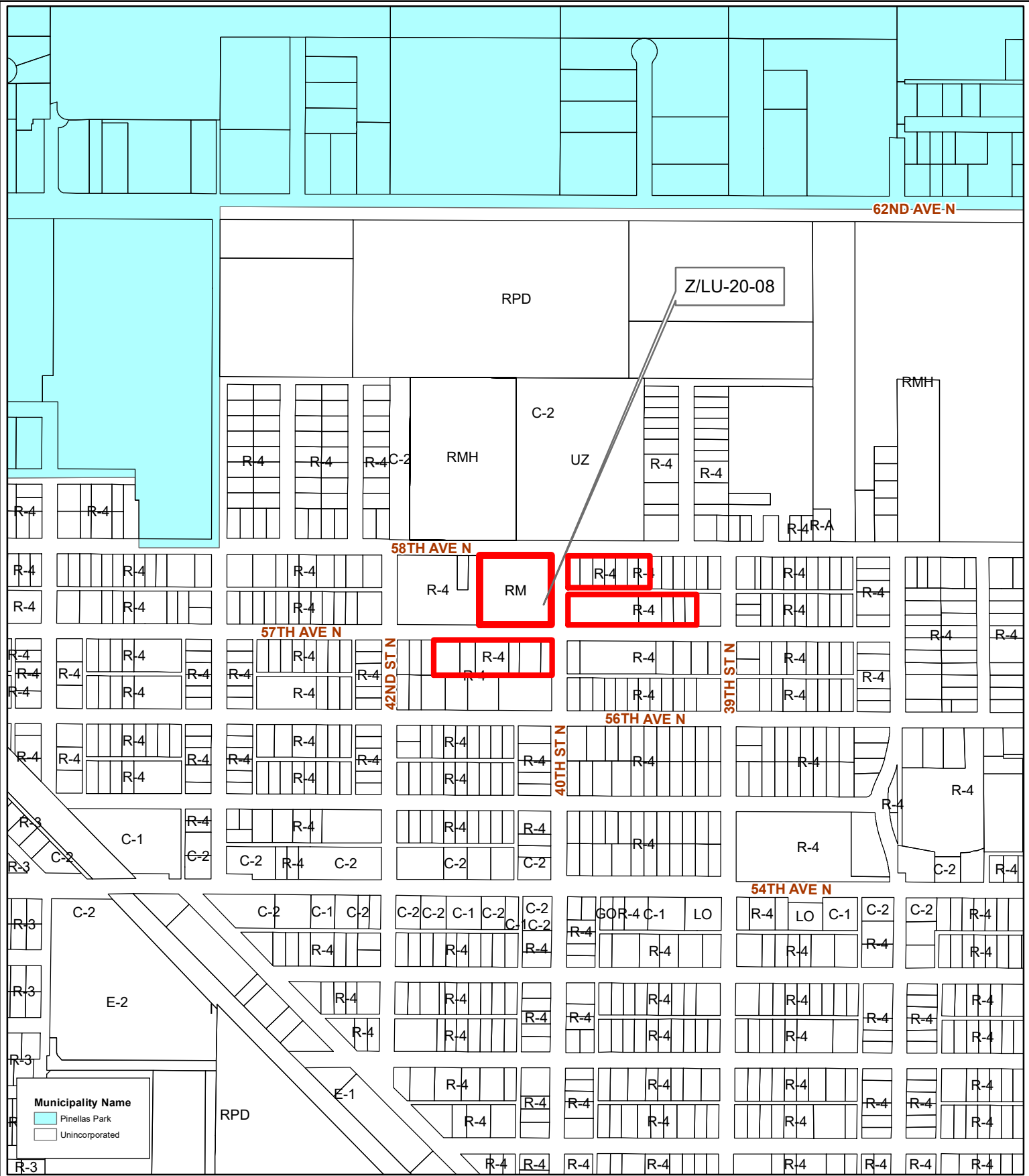

Z/LU-20-08
Municipal Map

Zoning From: R-4 - One, Two & Three Family Residential
 To: RM - Multi-Family Residential (3.95 acres)

Land Use From: Residential Urban
 To: Residential Low Medium (5.7 acres)



Multiple parcels (see staff report)

Prepared by: Pinellas County Planning Division



Date: 7/30/2020

1 inch = 0.09 miles



Z/LU-20-08
Proposed Land Use & Zoning

Zoning From: R-4 - One, Two & Three Family Residential
 To: RM - Multi-Family Residential (3.95 acres)

Land Use From: Residential Urban
 To: Residential Low Medium (5.7 acres)

Multiple parcels (see staff report)

Prepared by: Pinellas County Planning Division



Date: 7/30/2020



1 inch = 0.09 miles