

# SITE IMPROVEMENT PLANS

FOR

# CSA PALM HARBOR RECREATIONAL FIELD

1550 16th STREET

PALM HARBOR, FL 34683

UNINCORPORATED PINELLAS COUNTY

PARCEL No. 01-28-15-13068-000-0010

SECTION 1, TOWNSHIP 28 S., RANGE 15 E.

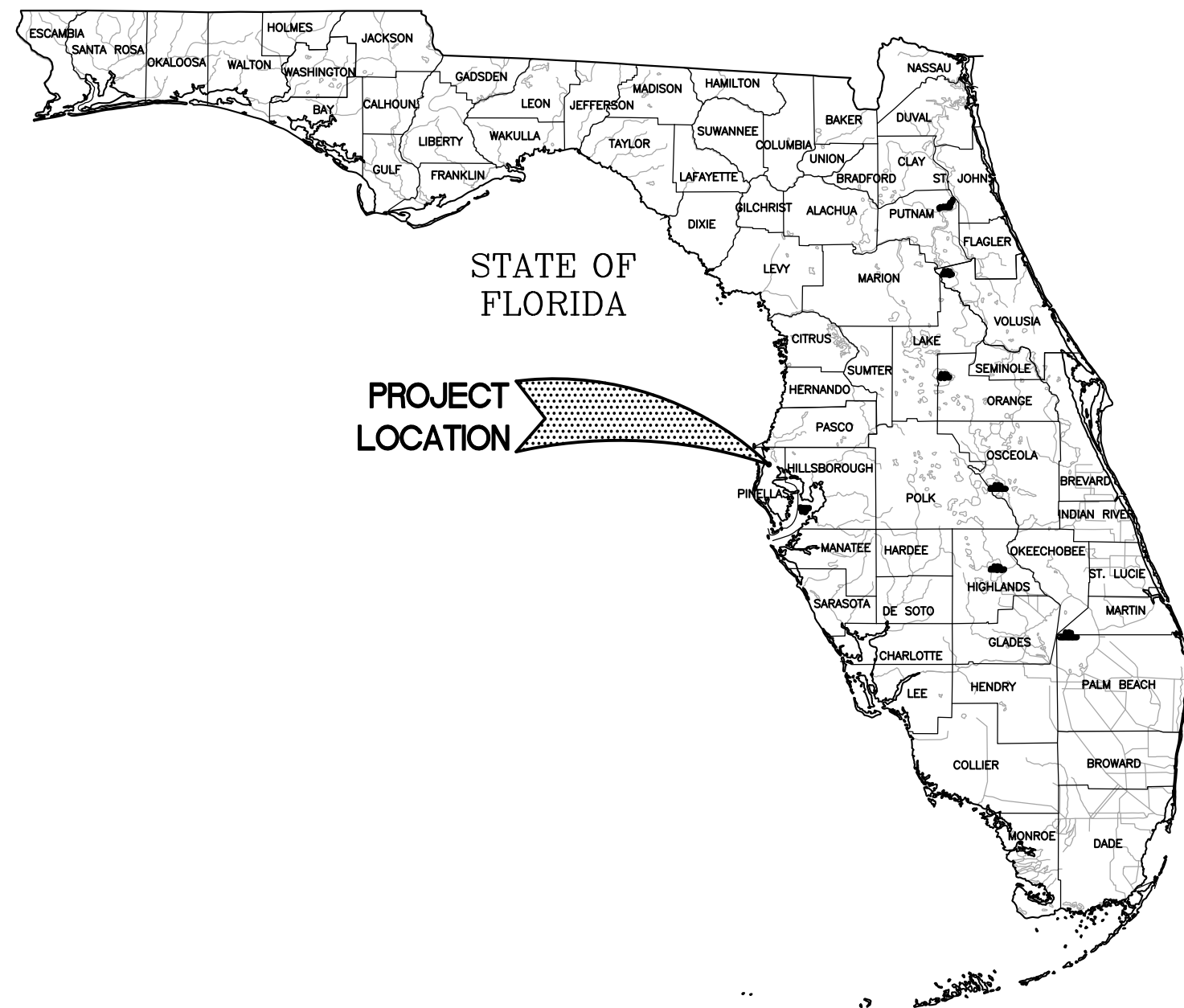

VICINITY MAP

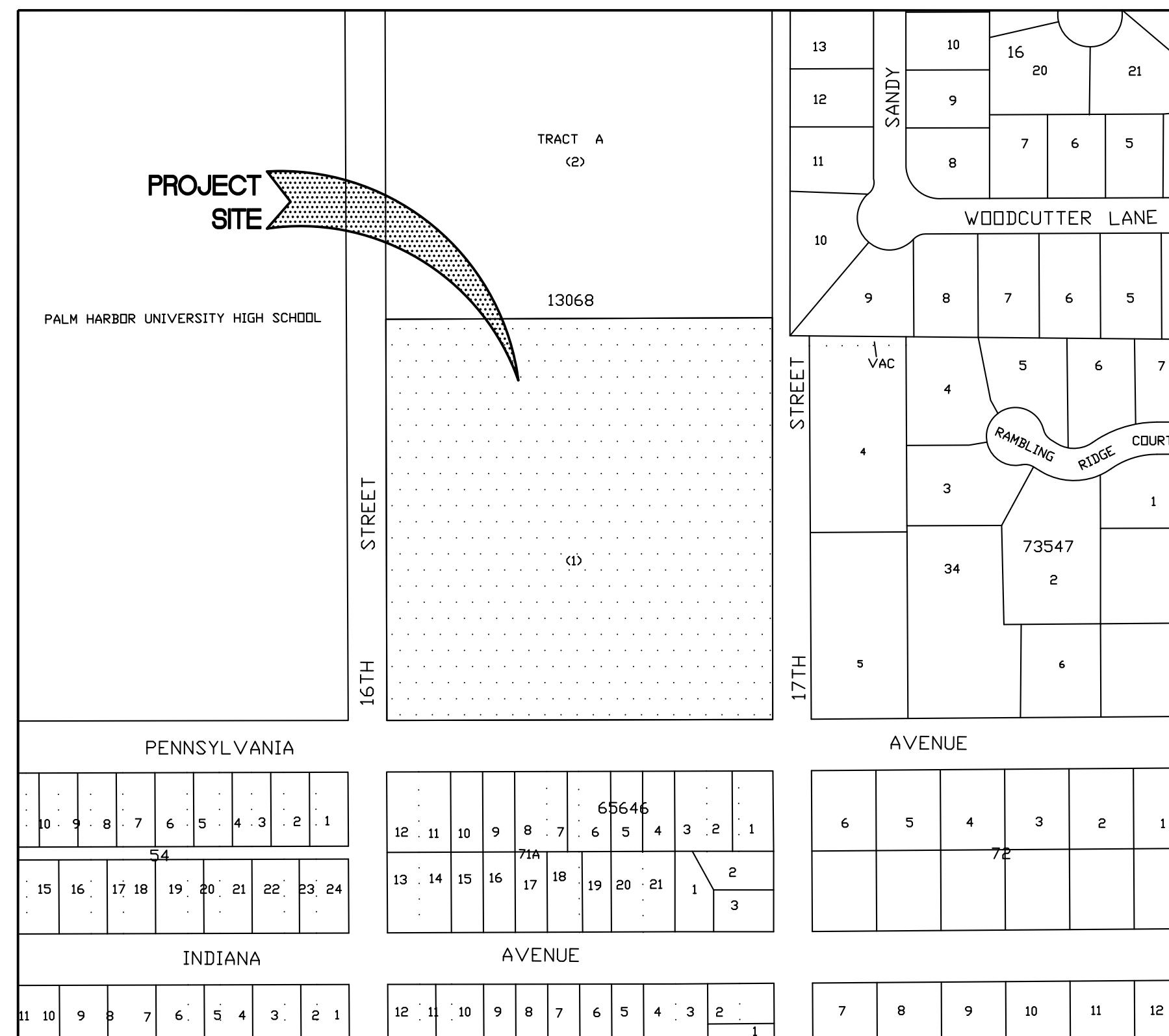

## CONTACTS

**OWNER:**  
PINELLAS COUNTY  
ATTN: REAL ESTATE MANAGEMENT  
315 COURT STREET  
CLEARWATER, FL 33756  
(727) 464-3496

TAMPA, FL 33609  
(813) 509-2403  
**CONTACT: JOSÉ MARTINEZ**  
JMARTINEZ@BOWMANCONSULTING.COM

**DEVELOPER:**  
CSA PALM HARBOR PARKS & RECREATION  
1550 16TH STREET  
PALM HARBOR, FL 34683  
(727) 771-6000  
**CONTACT: ERICA LYNFORD**

**LOCAL / RIGHT-OF-WAY JURISDICTION:**  
PINELLAS COUNTY  
315 COURT STREET  
CLEARWATER, FL 33756  
(727) 464-3377

**LIVERPOOL FC INTERNATIONAL ACADEMY AMERICA - WEST FLORIDA**  
410 PARK PLACE BLVD.  
CLEARWATER, FL 33759  
(727) 638-3215  
**CONTACT: ERIC LINDSEY**  
ERIC.LINDSEY@LIVERPOOLFCAMERICA.COM

**WATER MANAGEMENT DISTRICT:**  
SOUTHWEST FLORIDA  
WATER MANAGEMENT DISTRICT  
7601 U.S. HIGHWAY 301  
TAMPA, FL 33637  
(813) 985-7481

**CIVIL ENGINEER:**  
BOWMAN CONSULTING GROUP, LTD.  
4830 W. KENNEDY BLVD., SUITE 600

## SHEET INDEX

Sheet Number	Sheet Title
C-0.0	COVER SHEET
C-1.0	GENERAL NOTES
C-1.1	GENERAL NOTES
C-2.0	SITE PLAN
C-3.0	GRADING AND DRAINAGE PLAN
1 OF 4	TOPOGRAPHIC SURVEY
2 OF 4	TOPOGRAPHIC SURVEY
3 OF 4	TOPOGRAPHIC SURVEY
4 OF 4	TOPOGRAPHIC SURVEY

**Bowman**  
CONSULTING  
Certificate of Authorization License No. 30462

Bowman Consulting Group, Ltd.  
One Urban Centre  
4830 W. Kennedy Blvd.  
Suite 600  
Tampa, FL 33609  
Phone: (813) 509-2403  
www.bowmanconsulting.com  
© Bowman Consulting Group, Ltd.

COVER SHEET  
CSA PALM HARBOR  
RECREATIONAL FIELD  
PALM HARBOR, FLORIDA  
PINELLAS COUNTY

PLAN STATUS

DATE	DESCRIPTION
JM	JM JM
DESIGN	DRAWN CHKD
SCALE	AS SHOWN
JOB No.	00000-00-000
DATE	12/01/2016
FILE	COV.DWG
SHEET	C-0.0

THIS DOCUMENT, TOGETHER WITH THE CONCEPTS AND DESIGNS PRESENTED HEREIN, AS AN INSTRUMENT OF SERVICE, IS INTENDED ONLY FOR THE SPECIFIC PURPOSE AND CLIENT FOR WHICH IT WAS PREPARED. REUSE OF AND IMPROPER RELIANCE ON THIS DOCUMENT WITHOUT WRITTEN AUTHORIZATION AND ADAPTATION BY BOWMAN CONSULTING SHALL BE WITHOUT LIABILITY TO BOWMAN CONSULTING.







THIS DOCUMENT, TOGETHER WITH THE CONCEPTS AND DESIGNS PRESENTED HEREIN, AS AN INSTRUMENT OF SERVICE, IS INTENDED ONLY FOR THE SPECIFIC PURPOSE AND CLIENT FOR WHICH IT WAS PREPARED. REUSE OF AND IMPROPER RELIANCE ON THIS DOCUMENT WITHOUT WRITTEN AUTHORIZATION AND ADAPTATION BY BOWMAN CONSULTING SHALL BE WITHOUT LIABILITY TO BOWMAN CONSULTING.

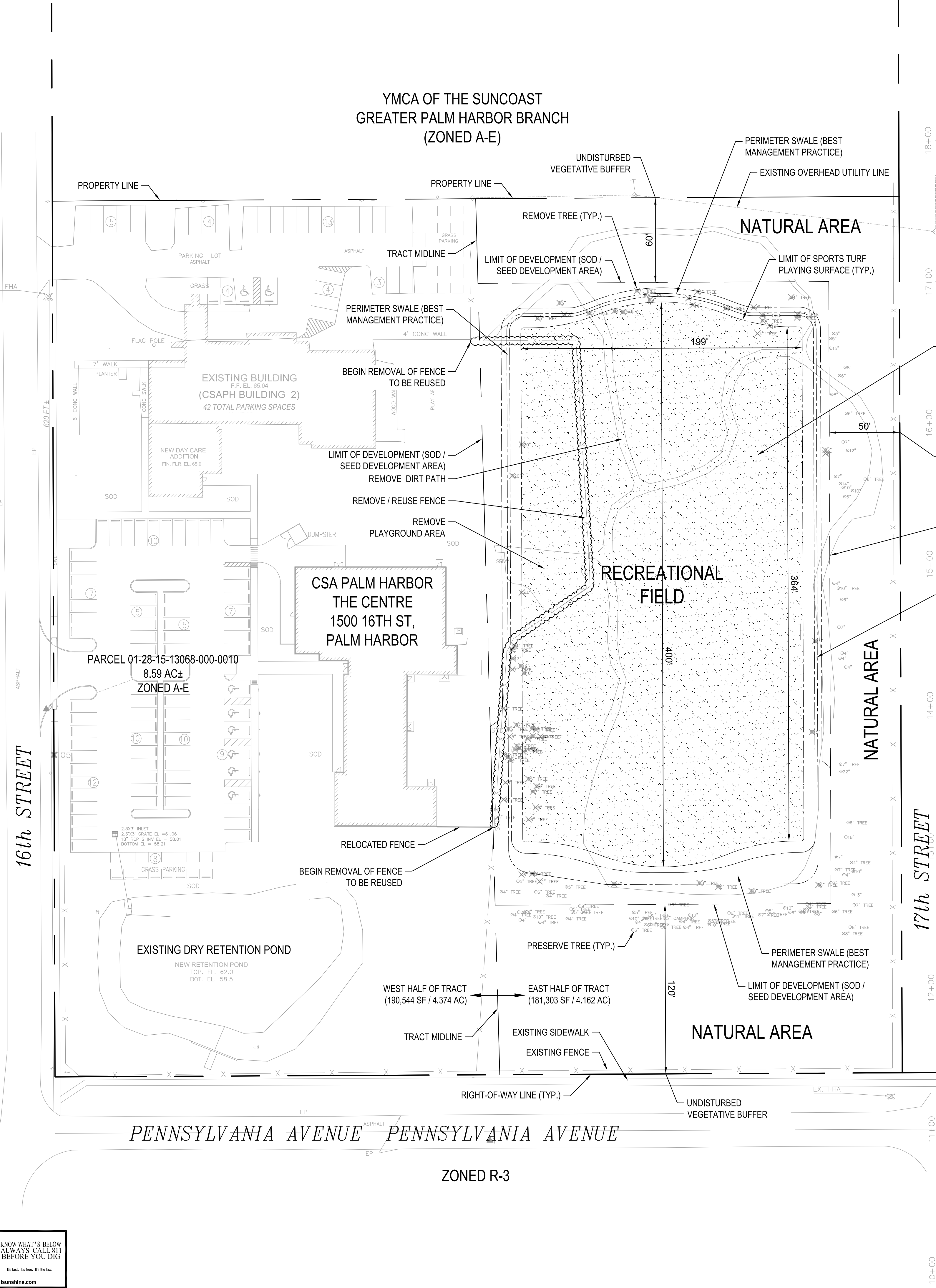

### LEGEND

- PROPERTY / RIGHT-OF-WAY LINE
- BUFFER LINE
- SPORTS TURF SURFACE
- SWALE CONTOUR LINE
- FENCE
- ♿ ACCESSIBLE PARKING SPACE
- NUMBER OF CONTIGUOUS PARKING SPACES
- 4" \* 12" PRESERVED EXISTING TREE AND DIAMETER BREAST HEIGHT
- ⊗ 4" \* 12" REMOVED EXISTING TREE AND DIAMETER BREAST HEIGHT

### TREE REMOVAL SUMMARY

DBH (INCHES)	NUMBER OF TREES REMOVED	DBH (INCHES)	NUMBER OF TREES REMOVED
4	11	12	2
5	15	13	2
6	11	15	1
7	8	16	2
8	5	20	2
9	1	21	1
11	2	44	1

TOTAL NUMBER OF TREES REMOVED = 65

### SITE DATA

PARCEL AREA	8,536 AC (371,847 SF) *
PARCEL IDENTIFICATION NUMBER	01-28-15-13068-000-0010
ADDRESS	1550 16TH ST, PALM HARBOR, FL 34683
ZONING DESIGNATION	A-E (AGRICULTURAL ESTATE RES. DISTRICT)
FUTURE LAND USE DESIGNATION	I (INSTITUTIONAL)
FEMA FLOOD ZONE DESIGNATION	X **
PROJECT AREA	106,990 SF (2.46 AC)
EXISTING USE	UNDEVELOPED (EAST HALF OF PROPERTY)
PROPOSED USE	RECREATIONAL FIELD
NET ADDITIONAL IMPERVIOUS AREA	0 SF
PROPOSED BUILDING AREA	0 SF
BUILDING SETBACKS REQUIRED	N/A
VEGETATIVE / NATURAL BUFFERS:	
NORTH	60' ***
SOUTH	120' ****
EAST	50' ****
WEST	N/A
EXISTING VEHICULAR PARKING SPACES	125 (108 PAVED + 16 GRASS)
EXISTING ACCESSIBLE PARKING SPACES	8

NOTES:  
 \*\* PER PINELLAS COUNTY SURVEY FILE No. 2097, PID No. 001851B.  
 \*\*\* PER FEMA FIRM No. 12103C0059G DATED SEPTEMBER 3, 2003.  
 \*\*\*\* SELF-IMPOSED.  
 \*\*\*\*\* PER SPECIAL EXCEPTION, BOARD OF ADJUSTMENT CASE No. BA-16-6-15.

1. SOURCE OF CSA PALM HARBOR IMPROVEMENTS SHOWN IS A PINELLAS COUNTY RECORD AS-BUILT DRAWING FOR THE PALM HARBOR SENIOR CENTER DATED FEBRUARY 3, 2000.

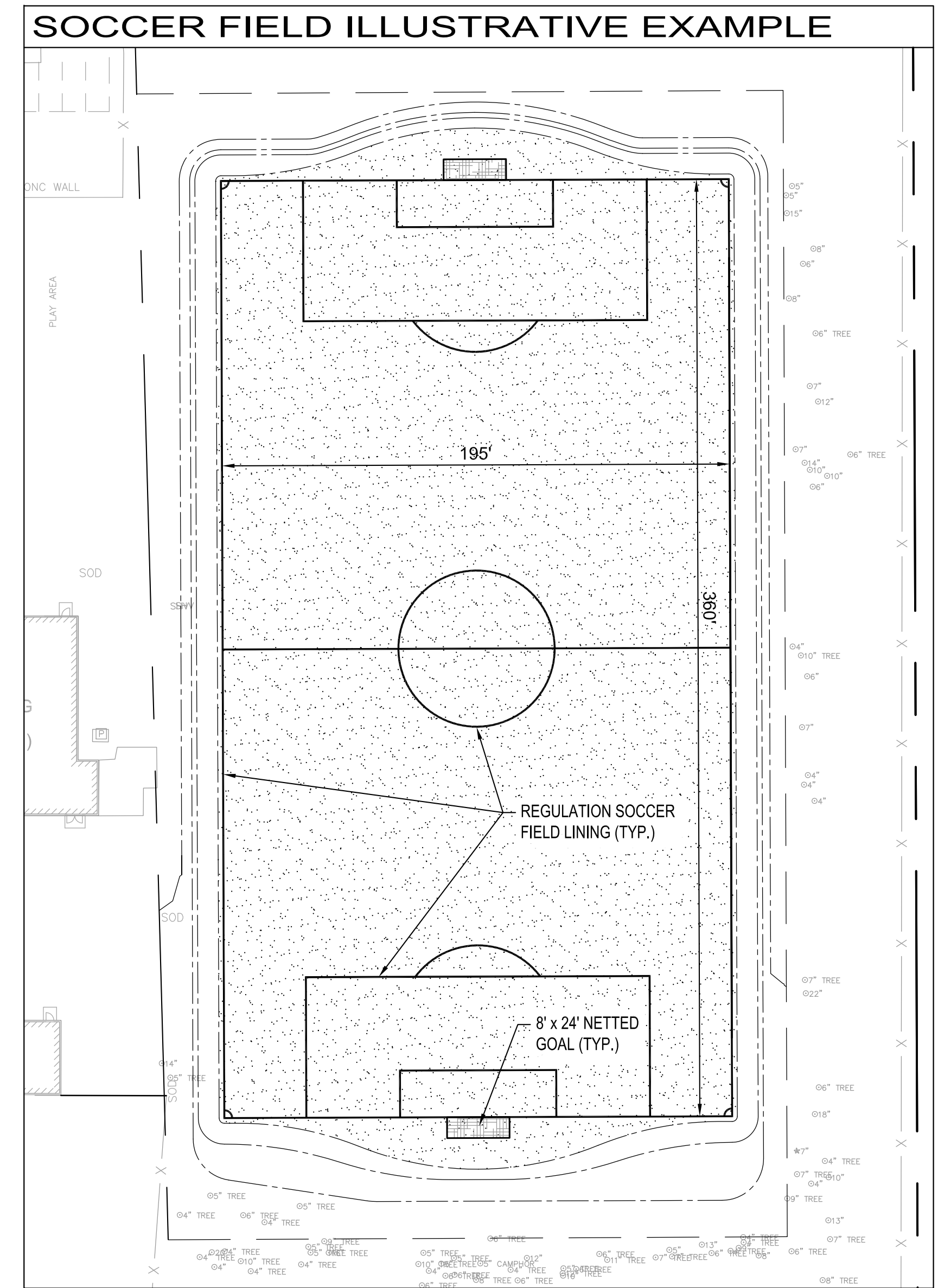

- ### NOTES
- REFER TO TOPOGRAPHIC SURVEY FOR ADDITIONAL INFORMATION AND EXISTING SYMBOL LEGEND.
  - IN GENERAL, ITEMS SHOWN AS BOLD LINEWORK REPRESENT PROPOSED FEATURES TO BE CONSTRUCTED AS PART OF THIS PROJECT, UNLESS NOTED OTHERWISE. SIMILARLY, SHADED LINEWORK TYPICALLY REPRESENTS EXISTING FEATURES OR ITEMS SHOWN FOR INFORMATIONAL PURPOSES ONLY.
  - UNLESS NOTED OTHERWISE, PROPOSED DIMENSIONS ARE SHOWN AT THE CENTERLINE OF ITEMS.
  - CONTRACTOR IS RESPONSIBLE FOR CORRECT HORIZONTAL AND VERTICAL ALIGNMENT OF ALL TIES BETWEEN PROPOSED AND EXISTING IMPROVEMENTS.
  - CONTRACTOR SHALL BE RESPONSIBLE FOR REMOVING ALL CONSTRUCTION AND STOCKPILED VEGETATIVE DEBRIS AND FILL FROM THE SITE IN THE EVENT THE CONSTRUCTION SITE IS ABANDONED PRIOR TO PROJECT COMPLETION.
  - CONTRACTOR SHALL HAVE ONE SIGNED COPY OF THE APPROVED PLANS AND THE APPROPRIATE STANDARDS AND SPECIFICATIONS ALONG WITH A COPY OF ANY PERMITS AND AGREEMENTS NEEDED FOR THE JOB ON-SITE AT ALL TIMES.
  - CONTRACTOR SHALL MEET OR EXCEED ALL SITE WORK SPECIFICATIONS AND APPLICABLE STATE AND FEDERAL REGULATIONS FOR ALL MATERIALS AND CONSTRUCTION.
  - THE CONTRACTOR SHALL BE RESPONSIBLE FOR ALL ASPECTS OF SAFETY DURING CONSTRUCTION.
  - THE CONTRACTOR SHALL NOTIFY THE ENGINEER IF ANY SITUATION THAT IS NOT IDENTIFIED IN THE PLANS OR SPECIFICATIONS IS ENCOUNTERED.
  - NO REVISION SHALL BE MADE TO THESE PLANS WITH OUT THE APPROVAL OF THE ENGINEER OF RECORD.
  - THE CONTRACTOR SHALL BE RESPONSIBLE FOR KEEPING ROADWAYS FREE AND CLEAR OF ALL CONSTRUCTION DEBRIS AND DIRT TRACKED FROM THE SITE.
  - ANY REFERENCE TO PUBLISHED STANDARDS SHALL REFER TO THE LATEST REVISION OF SAID STANDARD, UNLESS SPECIFICALLY STATED OTHERWISE.
  - ALL NECESSARY INSPECTIONS AND/OR CERTIFICATIONS REQUIRED BY CODES AND/OR UTILITY SERVICE COMPANIES SHALL BE PERFORMED PRIOR TO ANNOUNCED BUILDING POSSESSION AND THE FINAL CONNECTION OF SERVICES.

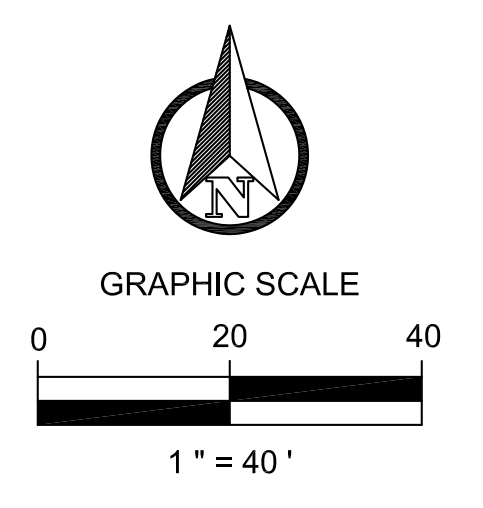

# Bowman

CONSULTING

Bowman Consulting Group, Ltd.  
 One Urban Centre  
 4830 W. Kennedy Blvd.  
 Suite 600  
 Tampa, FL 33609  
 Phone: (813) 909-2403  
 www.bowmanconsulting.com  
 © Bowman Consulting Group, Ltd.  
 Certificate of Authorization License No. 30462

SITE PLAN  
 CSA PALM HARBOR  
 RECREATIONAL FIELD  
 PALM HARBOR, FLORIDA  
 PINELLAS COUNTY

PLAN STATUS		
DATE	DESCRIPTION	
JM	JM	JM
DESIGN	DRAWN	CHKD
SCALE	AS SHOWN	
JOB No.	00000-00-000	
DATE	12/01/2016	
FILE	C1.0-SP.DWG	
SHEET	C-2.0	

THIS DOCUMENT, TOGETHER WITH THE CONCEPTS AND DESIGNS PRESENTED HEREIN, AS AN INSTRUMENT OF SERVICE, IS INTENDED ONLY FOR THE SPECIFIC PURPOSE AND CLIENT FOR WHICH IT WAS PREPARED. REUSE OF AND IMPROPER RELIANCE ON THIS DOCUMENT WITHOUT WRITTEN AUTHORIZATION AND ADAPTATION BY BOWMAN CONSULTING SHALL BE WITHOUT LIABILITY TO BOWMAN CONSULTING.

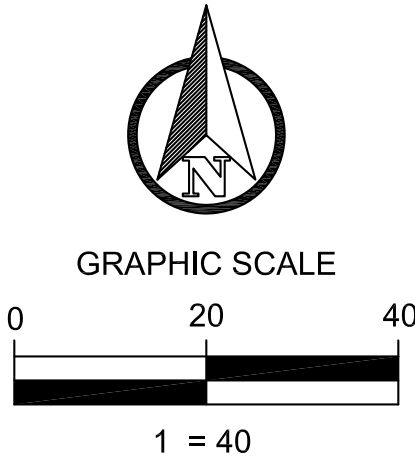
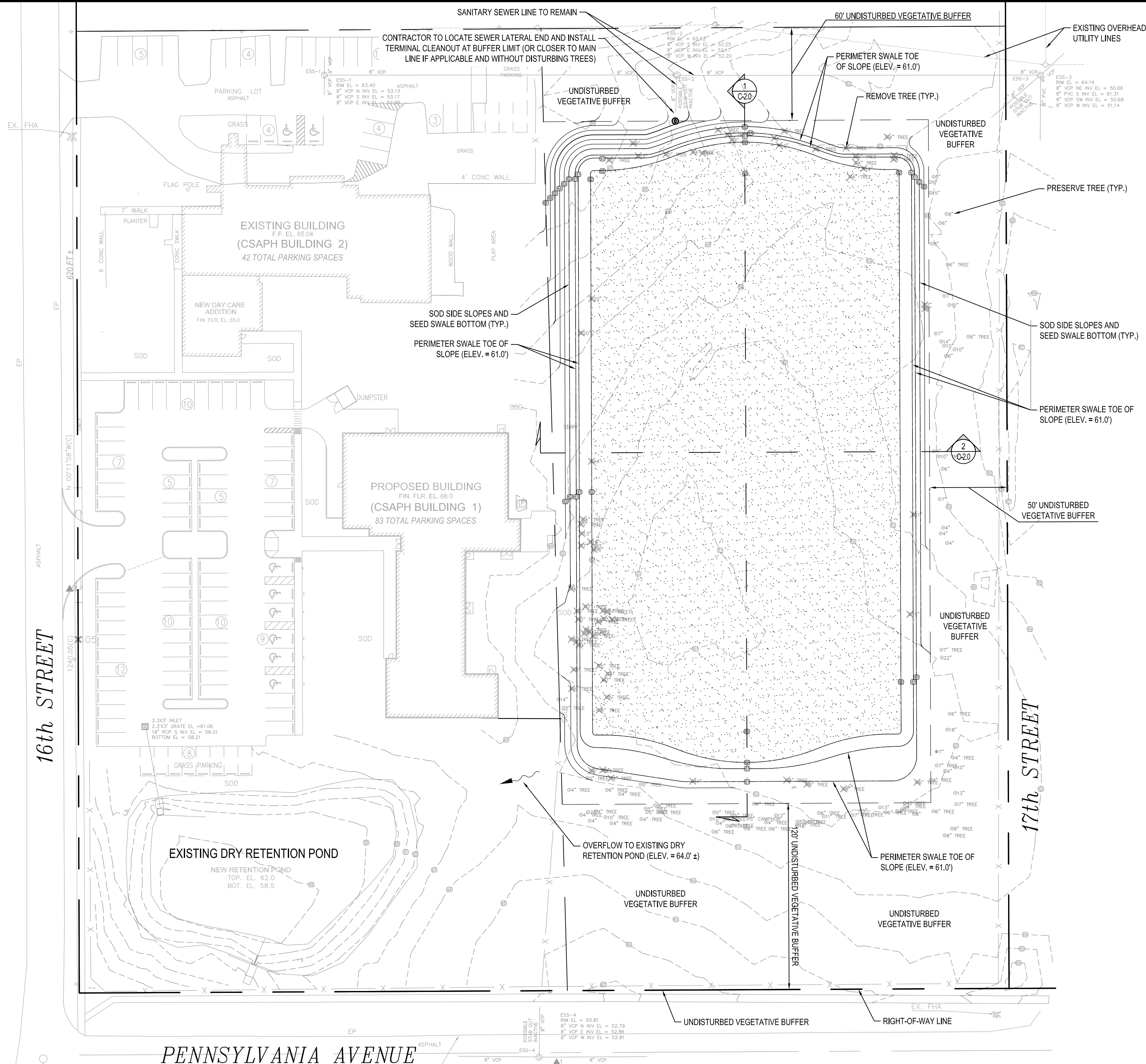

**LEGEND**

- PROPERTY / RIGHT-OF-WAY LINE
- BUFFER LINE
- SPORTS TURF SURFACE
- PROPOSED CONTOUR LINE
- EXISTING CONTOUR LINE
- FENCE
- PRESERVED EXISTING TREE AND DIAMETER BREST HEIGHT
- REMOVED EXISTING TREE AND DIAMETER BREST HEIGHT
- EXISTING SANITARY SEWER MANHOLE
- PROPOSED SANITARY SEWER CLEANOUT
- CROSS SECTION 1, REFER TO SHEET C-X-X

**STORMWATER BEST MANAGEMENT PRACTICE**

NOTE: STAGE-STORAGE CALCULATIONS PRESENTED BELOW ARE BASED ON ELEVATIONS CONTAINED ON THE EAST HALF OF THE SUBJECT TRACT (181,303 SF / 4.162 AC).

**EXISTING STAGE-STORAGE CALCULATION:**

STAGE (FT-ELEV.):	AREA (AC):	VOLUME (AC-FT):
61	0.136	0
62	1.131	0.634
63	2.250	2.324
64	3.096	4.997

**PROPOSED STAGE-STORAGE CALCULATION:**

STAGE (FT-ELEV.):	AREA (AC):	VOLUME (AC-FT):
61	0.113	0
62	0.522	0.318
63	2.878	2.018
64	3.358	5.136

**WATER QUALITY VOLUME:**  
RECOMMENDED: 0.50 INCHES x DEVELOPMENT AREA (2,456 AC) = 0.10 AC-FT

- NOTES**
- GENERAL CONTRACTOR SHALL NOTIFY ALL UTILITY COMPANIES HAVING UNDERGROUND UTILITIES ON SITE OR IN RIGHT-OF-WAY AND SHALL LOCATE ALL UTILITIES PRIOR TO EARTHWORK COMMENCEMENT.
  - TREE BARRICADE AT DRIP LINE OF TREE SHALL REMAIN UNTIL CONSTRUCTION ACTIVITY IN VICINITY REQUIRES REMOVAL.
  - SITE WORK SHALL NOT PROCEED UNTIL APPROPRIATE EROSION AND SEDIMENT CONTROL MEASURES HAVE BEEN INSTALLED.
  - CLEANOUTS SHALL HAVE 2' x 2' x 6" THICK CONCRETE APRON.
  - ALL UTILITY MATERIALS SHALL COMPLY WITH THE UTILITY AUTHORITY'S STANDARDS AND SPECIFICATIONS.
  - ALL TRENCHING, PIPE LAYING, AND BACKFILLING SHALL BE IN ACCORDANCE WITH FEDERAL OSHA REGULATIONS.
  - ALL AREAS DISTURBED WITHIN THE PUBLIC RIGHT-OF-WAY MUST BE SODDED.
  - GENERAL CONTRACTOR SHALL SOD AT THE BACK OF ALL CURBS, PAVEMENT EDGES, AND SIDE SLOPES. SWALE AND DETENTION AREA BOTTOMS SHALL BE SEED TO MAINTAIN SOIL INFILTRATION.
  - 3000 PSI CONCRETE SHALL BE USED FOR SIDEWALKS, ROADWAY AND DRAINAGE STRUCTURES (FDOT STANDARD SPECIFICATIONS SECTION 346).
  - THE CONTRACTOR SHALL LEGALLY DISPOSE OF ALL ITEMS DESIGNATED FOR REMOVAL IN STRICT ACCORDANCE WITH ALL APPLICABLE LOCAL, STATE, AND FEDERAL LAWS. SUCH MATERIAL, WHETHER HAZARDOUS OR NON-HAZARDOUS, LAND-CLEARING, CONSTRUCTION OR DEMOLITION DEBRIS SHALL BE PROPERLY HANDLED AND TRANSPORTED TO AN APPROPRIATE OFF-SITE FACILITY.

**1 CROSS SECTION:**

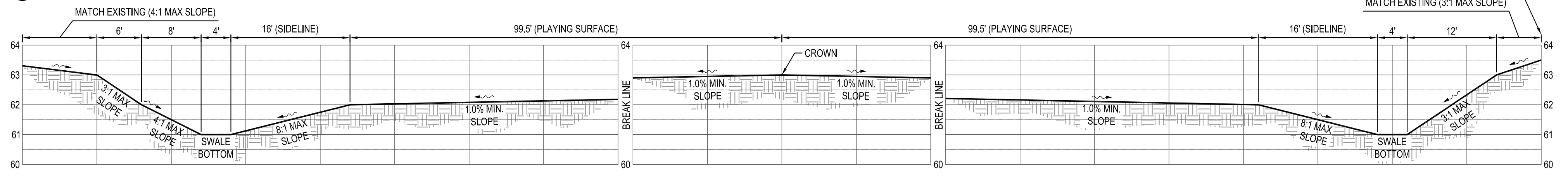

**2 CROSS SECTION:**

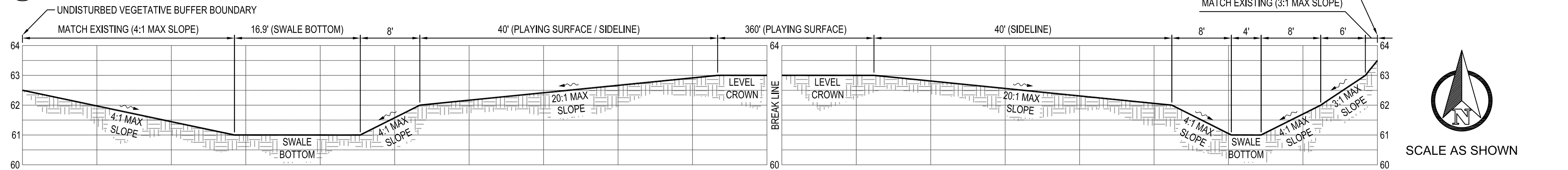

**Bowman**  
CONSULTING  
Certificate of Authorization License No. 30462

Bowman Consulting Group, Ltd.  
One Urban Centre  
4830 W. Kennedy Blvd.  
Suite 600  
Tampa, FL 33609  
Phone: (813) 909-2403  
www.bowmanconsulting.com  
© Bowman Consulting Group, Ltd.

**GRADING AND DRAINAGE PLAN**  
CSA PALM HARBOR  
RECREATIONAL FIELD  
PALM HARBOR, FLORIDA  
PINELLAS COUNTY

PLAN STATUS		
DATE	DESCRIPTION	
JM	JM	JM
DESIGN	DRAWN	CHKD
SCALE	AS SHOWN	
JOB No.	00000-00-000	
DATE	12/01/2016	
FILE	C2.0-GDP.DWG	
SHEET	<b>C-3.0</b>	



TOPOGRAPHIC SURVEY OF:  
 PHCSA CSA RECREATION FIELDS  
 AT NW CORNER OF 16TH STREET  
 AND PENNSYLVANIA AVENUE

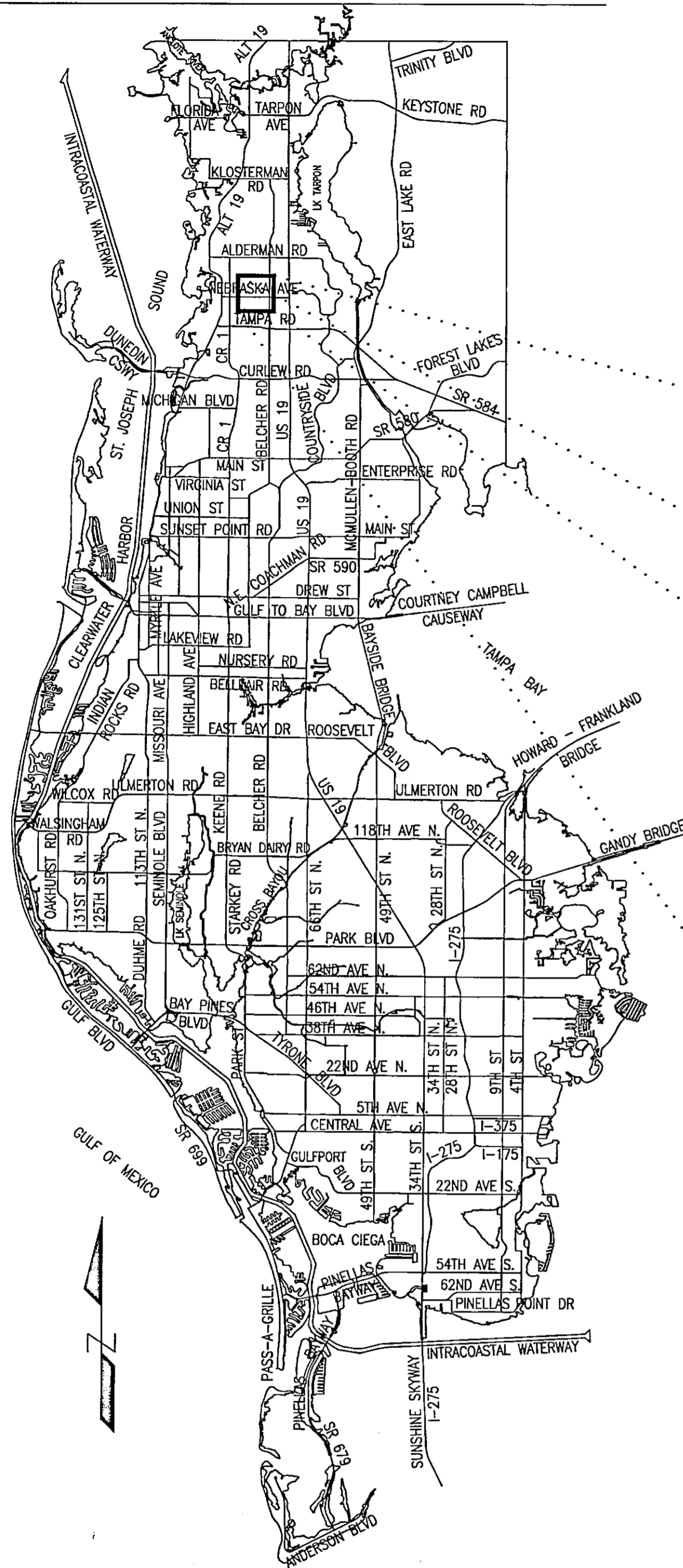

THE SURVEY DEPICTED HERE IS NOT COVERED BY PROFESSIONAL LIABILITY INSURANCE.  
 VICINITY MAP

NOT TO SCALE

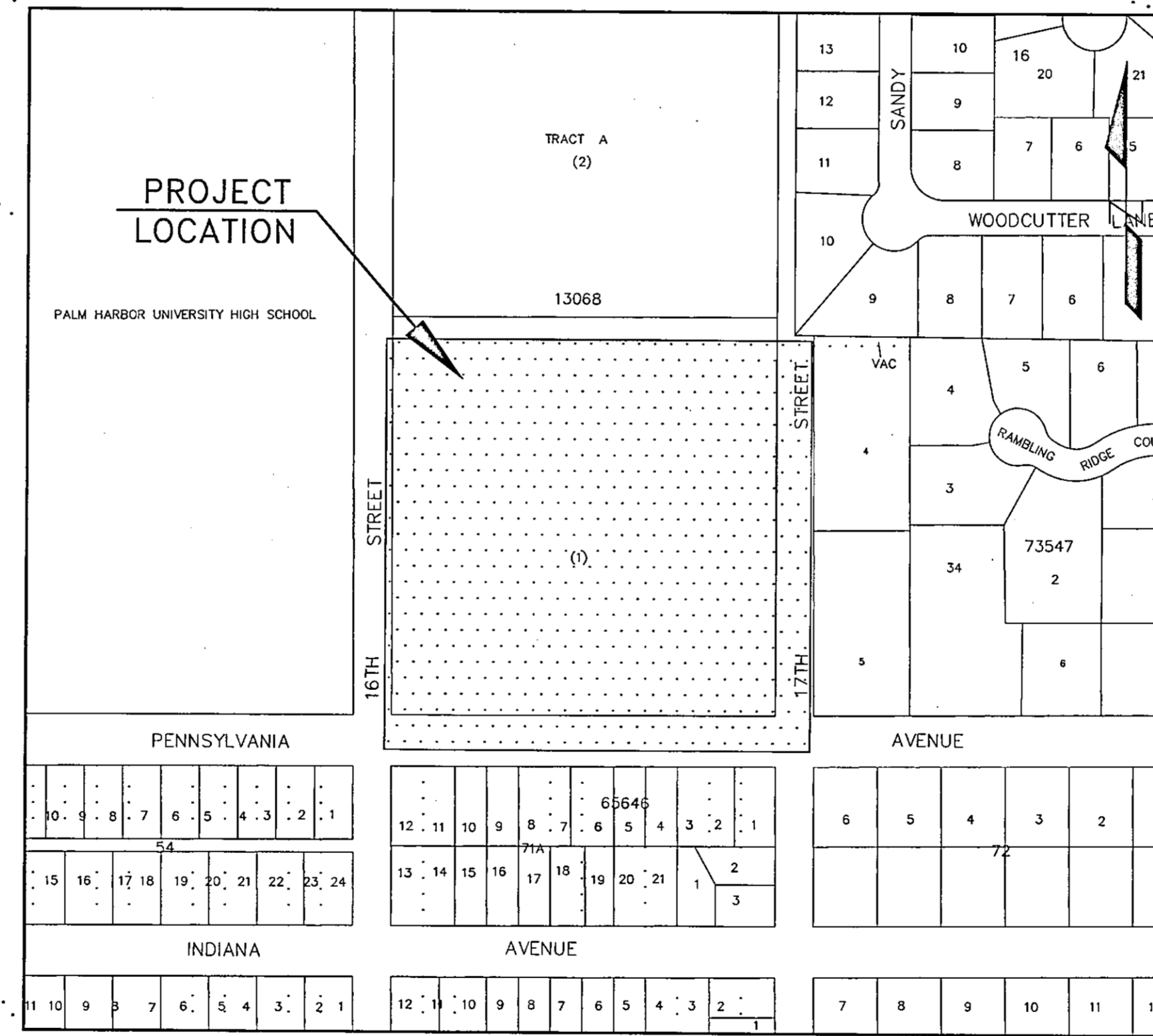

SHEET INDEX

- 1 COVER SHEET / VICINITY MAP / GRAPHIC SYMBOLS
- 2 LAND SURVEYOR REPORT / ALIGNMENT / MONUMENTATION / ABBREVIATIONS
- 3-4 TOPOGRAPHIC SURVEY

GRAPHIC SYMBOLS:

CENTERLINE	SANITARY SEWER GRAVITY LINE	BACKFLOW PREVENTER	GUY WIRE	SHRUB
CONTOUR LINE	FORCE MAIN (SANITARY SEWER)	BENCHMARK	HOSE BIB	SIGN
EXISTING TOPOGRAPHIC FEATURE	GAS LINE	CENTERLINE	LIGHT POLE	SPRINKLER HEAD
SURFACE WATER/WETLAND BOUNDARY	HOT OIL LINE	COMMUNICATIONS BOX	MAILBOX	SPRINKLER HEAD VALVE
SURVEY REFERENCE LINE	RECLAIMED WATER LINE	COMMUNICATIONS MANHOLE	MONITOR WELL	SURVEY LINE
RIGHT-OF-WAY (EXISTING)	POTABLE WATER	DECIDUOUS TREE (OAK UNLESS OTHERWISE ANNOTATED)	PALM TREE	TARGET
RIGHT-OF-WAY LINE (PROPOSED)	UNKNOWN UTILITY	DELTA ANGLE	PEDESTRIAN SIGNAL	TRAFFIC SIGNAL POLE
(EXISTING W/ ACQUISITION)	FOUND CONCRETE MONUMENT	DRAINAGE CLEAN OUT	POLE/POST	TRAFFIC SIGNAL PULL BOX
PROPERTY OR DEED LINE	FOUND NAIL & DISC/CAP BRASS DISC	DRAINAGE MANHOLE	POWER BOX	UNDERDRAIN BOX
EASEMENT LINE	FOUND IRON ROD	ELECTRICAL EQUIPMENT	PROPERTY LINE	UTILITY POLE
EASEMENT LINE (PROPOSED)	FOUND IRON PIPE	ELECTRICAL OUTLET	RECLAIMED WATER MANHOLE	WATER METER
(EXISTING W/ ACQUISITION)	FOUND PINCH PIPE	EVERGREEN TREE	RECLAIMED WATER METER	WATER VALVE
SECTION LINE	SET CONCRETE MONUMENT	FIRE HYDRANT	RECLAIMED WATER VALVE	
ORIGINAL LOT LINE/FORMER OWNERSHIP LINE/ VACATED EASEMENTS	SET NAIL & DISC/CAP BRASS DISC	GAS METER	SANITARY SEWER CLEANOUT	
TREE LINE	SET IRON ROD	GAS VALVE	SEWER MANHOLE	
FENCE LINE	X CUT (FOUND)	GATE VALVE		
COMMUNICATION LINE	X CUT (SET)	GRATE INLET		
TRAFFIC CONTROL LINE	SUB PARCEL NO.			
ELECTRIC POWER LINE/CABLE	BLOCK NUMBER			
DRAINAGE (STORM SEWER) PIPE	PROPERTY APPRAISER PARCEL NUMBER			
EXISTING TOP OF BANK AND TOE OF SLOPE	PROPOSED PARCEL			

SECTION 01, TOWNSHIP 28 SOUTH, RANGE 15 EAST

*Susan C. V. Scholpp*  
 SUSAN C. V. SCHOLPP, P.S.M.  
 Florida Registered Professional Surveyor and Mapper  
 Certificate No. 6034  
 Pinellas County  
 Public Works Department  
 Survey and Mapping Division  
 22211 U.S. Hwy. 19 North  
 Clearwater, Florida 33765  
 Phone: (727)464-8904

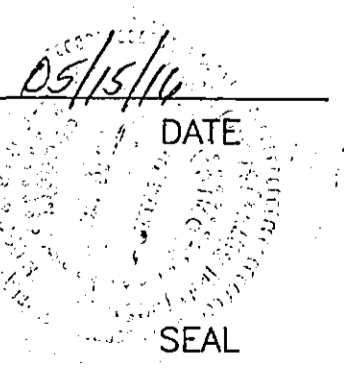

SURVEY REVISION DATE	SURVEY FILE NO.: 2097
	PID NO.: 001851B
	SHEET 1 OF 4

LAND SURVEYOR REPORT:

- 1. Type of Survey: Topographic Survey (Chapter 5J-17.052 (10)(k) F.A.C.) to establish the geographic location of existing features to facilitate the PHCSA (Palm Harbor Community Services Agency) CSA RECREATION FIELDS AT NW CORNER OF 16TH STREET AND PENNSYLVANIA AVENUE (SFN 2097).

ALIGNMENT:

Alignment: SRL1

Description: N-S CENTERLINE SECTION 1-28-16

Table with columns: Description, Point #, PT Station, Northing, Easting. Includes start and end coordinates and length.

MONUMENTATION/ CONTROL POINT COORDINATES:

Table with columns: Point, Northing, Easting, Elevation, Station, Offset, Description. Lists control points and their coordinates.

ABBREVIATIONS:

Large table listing various survey abbreviations and their meanings, such as 'CALCULATED DATA', 'DRIVEWAY, GRASS', 'LEFT MITERED END SECTION', etc.

S:\Divisions\Survey\SFN Projects\2097\2097-CSD-2015.dwg, May 16, 2016 - 10:32am

Bottom section containing 'REVISIONS' table, project details for 'PINELLAS COUNTY, FLORIDA', 'PHCSA CSA RECREATION FIELDS', and a professional seal for Susan C. V. Scholpp, P.S.M.

SECTION 01, TOWNSHIP 28 SOUTH, RANGE 15 EAST

SEE SHEET 4 OF 4

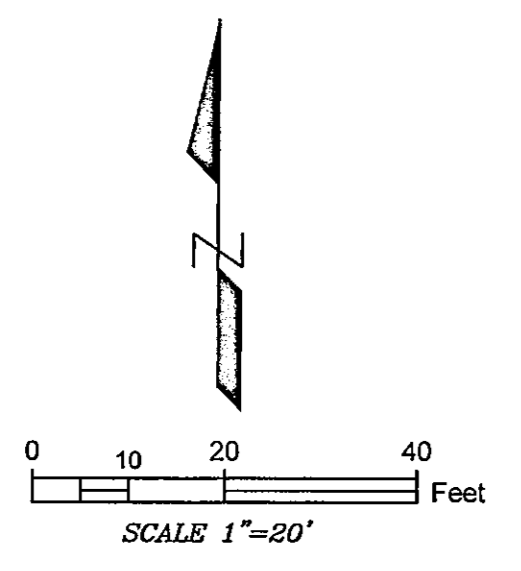

16TH STREET

17TH STREET

CAMPBELL'S PALM HARBOR GROVE REPLAT PINELLAS COUNTY, FLA PB 21 PAGE 75

2.3'X3' INLET  
2.3'X3' GRATE EL = 61.06  
18" RCP S INV EL = 58.01  
BOTTOM EL = 58.21

18" RCP MES EL = 57.95

TOP OF 1.5' TALL SKIMMER EL = 61.28

A SURVEYOR'S REPORT HAS BEEN UTILIZED ON THIS SURVEY AS A TEXT OPTION TO THE MAP. USERS OF THIS SURVEY AND MAP ARE DIRECTED TO ACKNOWLEDGE THE CONTENT OF REPORT ITEMS AS INDICATED ON SHEET 2.

ESS-4  
RIM EL = 65.81  
8" VCP N INV EL = 52.79  
8" VCP E INV EL = 52.86  
8" VCP W INV EL = 52.81

PENNSYLVANIA AVENUE

CENTERLINE PENNSYLVANIA AVENUE

S:\Divisions\Survey\SFN Projects\sfm2097\Drawings\F2097-C3D-2015.dwg, May 16, 2016 - 10:32am

REVISIONS	BY	DATE	SURVEY BOOK No.: 3131
			SURVEY SECTION BY DATE
			SURVEYED B.F. 5/16
			TECHNICIAN J.F. 5/16
			CHECKED G.D. 5/16
			DESIGN SECTION
			DESIGNED
			DRAWN
			CHECKED

PHCSA CSA  
RECREATION FIELDS  
AT NW CORNER OF 16TH ST  
AND PENNSYLVANIA AVE

TOPOGRAPHIC SURVEY

PINELLAS COUNTY, FLORIDA  
PUBLIC WORKS DEPARTMENT  
SURVEY AND MAPPING DIVISION  
22211 U.S. HWY. 19 NORTH  
CLEARWATER, FLORIDA 33765-2347  
PHONE (727) 464-8904

SOSAN C. V. SCHOLPP, P.S.M.S.  
Professional Surveyor and Mapper  
Certificate No. 6034  
DATE

SURVEY FILE NO.: 2097  
PID.: 001851B  
F2097-C3D-2015.dwg  
SHEET: 3 of 4



# SECTION 01, TOWNSHIP 28 SOUTH, RANGE 15 EAST

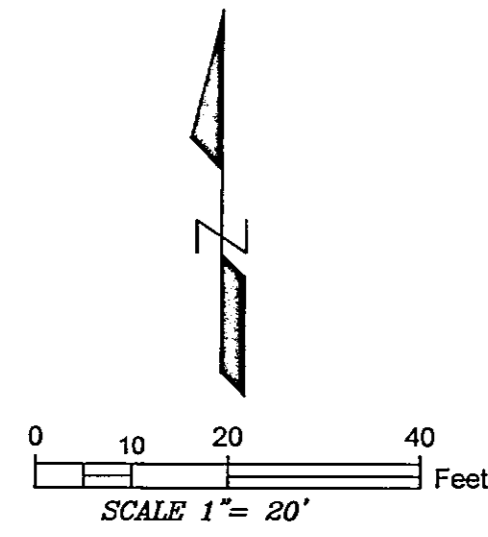

ESS-1  
RIM EL = 63.40  
8" VCP N INV EL = 53.13  
8" VCP S INV EL = 53.17  
8" VCP E INV EL = 52.95

ESS-2  
RIM EL = 65.82  
8" VCP S INV EL = 52.25  
8" VCP E INV EL = 52.17  
8" VCP W INV EL = 52.20

ESS-3  
RIM EL = 64.14  
8" VCP NE INV EL = 50.66  
8" VCP S INV EL = 61.31  
8" VCP SW INV EL = 50.68  
8" VCP W INV EL = 51.14

CAMPBELL'S PALM HARBOR GROVE REPLAT PINELLAS COUNTY, FLA PB 21 PAGE 75

A SURVEYOR'S REPORT HAS BEEN UTILIZED ON THIS SURVEY AS A TEXT OPTION TO THE MAP. USERS OF THIS SURVEY AND MAP ARE DIRECTED TO ACKNOWLEDGE THE CONTENT OF REPORT ITEMS AS INDICATED ON SHEET 2.

CONC SLAB FOR A/C CHILLER W/ 6' CHAINLINK FENCE

NO TREES LOCATED IN THIS AREA

SEE SHEET 3 OF 4

S:\Divisions\Survey\STN Projects\stn2097\DWG\F2097-C3D-2015.dwg, May 16, 2016 - 10:32am

REVISIONS	BY	DATE	SURVEY BOOK No.: 3131
			SURVEY SECTION BY DATE
			SURVEYED B.E. 5/16
			TECHNICIAN J.F. 5/16
			CHECKED G.D. 5/16
			DESIGN SECTION
			DESIGNED . . .
			DRAWN . . .
			CHECKED . . .

**PHCSA CSA  
RECREATION FIELDS  
AT NW CORNER OF 16TH ST  
AND PENNSYLVANIA AVE**

**TOPOGRAPHIC SURVEY**

**PINELLAS COUNTY, FLORIDA  
PUBLIC WORKS DEPARTMENT**

SURVEY AND MAPPING DIVISION  
22211 U.S. HWY. 19 NORTH  
CLEARWATER, FLORIDA 33765-2347  
PHONE (727) 464-8904

SUSAN C. V. SCHOPP, P.E.  
 Professional Surveyor and Mapper  
 Certificate No. 8034  
 DATE

SURVEY FILE NO.: 2097  
PID: 001851B  
f2097-C3D-2015.dwg  
SHEET: 4 of 4