



**FORWARD  
PINELLAS**  
Integrating Land Use & Transportation

# Countywide Planning Authority Regular Countywide Plan Map Amendment

Case CW17-2

City of Pinellas Park

May 9, 2017

# General Location

- LOCATION: 11425 66<sup>th</sup> Street
- ACRES: 1.9 m.o.l.
- EXISTING USES:  
mattress outlet in front  
and a marble/granite  
fabricator in back

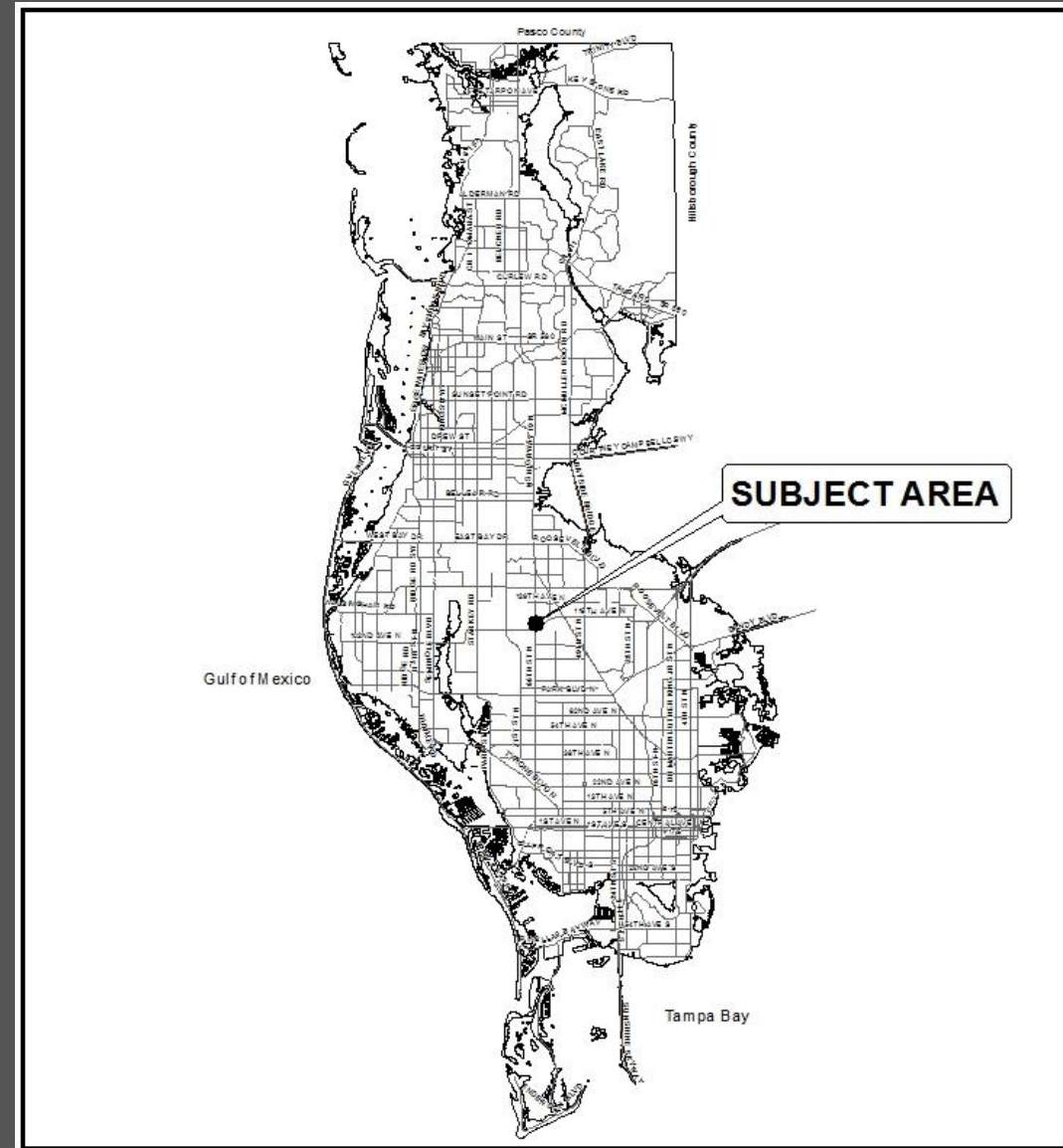

# Jurisdiction

- Amendment area is located in the City of Pinellas Park, and is adjacent to unincorporated Pinellas County

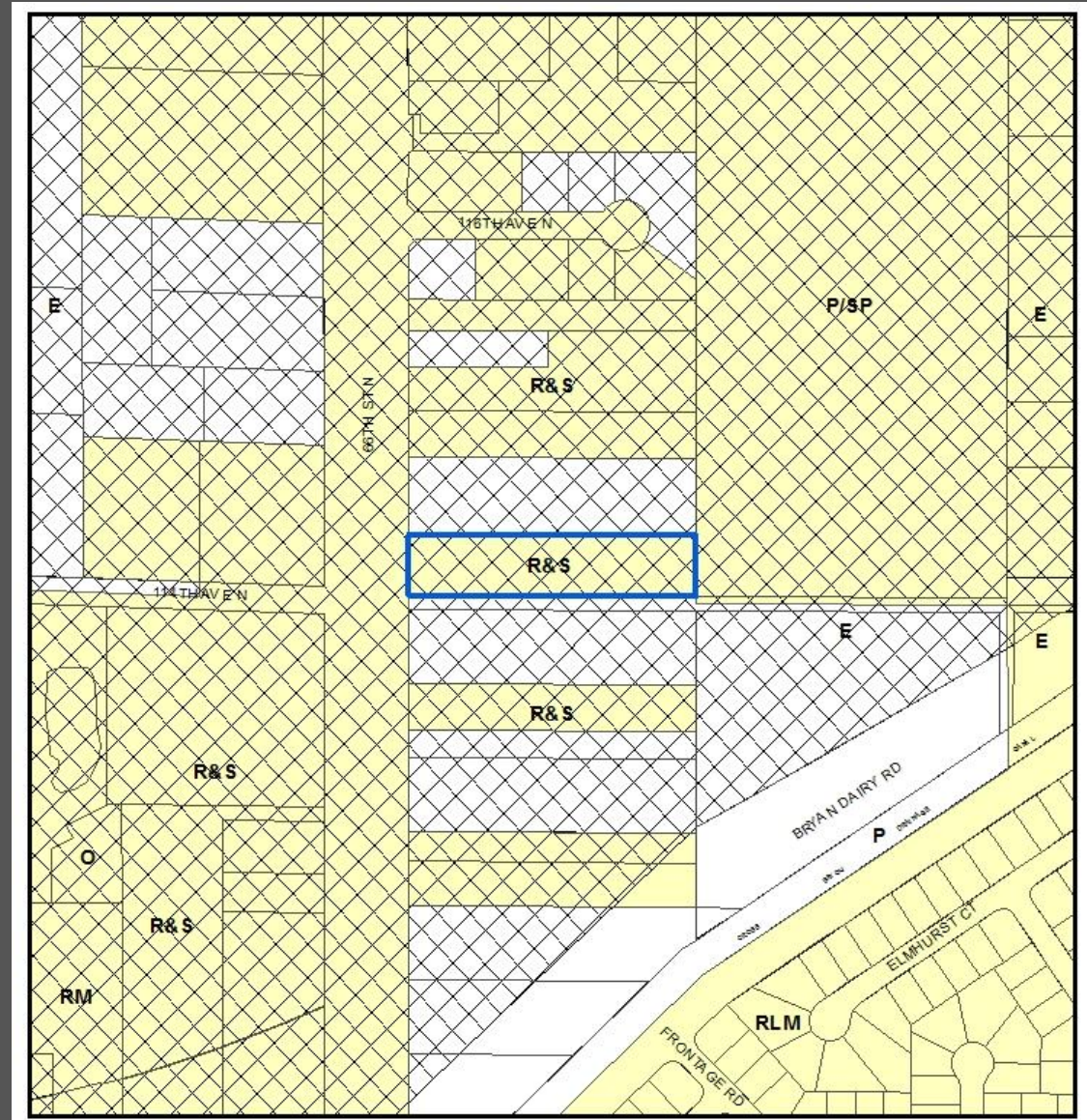

# Area Characteristics

- Surrounding uses are a mix of retail & services, employment and institutional

Collision center



Middle school

Industrial workshop units



# Looking west



# Building on property



# Looking south



# Current Categories

- Currently categorized as Retail & Services (R&S) and Target Employment Center

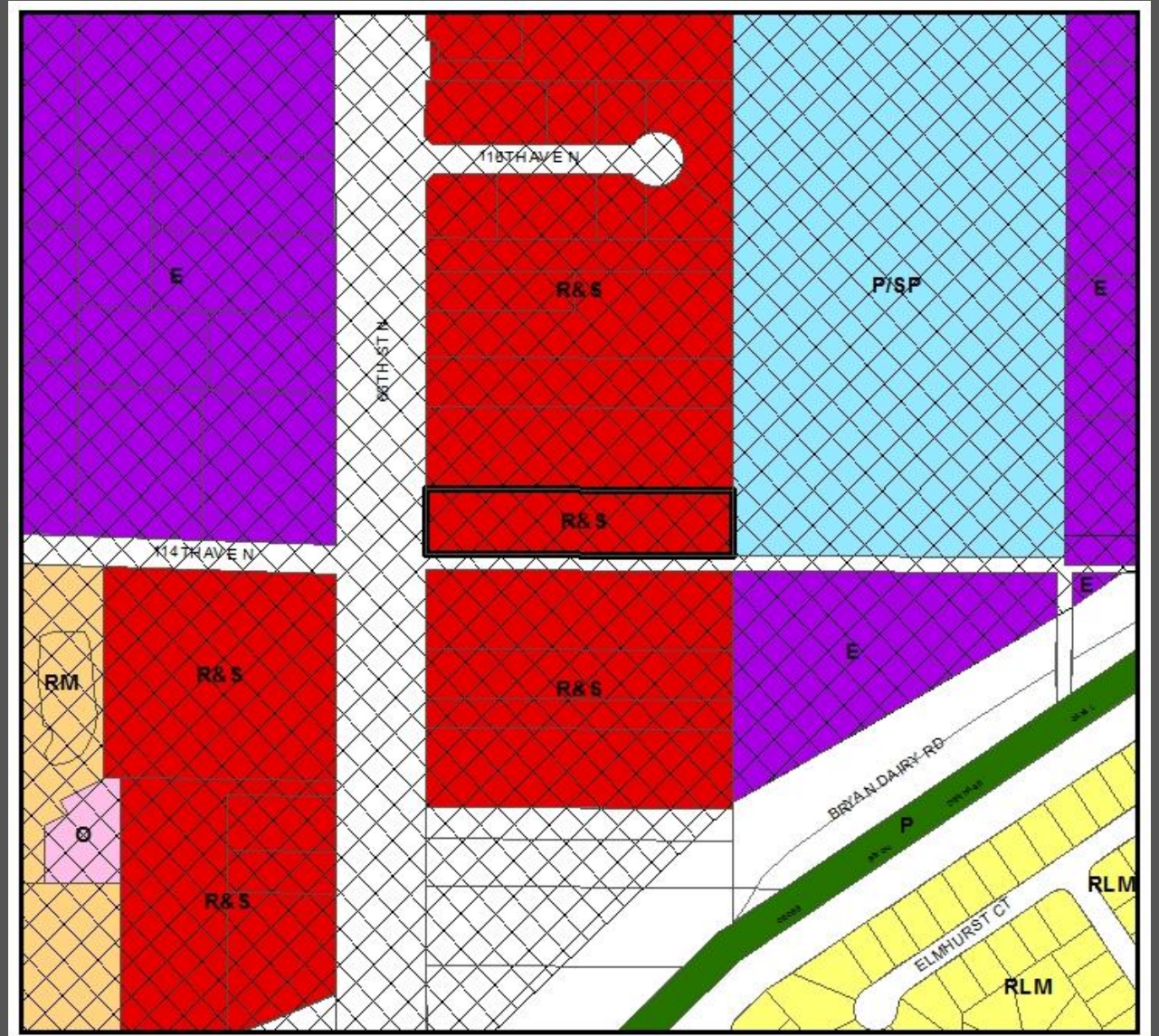



# Proposed Categories

- This amendment seeks to change the category from Retail and Services (R&S) and Target Employment Center to Employment and Target Employment Center
- Granite fabrication and manufacturing is proposed for the site

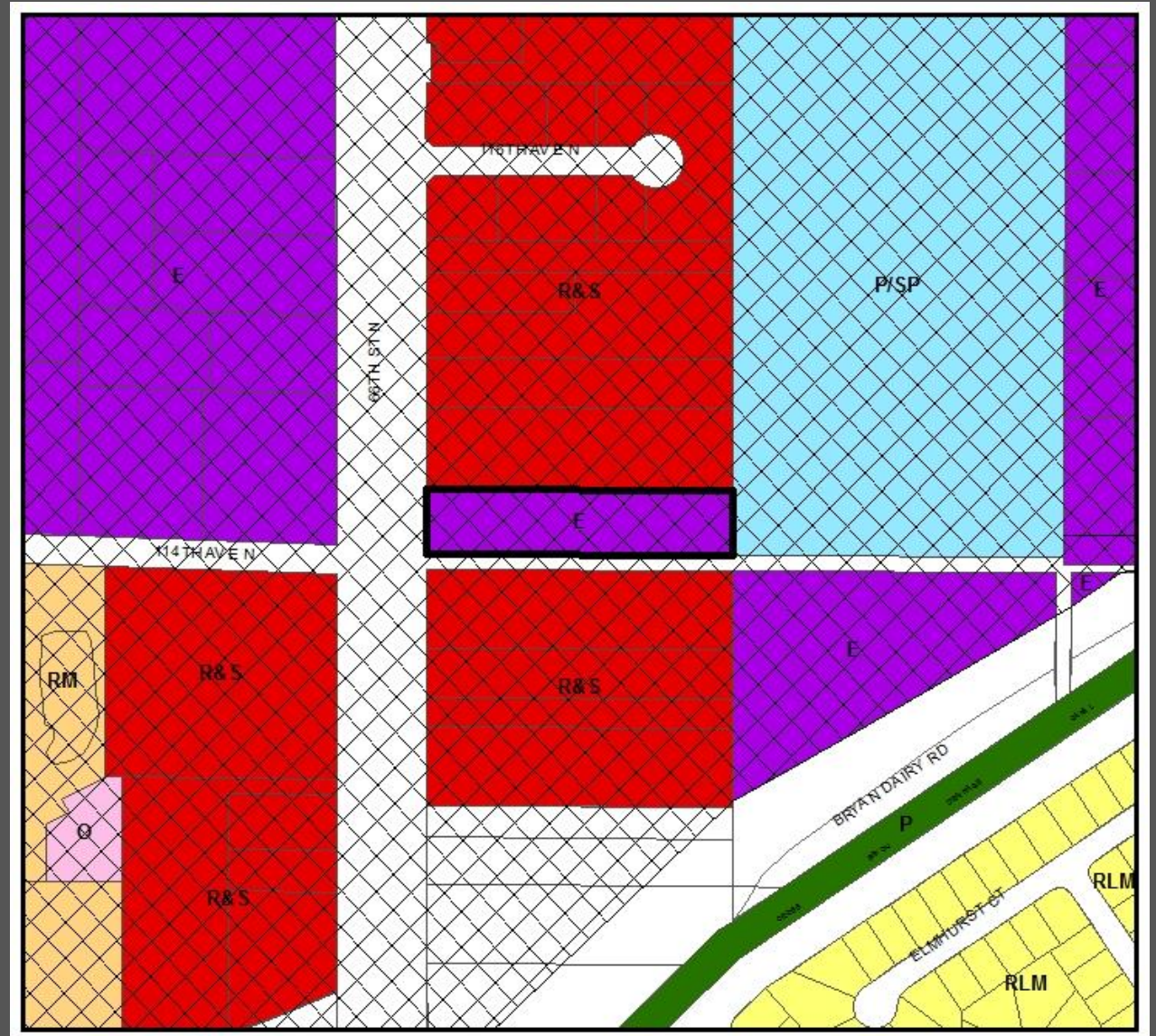

# Findings and Recommendation

- Consistent with the Countywide Rules, and reviewed against the Countywide Considerations:
  - Consistent with the utilization of this category; and
  - Will not significantly impact other Countywide Considerations.
- Staff recommends approval

