



# City of Oldsmar

*To provide leadership, innovation, environmental stewardship and excellent services in partnership with the community*

100 State Street West ~ Oldsmar, FL 34677-3655 ~ (813) 749-1100 ~ Fax (813) 891-9152

August 22, 2018

Mr. Mark Woodard  
Pinellas County Administrator  
315 Court Street  
Clearwater, FL 33756

RE: Address: Vacant Phoenix Avenue  
Parcel #: 22/28/16/96660/009/0170

Dear Mr. Woodard:

Pursuant to the provisions of Section 171.044 Florida Statutes, enclosed you will find a certified copy of the ordinance the City of Oldsmar adopted to annex certain real property into the corporate limits of the city.

If you have any questions regarding the enclosure, I can be reached at (813) 749-1115 or [anixon@myoldsmar.com](mailto:anixon@myoldsmar.com).

Sincerely,

Ann E. Nixon, MMC  
City Clerk  
City of Oldsmar, FL

BOARD OF COUNTY  
COMMISSIONERS  
PINELLAS COUNTY FLORIDA

2018 AUG 30 AM 9:01

RECEIVED  
BOARD OF

Enclosure: Ordinance, 2018-06, Oldsmar, Florida 34677

CERTIFICATION  
I HEREBY CERTIFY THAT THIS IS  
A TRUE AND CORRECT COPY OF:

*Ordinance 2018-06*  
OF THE PUBLIC RECORDS OF OLDSMAR

ORDINANCE 2018-06

*[Signature]*  
CITY CLERK

**AN ORDINANCE DECLARING THE INTENTION OF THE CITY OF OLDSMAR, FLORIDA TO ANNEX CERTAIN REAL PROPERTY LOCATED IN SECTION 22, TOWNSHIP 28 SOUTH, RANGE 16 EAST, FURTHER DESCRIBED AS LOT 17, BLOCK 9, MAP OF SECTION NO. 1 WEST OLDSMAR (PARCEL NUMBER 22-28-16-96660-009-0170) INTO THE CORPORATE LIMITS OF THE CITY OF OLDSMAR AND PROVIDING FOR THE EFFECTIVE DATE OF THIS ORDINANCE.**

WHEREAS, pursuant to the provisions of the Florida Statutes, the City of Oldsmar may lawfully annex land lying contiguous to the boundaries of the City upon written petition of the property owners thereof; and

WHEREAS, the City of Oldsmar has received a written petition of the property owners of the following described property and has received proper proof of title setting forth the names of all persons, firms or corporations owning any interest in said property; and

WHEREAS, said property is reasonably compact and is contiguous to the City of Oldsmar, lying in an unincorporated area.

NOW, THEREFORE, BE IT ORDAINED BY THE CITY COUNCIL OF THE CITY OF OLDSMAR, FLORIDA, IN SESSION DULY AND REGULARLY ASSEMBLED:

Section 1: The City of Oldsmar, acting by and through its City Council hereby declares its intention to annex into the corporate limits of the City Oldsmar the following property lying contiguous to the territorial limits of said City:

**SEE ATTACHED EXHIBIT "A"**

**A map clearly showing the annexed area is attached hereto as EXHIBIT "B" and incorporated herein by reference.**

Section 2: Upon final passage and adoption a certified copy of this Ordinance shall be duly recorded in the Office of the Circuit Court of Pinellas County and filed with the Department of State, State of Florida and the County Administrator of Pinellas County, Florida.

Section 3: When this Ordinance has been duly recorded and filed as aforesaid, the territory hereinabove described shall be thereupon annexed to the

City of Oldsmar and the inhabitants thereof shall enjoy all the privileges and be subject to all liabilities as are applicable to the other lands and inhabitants within the corporate limits and subject to all laws and ordinances of the City of Oldsmar.

Section 4: This Ordinance shall become effective immediately upon its final passage and adoption.

PASSED ON FIRST READING: August 7, 2018

PASSED ON SECOND READING AND ADOPTED: August 21, 2018

  
\_\_\_\_\_  
**Doug Bevis, Mayor**  
**City of Oldsmar**

ATTEST:

  
\_\_\_\_\_  
**Ann Nixon, City Clerk, MMC**  
**City of Oldsmar**

APPROVED AS TO FORM:

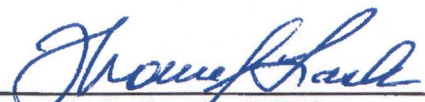
  
\_\_\_\_\_  
**Thomas J. Trask, B.C.S.**  
**City Attorney, City of Oldsmar**

**ORDINANCE 2018-06**

**Exhibit "A"**

Lot 17, Block 9, Map of Section No. 1 West Oldsmar, according to the map or plat thereof as recorded in Plat Book 9, Page 79, of the Public Records of Pinellas County, Florida.



**FRANCISCO RODRIGUEZ AND YURISEL MARTINEZ**  
**22/28/16/96660/009/0170**  
**VACANT PHOENIX AVE**  
**OLDSMAR, FL 34677**

**LEGAL DESCRIPTION**

A PARCEL OF LAND LYING IN BLOCK 9, MAP OF SECTION NO.1 WEST OLDSMAR, ACCORDING TO THE MAP OF PLAT THEREOF, AS RECORDED IN PLAT BOOK 9, PAGE(S) 79, OF THE PUBLIC RECORDS OF PINELLAS COUNTY, FLORIDA, BEING MORE PARTICULARLY DESCRIBED AS FOLLOWS:

COMMENCE AT THE SOUTHWEST CORNER OF SAID BLOCK 9, THENCE RUN S45°30'35"E FOR A DISTANCE OF 188.08 FEET TO THE POINT OF BEGINNING. THENCE N43°45'06"E FOR A DISTANCE OF 249.49 FEET, THENCE S46°53'49"E FOR A DISTANCE OF 69.74 FEET, THENCE S42°18'15"W FOR A DISTANCE OF 249.21 FEET, THENCE N47°06'44"W FOR A DISTANCE OF 76.04 FEET TO THE POINT OF BEGINNING.

CONTAINING 0.42 ACRES MORE OR LESS.

**EXHIBIT "B"**

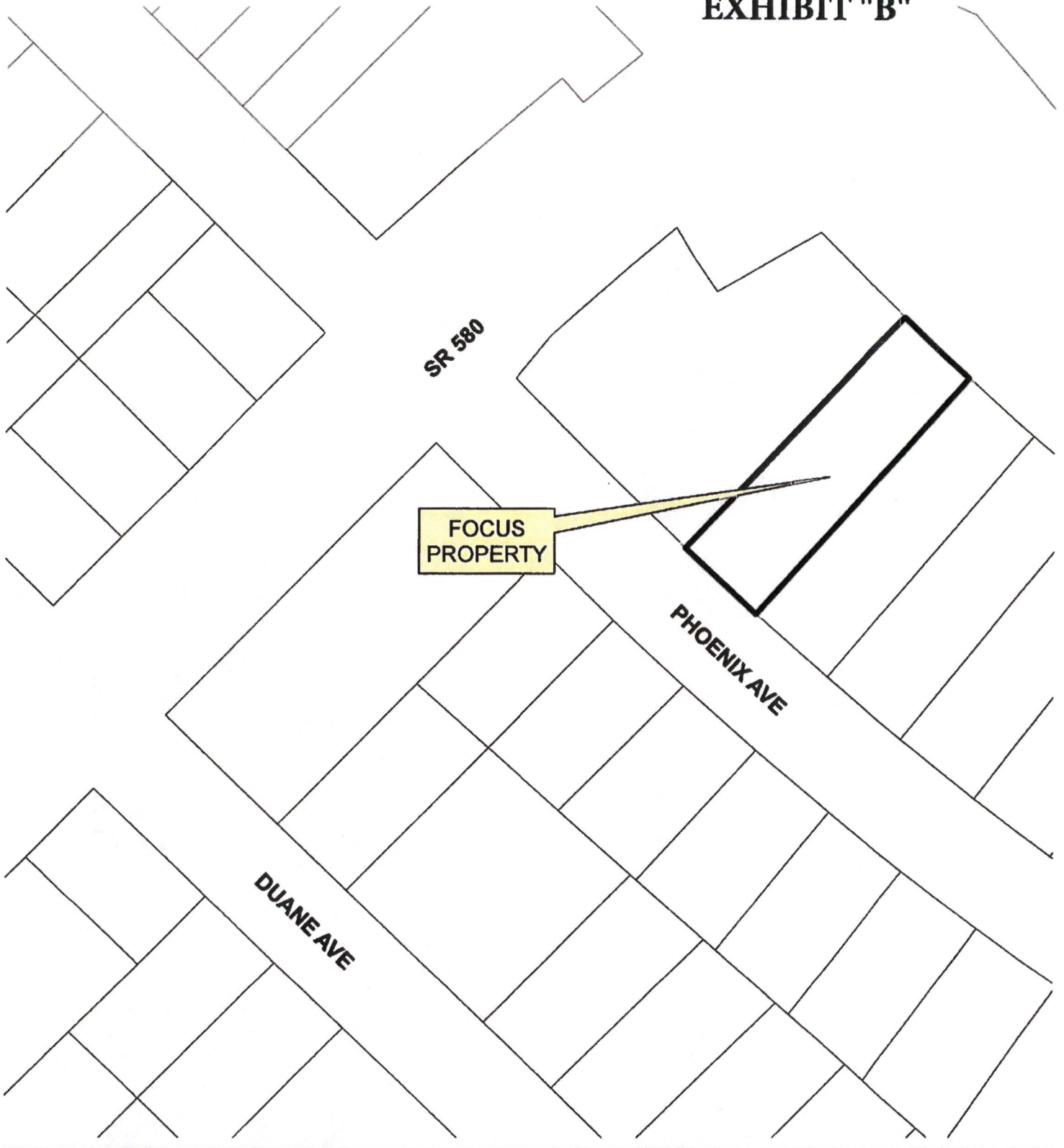

**LOCATOR MAP**

22-28-16-96660-009-0170

VACANT PHOENIX AVE

OLDSMAR, FL 34677

BLOCK 9, LOT 17, WEST OLDSMAR SECTION NO. 1



MAY 2018