

DA-23-09-18

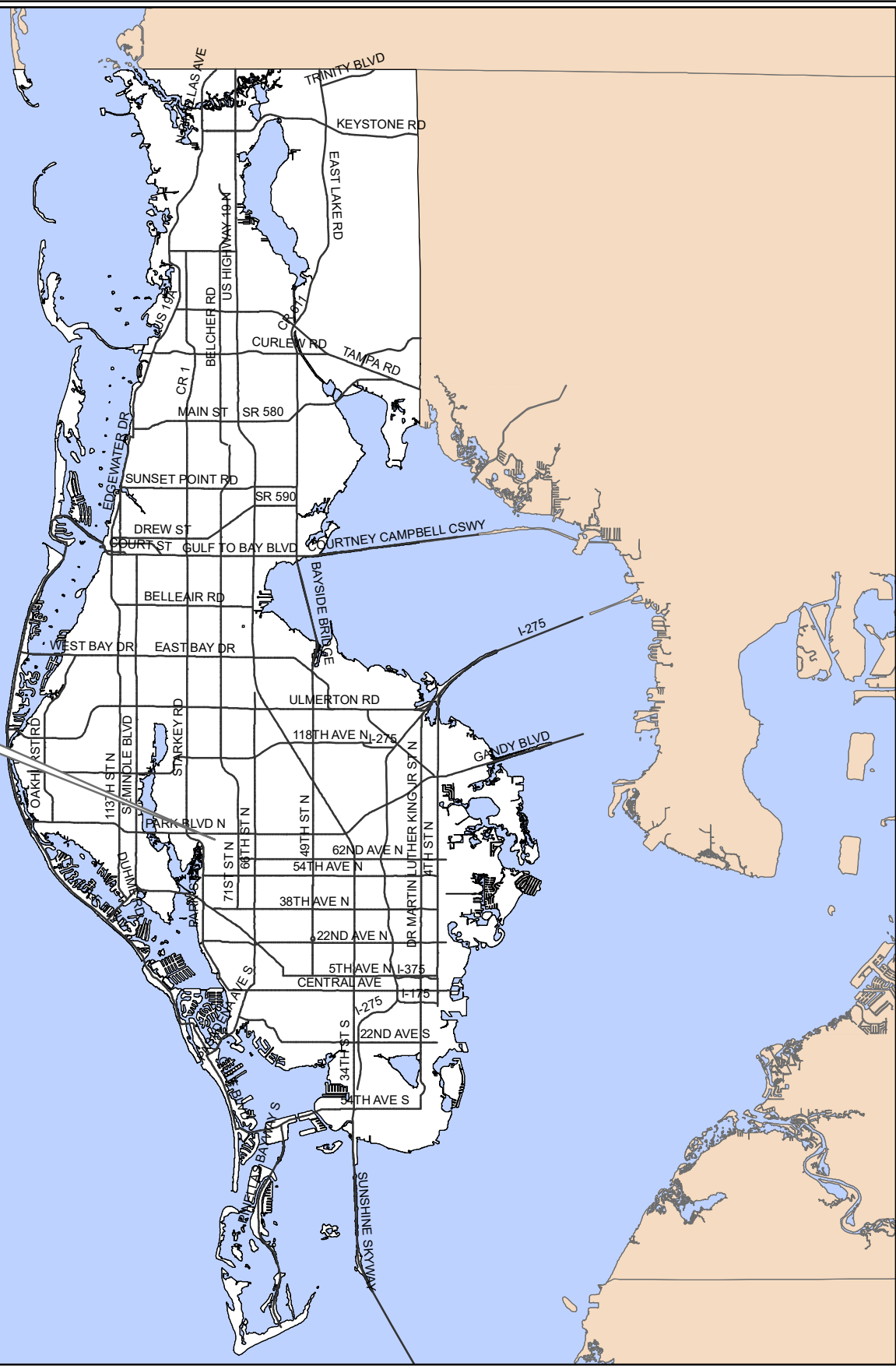

Surrounding Counties

DA-23-09-18
Location Map

Termination of previously approved Development Agreement.



25/30/15/00000/440/0400

Prepared by: Pinellas County Planning Department



Date: 8/1/2018

1 inch = 4.5 miles

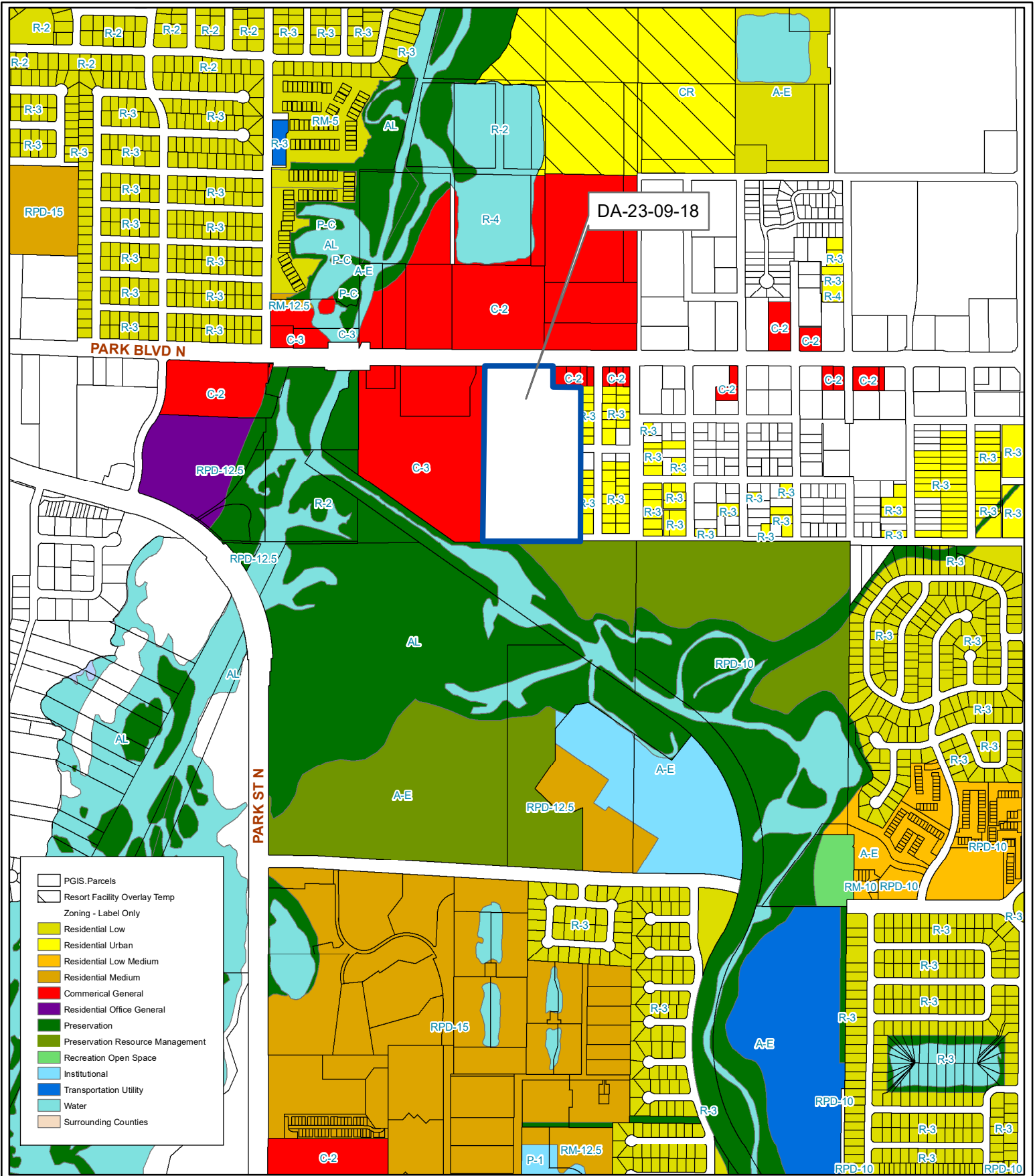

- PGIS Parcels
- Resort Facility Overlay Temp
- Zoning - Label Only
- Residential Low
- Residential Urban
- Residential Low Medium
- Residential Medium
- Commercial General
- Residential Office General
- Preservation
- Preservation Resource Management
- Recreation Open Space
- Institutional
- Transportation Utility
- Water
- Surrounding Counties

DA-23-09-18
Current Land Use & Zoning

Termination of previously approved Development Agreement.



25/30/15/00000/440/0400

Prepared by: Pinellas County Planning Department



Date: 8/1/2018

1 inch = 0.18 miles



DA-23-09-18

PARK BLVD N

PARK ST N

DA-23-09-18

Aerial Map

Termination of previously approved Development Agreement.

25/30/15/00000/440/0400

Prepared by: Pinellas County Planning Department



Date: 8/1/2018



1 inch = 0.18 miles

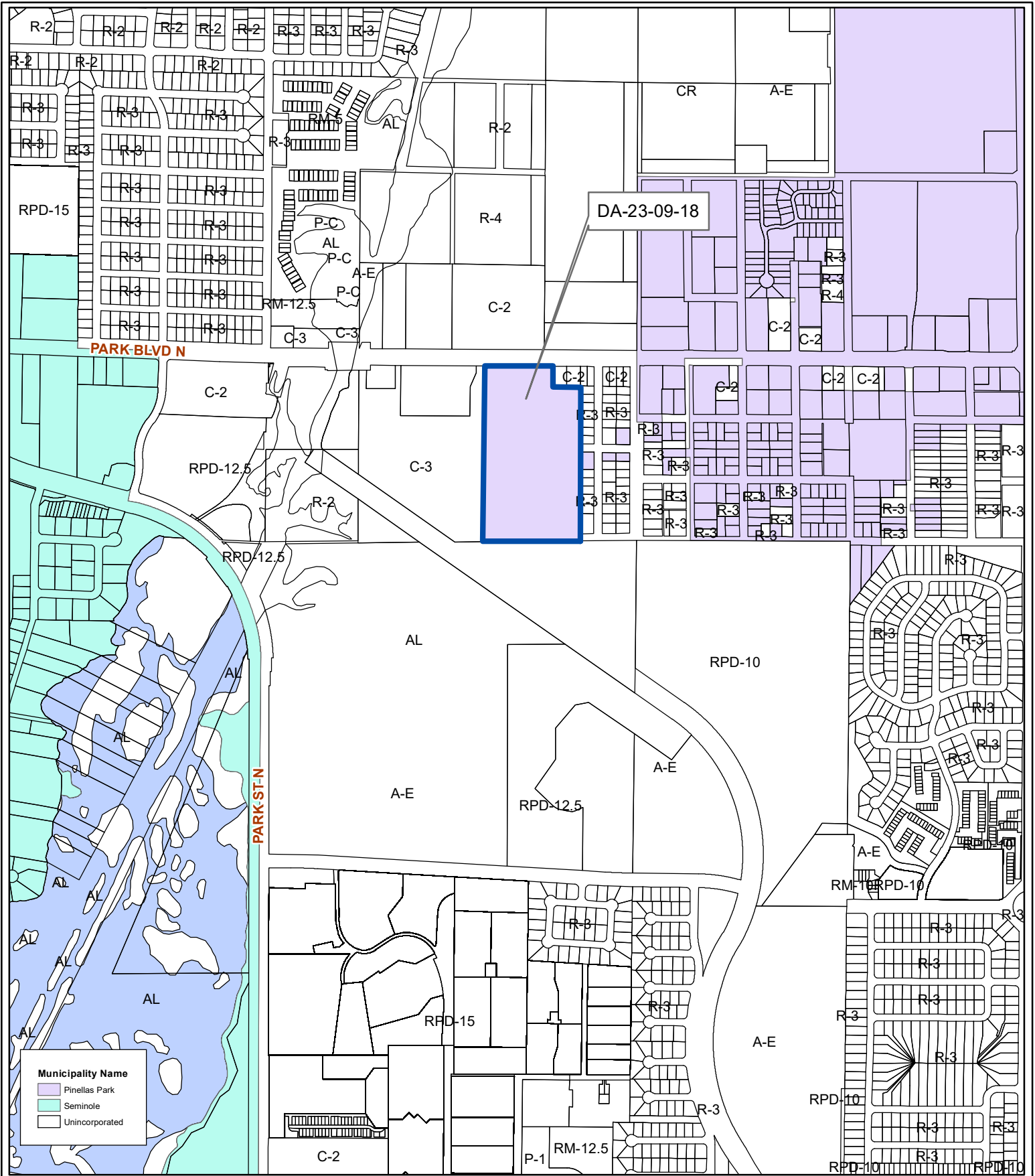

DA-23-09-18
Municipal Map

Termination of previously approved Development Agreement.

25/30/15/00000/440/0400

Prepared by: Pinellas County Planning Department



Date: 8/1/2018



1 inch = 0.18 miles