

LEGEND	
EXISTING ϕ TRACK	--- ---
EXISTING RAIL	====
SAWCUT	- - - -
NEW 136# RAIL	=====
NEW TRANSITION RAIL	---+---
BUFFER RAIL	-----
NEW WELDS	⌒
NEW TUB CROSSING PANELS	▨

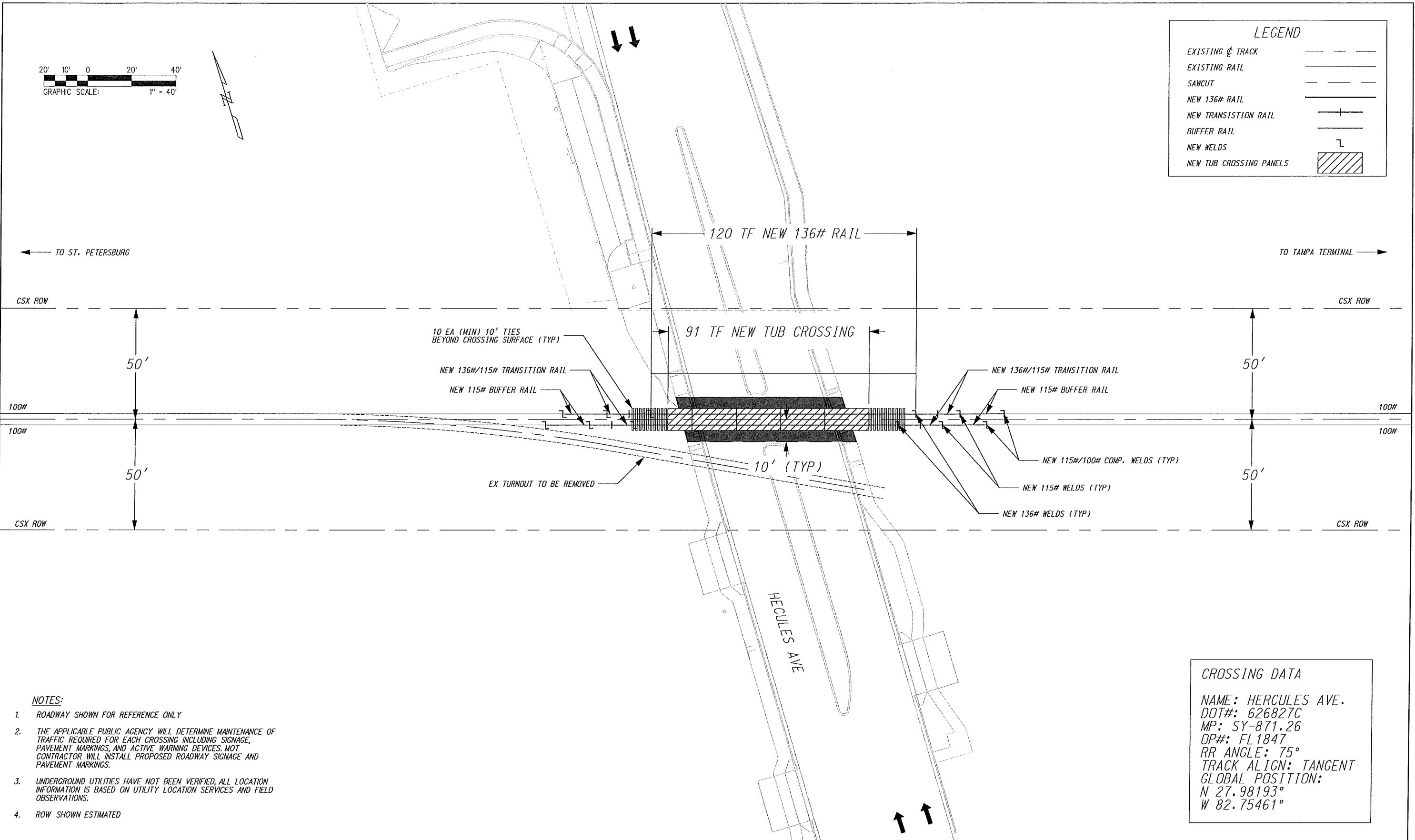

NOTES:

- ROADWAY SHOWN FOR REFERENCE ONLY
- THE APPLICABLE PUBLIC AGENCY WILL DETERMINE MAINTENANCE OF TRAFFIC REQUIRED FOR EACH CROSSING INCLUDING SIGNAGE, PAVEMENT MARKINGS, AND ACTIVE WARNING DEVICES. NOT CONTRACTOR WILL INSTALL PROPOSED ROADWAY SIGNAGE AND PAVEMENT MARKINGS.
- UNDERGROUND UTILITIES HAVE NOT BEEN VERIFIED, ALL LOCATION INFORMATION IS BASED ON UTILITY LOCATION SERVICES AND FIELD OBSERVATIONS.
- ROW SHOWN ESTIMATED

CROSSING DATA	
NAME:	HERCULES AVE.
DOT#:	626827C
MP:	SY-871.26
OP#:	FL1847
RR ANGLE:	75°
TRACK ALIGN:	TANGENT
GLOBAL POSITION:	N 27.98193° W 82.75461°

I:\Projects\2515676\1007\40_Project Management\408_Estimates\2515676-1041 Hercules Ave\STV_Exhibit\DWG_Clearwater_Ave\STV_Exhibit_Xing_Exhibit.dgn 12:50:05 PM 9/8/2016

REV	DATE	DESCRIPTION	BY	APP

DESIGNED BY	JEO
DRAWN BY	JEO
CHECKED BY	PJB
APPROVED BY	
DATE	09/02/16



ENGINEERING DEPARTMENT
JACKSONVILLE, FLORIDA

VAL. SEC	V12 FLA
	L-1
	7
V03753	

HERCULES AVE TUB CROSSING CLEARWATER, PINELLAS COUNTY, FL	
DIVISION: JACKSONVILLE	SUBDIVISION: CLEARWATER

CONTRACT NO.	
DRAWING NO.	626827C
REVISION	0
SHEET NO.	1 OF 1
SCALE	AS SHOWN

R.R. NORTH TO TN

H.S. 1192+87

1541 FT.

87 FT.

87 FT.

1541 FT.



CSX R.O.W.

CSX R.O.W.

HAND DIGGING WILL BE REQUIRED IN SE QUAD DUE TO CLOSE PROXIMITY OF U.G UTILITIES. VAC TRUCK REQUIRED

SW

50' 0"

ML (RUSTY RAIL)

NON-SIGNALLED

NE

GATE AND CANTILEVER COMBO UNIT IN NW QUAD PLACED 13' FROM COT DUE TO 30" CONCRETE PIPE

80' 0"

NW

51' 0"

50' 0"

CSX R.O.W.

APPROACH LENGTHS TABLE	NORTHWARD ML MOT	SOUTHWARD ML MOT
DC, AFO, TYPE C, MOTION, CWT, OR OTHER		
STANDARD MINIMUM WARNING TIME IN SECONDS	25	25
ROADWAY GATE TIME IN SECONDS	5	5
CLEARANCE TIME IN SECONDS	1	1
DOT TRAFFIC LIGHT SIMULTANEOUS PREEMPT TIME IN SECONDS*	0	0
DESIGNED WARNING TIME FOR TRAINS AT TIME TABLE SPEED	31 SEC.	31 SEC.
DOT TRAFFIC LIGHT ADVANCE PREEMPT TIME IN SECONDS *	0	0
CONTROL EQUIPMENT DECISION TIME IN SECONDS	5	5
DESIGNED DETECTION TIME FOR TRAINS AT TIME TABLE SPEED	36 SEC.	36 SEC.
TIME TABLE MAXIMUM TRAIN SPEED IN MILES PER HOUR	25	25
BUFFER SPEED IN MILES PER HOUR	5	5
TOTAL WARNING SYSTEM DESIGN SPEED IN MILES PER HOUR	30	30
APPROACH DISTANCE TO ISLAND EDGE IN FEET	1541	1541
HALF WIDTH OF ISLAND IN FEET	87	87
APPROXIMATE MILE POSTS FOR APPROACH CIRCUIT	870.95	871.57

*AUTHORIZING AGENCY, NONE
 *DATE OF REQUIREMENT, NONE
 *AMOUNT OF TIME (SEC.), NONE

CSX R.O.W.

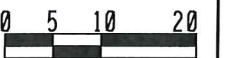

PRODUCED FOR: RAIL TRANSPORT GROUP ENGINEERING COMMUNICATIONS AND SIGNALS	PRODUCED BY: A Wabtec Company	LEGEND CSX ROW ———— R/R POLELINE ———— GAS ———— FIBER OPTIC ————	GUARD RAIL ———— O.H. POWER ———— FENCE ———— WATER ———— SEWER ————	METER SERVICE ⊗ POLE ⊙ FIRE PLUG ⊕ SEWER CAP ⊖ GAS VENT ⊕	GPS COORDINATES 27°58'93" N 82°45'28" W ELEV. 990'	REVISION DATES 06-30-2016 - - - -	FILE NAME: SY87126.H01 DATE DRAWN: 12-07-2015 DRAWN BY: XRL CHECKED BY: XRL XRL #: CXS1540628	STREET NAME: HERCULES AVE. CITY & STATE: CLEARWATER, FL M.P. SY-871.26 DOT: 626827C PROJECT #: FL2014077A OP #: A43621	PROPOSED CROSSING LAYOUT SCALE = 20:1
---	----------------------------------	--	--	---	--	---	---	--	---