



City of Oldsmar

To provide leadership, innovation, environmental stewardship and excellent services in partnership with the community

100 State Street West ~ Oldsmar, FL 34677-3655 ~ (813) 749-1100 ~ Fax (813) 891-9152

May 17, 2017

Mr. Mark Woodard
Pinellas County Administrator
315 Court Street
Clearwater, FL 33756

Dear Mr. Woodard:

Pursuant to the provisions of Section 171.044 Florida Statutes, enclosed you will find a certified copy of the ordinance the City of Oldsmar passed to annex certain real property into the corporate limits of the city.

If you have any questions regarding the enclosure, I can be reached at (813) 749-1115 or anixon@myoldsmar.com.

Sincerely,

Ann E. Nixon, MMC
City Clerk
City of Oldsmar, FL

RECEIVED
BOARD OF

2017 MAY 25 AM 9:21

Enclosure: Ordinance, 2017-06 Oldsmar, Florida 34677

CERTIFICATION
I HEREBY CERTIFY THAT THIS IS
A TRUE AND CORRECT COPY OF:

Ord. 2017-06
OF THE PUBLIC RECORDS OF OLDSMAR

ORDINANCE 2017-06

Ann Nixon
CITY CLERK

AN ORDINANCE DECLARING THE INTENTION OF THE CITY OF OLDSMAR, FLORIDA TO ANNEX CERTAIN REAL PROPERTY LOCATED IN SECTION 22, TOWNSHIP 28 SOUTH, RANGE 16 EAST, FURTHER DESCRIBED AS LOT 7, BLOCK 7, MAP OF SECTION NO. 1 WEST OLDSMAR (PARCEL NUMBER 22-28-16-96660-007-0070) INTO THE CORPORATE LIMITS OF THE CITY OF OLDSMAR AND PROVIDING FOR THE EFFECTIVE DATE OF THIS ORDINANCE.

WHEREAS, pursuant to the provisions of the Florida Statutes, the City of Oldsmar may lawfully annex land lying contiguous to the boundaries of the City upon written petition of the property owners thereof; and

WHEREAS, the City of Oldsmar has received a written petition of the property owners of the following described property and has received proper proof of title setting forth the names of all persons, firms or corporations owning any interest in said property; and

WHEREAS, said property is reasonably compact and is contiguous to the City of Oldsmar, lying in an unincorporated area.

NOW, THEREFORE, BE IT ORDAINED BY THE CITY COUNCIL OF THE CITY OF OLDSMAR, FLORIDA, IN SESSION DULY AND REGULARLY ASSEMBLED:

Section 1: The City of Oldsmar, acting by and through its City Council hereby declares its intention to annex into the corporate limits of the City Oldsmar the following property lying contiguous to the territorial limits of said City:

SEE ATTACHED EXHIBIT "A"

A map clearly showing the annexed area is attached hereto as EXHIBIT "B" and incorporated herein by reference.

Section 2: Upon final passage and adoption a certified copy of this Ordinance shall be duly recorded in the Office of the Circuit Court of Pinellas County and filed with the Department of State, State of Florida and the County Administrator of Pinellas County, Florida.

Section 3: When this Ordinance has been duly recorded and filed as aforesaid, the territory hereinabove described shall be thereupon annexed to the City of Oldsmar and the inhabitants thereof shall enjoy all the privileges and be

subject to all liabilities as are applicable to the other lands and inhabitants within the corporate limits and subject to all laws and ordinances of the City of Oldsmar.

Section 4: This Ordinance shall become effective immediately upon its final passage and adoption.

PASSED ON FIRST READING: May 2, 2017

PASSED ON SECOND READING AND ADOPTED: May 16, 2017

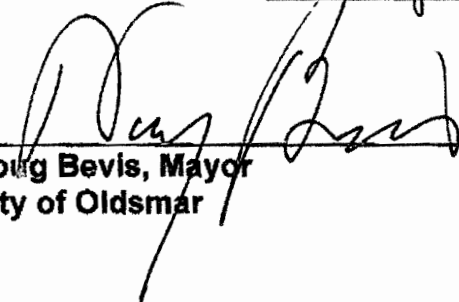

Doug Bevis, Mayor
City of Oldsmar

ATTEST:



Ann Nixon, City Clerk, MMC
City of Oldsmar

APPROVED AS TO FORM:



Thomas J. Trask, B.C.S.
City Attorney, City of Oldsmar

ORDINANCE 2017-06

Exhibit "A"

Lot 7, Block 7, Map of Section No. 1 West Oldsmar, according to the plat thereof as recorded in Plat Book 9, Page 79, of the Public Records of Pinellas County, Florida.

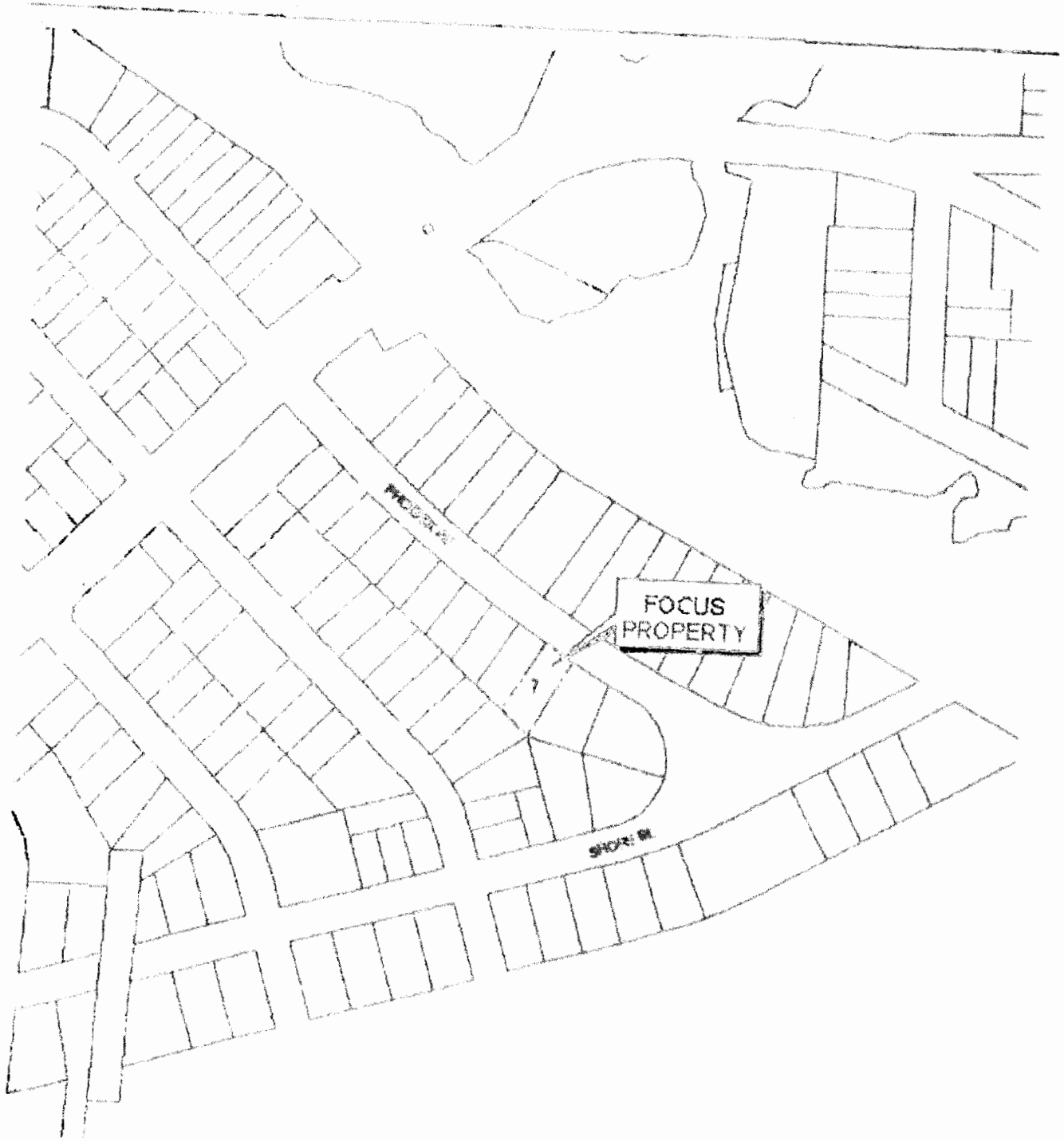

GENERAL LOCATOR MAP

22/28/16/96660/007/0070
VACANT PHOENIX AVE
OLDSMAR FL 34677

