

**Map 1 - Location**

**CASE #:** CW16-7

**FROM:** Residential Very Low

**AREA:** 4.2 Acres

**JURISDICTION:** Pinellas County

**TO:** Public/Semi-Public



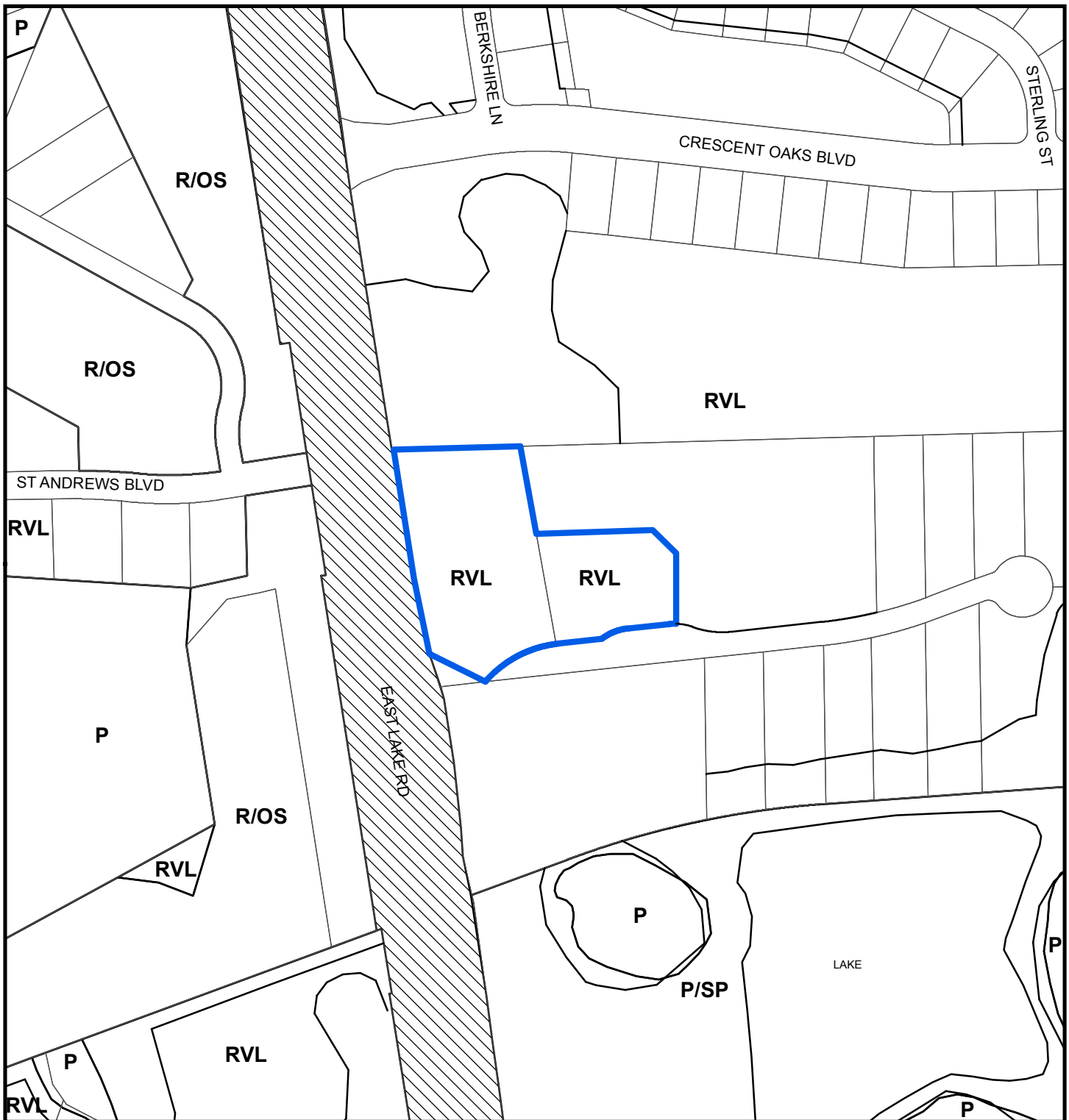

### Map 2 - Current Countywide Plan Map & Jurisdictional Map

**CASE #:** CW16-7

**FROM:** Residential Very Low

**AREA:** 4.2 Acres

**JURISDICTION:** Pinellas County

**TO:** Public/Semi-Public

**LEGEND:**

 Unincorporated

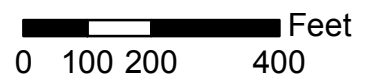



### Map 3 - Aerial

**CASE #:** CW16-7

**FROM:** Residential Very Low

**AREA:** 4.2 Acres

**JURISDICTION:** Pinellas County

**TO:** Public/Semi-Public

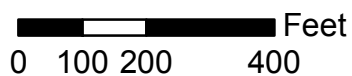



**Plan Map Categories**

- Residential Very Low
- Recreation/Open Space
- Public/Semi-Public
- Preservation
- Scenic/Noncommercial Corridor

**Map 4 - Current Countywide Plan Map**

**CASE #:** CW16-7

**FROM:** Residential Very Low

**AREA:** 4.2 Acres

**JURISDICTION:** Pinellas County

**TO:** Public/Semi-Public

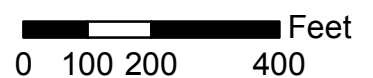



**Plan Map Categories**

- Residential Very Low
- Recreation/Open Space
- Preservation
- Public/Semi-Public
- Scenic/Noncommercial Corridor

**Map 5 - Proposed Countywide Plan Map**

**CASE #:** CW16-7

**FROM:** Residential Very Low

**AREA:** 4.2 Acres

**JURISDICTION:** Pinellas County

**TO:** Public/Semi-Public

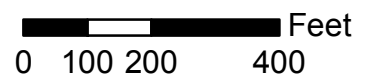

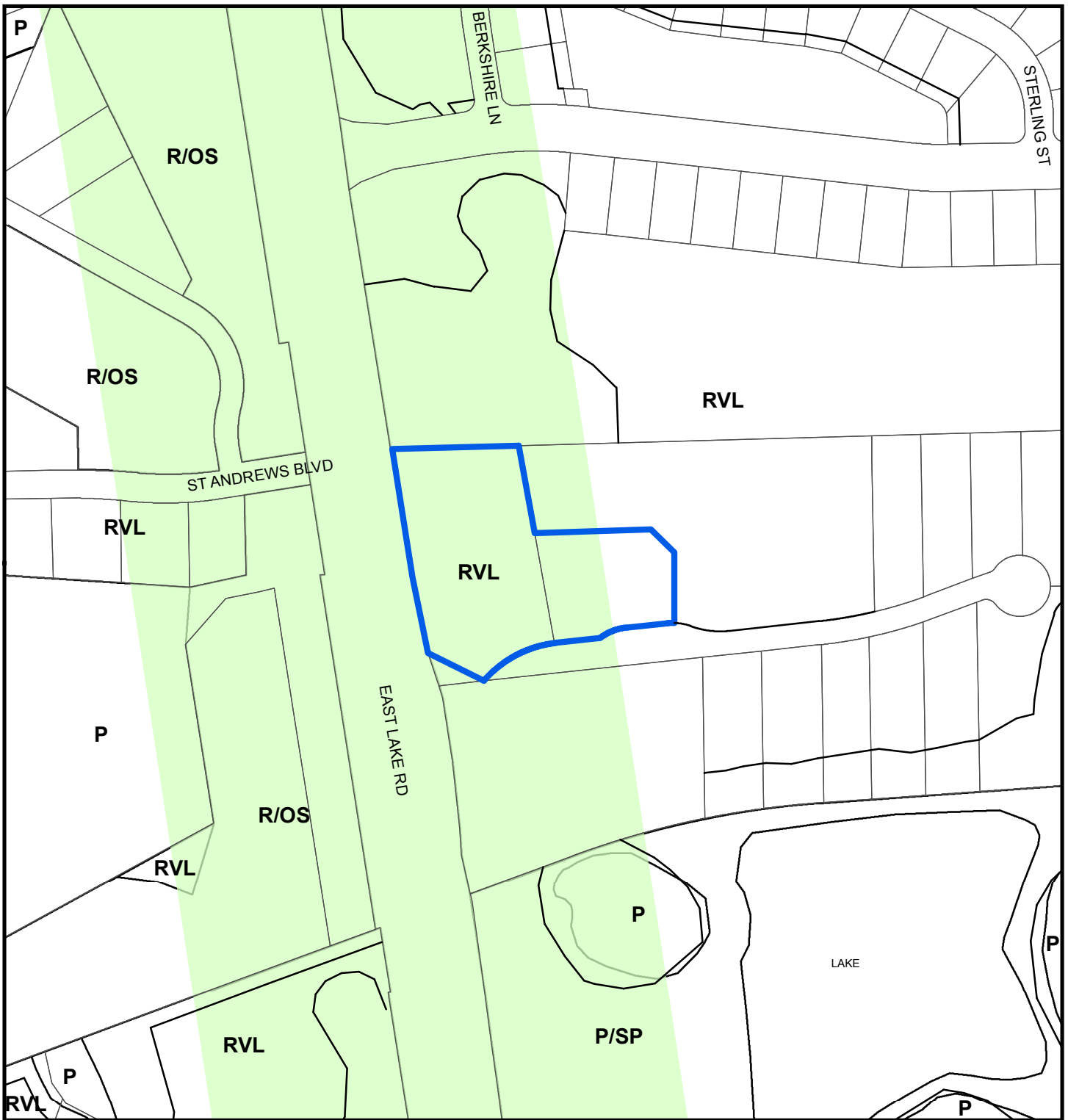

**Map 6 - Scenic/Noncommercial Corridor (SNCC)**

**CASE #:** CW16-7

**FROM:** Residential Very Low

**AREA:** 4.2 Acres

**JURISDICTION:** Pinellas County

**TO:** Public/Semi-Public

**SNCC TYPE:**

 Rural/Open Space

