

MAX LEASE AREA =
3,226.2 SQUARE FEET

PROPOSED LEASE AREA =
3,222.2 SQUARE FEET

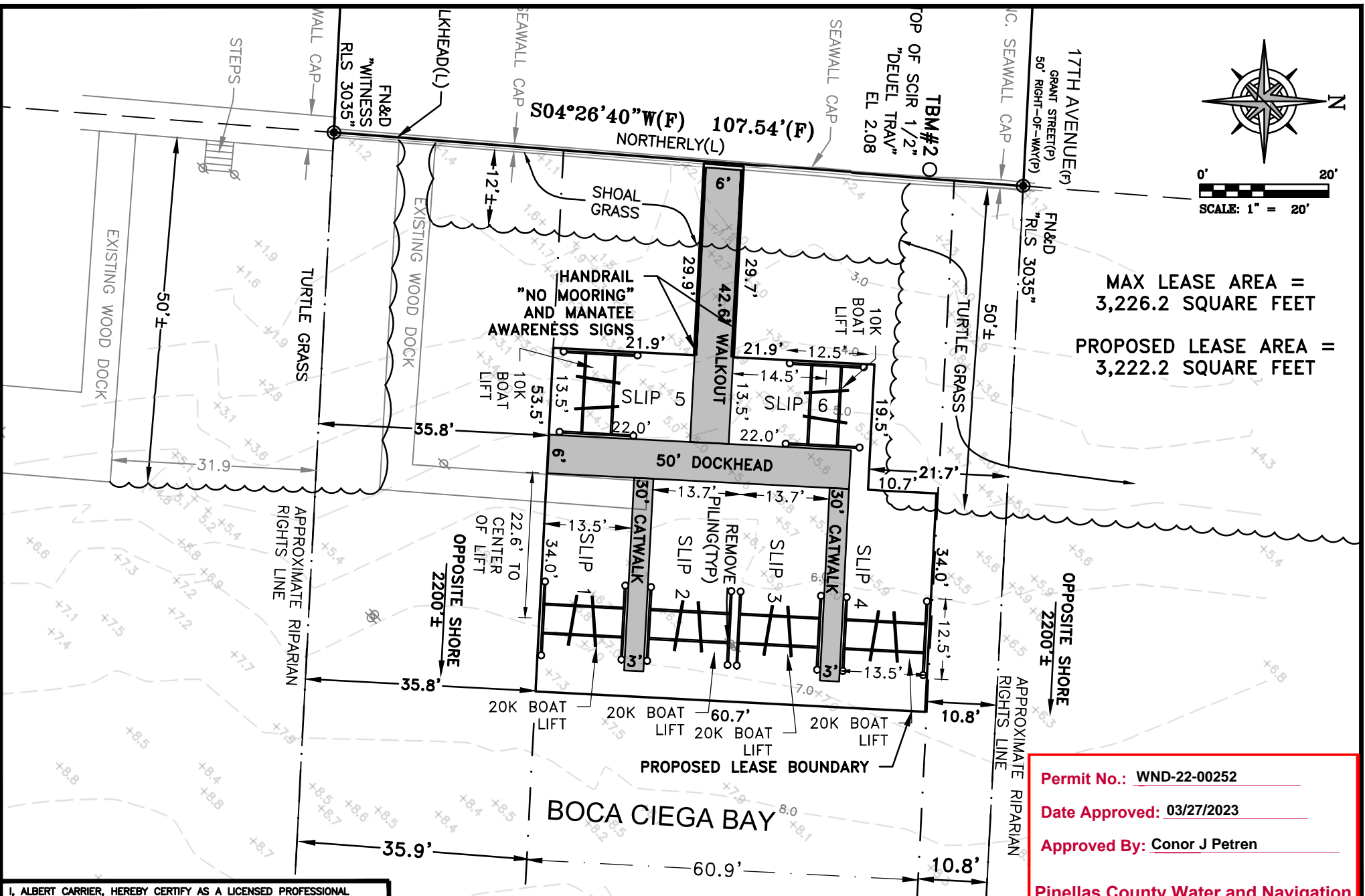

Permit No.: WND-22-00252

Date Approved: 03/27/2023

Approved By: Conor J Petren

Pinellas County Water and Navigation

I, ALBERT CARRIER, HEREBY CERTIFY AS A LICENSED PROFESSIONAL ENGINEER, REGISTERED IN ACCORDANCE WITH FLORIDA STATUTE 471 (481) THAT THE ABOVE PROJECT'S SITE AND/OR CONSTRUCTION PLANS, TO THE BEST OF MY KNOWLEDGE, INFORMATION AND BELIEF, WILL MEET APPLICABLE DESIGN CRITERIA SPECIFIED BY CITY MUNICIPAL ORDINANCE, STATE AND FEDERAL ESTABLISHED STANDARDS. I UNDERSTAND THAT IT IS MY RESPONSIBILITY AS THE PROJECT'S PROFESSIONAL ENGINEER TO PERFORM A QUALITY ASSURANCE REVIEW OF THESE SUBMITTED PLANS.

ALBERT P. CARRIER, P.E. 53990

TRANSYSTEMS

565 SOUTH HERCULES AVENUE, CLEARWATER, FL 33764
PHONE 727.822.4151
WWW.TRANSYSTEMS.COM

PROPOSED SITE PLAN
1605 PASS A GRILLE WAY

ST. PETE BEACH
FLORIDA

WORK ORDER	2021-112
DRAWN: LGT	DATE: 11/19/21
CHECK: AC	SCALE: 1"=20'
BY	SHEET: 1 OF 5