



HP
HIGH POINT ENGINEERING
 PROJECT: **PAVING, GRADING AND DRAINAGE PLAN**
 867 SOUTH BAYSHORE BOULEVARD
 SAFETY HARBOR, FLORIDA 34689
 LICENSE NO. SC 0001576
 POLITIS FAMILY RESIDENCE
 POLITIS FAMILY RESIDENCE

FOUNDATION AND SOIL NOTES
 DEPT. OF TRANSPORTATION
 DIVISION OF HIGHWAYS
 DISTRICT OFFICE

FOUNDATION AND SOIL NOTES
 THE FOUNDATION AND SOIL NOTES FOR THE PROJECT ARE AS FOLLOWS:
 1. THE SUBSTRATE AT THE SITE IS CLASSIFIED AS...
 2. THE PROPOSED GRADE IS...
 3. THE PROPOSED GRADE SHALL BE...
 4. THE PROPOSED GRADE SHALL BE...
 5. THE PROPOSED GRADE SHALL BE...



EXPLANATIONS OF SYMBOLS AND NOTES:
 ALL EXISTING AND PROPOSED ELEVATIONS ARE REFERENCED FROM NORTH AMERICAN VERTICAL DATUM (NAVD83).
 ALL DIMENSIONS ARE IN FEET AND INCHES.
 THE OWNER SHALL BE RESPONSIBLE FOR OBTAINING ALL NECESSARY PERMITS AND APPROVALS FROM THE APPROPRIATE AGENCIES.
 THE CONTRACTOR SHALL BE RESPONSIBLE FOR VERIFYING ALL CONDITIONS AND CONDITIONS OF THE SITE PRIOR TO COMMENCING WORK.

CHANGE OF TERMS: NOTE TO CONTRACTOR
 THE CONTRACTOR SHALL BE RESPONSIBLE FOR VERIFYING ALL CONDITIONS AND CONDITIONS OF THE SITE PRIOR TO COMMENCING WORK.
 THE CONTRACTOR SHALL BE RESPONSIBLE FOR OBTAINING ALL NECESSARY PERMITS AND APPROVALS FROM THE APPROPRIATE AGENCIES.
 THE CONTRACTOR SHALL BE RESPONSIBLE FOR VERIFYING ALL CONDITIONS AND CONDITIONS OF THE SITE PRIOR TO COMMENCING WORK.

0-3

HP
High Performance Engineering
Landscape Architecture - Civil Engineering - Geotechnical Engineering
1000 South Bayshore Boulevard
Suite 200
Tampa, Florida 33606
Tel: (813) 944-0300
Fax: (813) 944-0300
www.hpeinc.com

PROJECT: POLITIS FAMILY RESIDENCE
957 SOUTH BAYSHORE BOULEVARD
SAFETY HARBOR, FLORIDA 34885
EXISTING CONDITIONS AND DEMOLITION PLAN

DATE: 06/11/2013
DRAWN BY: [Signature]
CHECKED BY: [Signature]
PROJECT NO: [Number]

NOTES:
1. THIS PLAN IS A PART OF THE SUBMITTAL FOR THE PERMIT TO DEMOLISH THE EXISTING STRUCTURE AND TO CONSTRUCT THE NEW STRUCTURE.
2. THE CONTRACTOR SHALL OBTAIN ALL NECESSARY PERMITS AND APPROVALS FROM THE APPROPRIATE AGENCIES AND LOCAL JURISDICTIONS.
3. THE CONTRACTOR SHALL BE RESPONSIBLE FOR OBTAINING ALL NECESSARY EROSION CONTROL MEASURES AND TEMPORARY SEDIMENTATION CONTROL MEASURES TO PREVENT SOIL EROSION AND POLLUTION OF ADJACENT WATERSHEDS.
4. THE CONTRACTOR SHALL MAINTAIN ACCESS TO ALL ADJACENT PROPERTIES AT ALL TIMES.
5. THE CONTRACTOR SHALL PROTECT ALL EXISTING UTILITIES AND STRUCTURES THAT ARE NOT TO BE DEMOLISHED.
6. THE CONTRACTOR SHALL BE RESPONSIBLE FOR THE PROTECTION AND RESTORATION OF ALL ENVIRONMENTAL FEATURES, INCLUDING WETLANDS AND WATERWAYS.
7. THE CONTRACTOR SHALL MAINTAIN THE EXISTING LANDSCAPE AND PLANTING TO REMAIN.
8. THE CONTRACTOR SHALL BE RESPONSIBLE FOR THE REMOVAL OF ALL DEBRIS AND WASTE MATERIALS FROM THE SITE.
9. THE CONTRACTOR SHALL MAINTAIN ALL NECESSARY RECORDS AND AS-BUILT DRAWINGS OF THE DEMOLITION AND CONSTRUCTION WORK.

EXISTING TREES TO BE DEMOLISHED

DBH	HEIGHT	SPECIES	LOCATION
12"	15'	FLORIDA PALM	01-001
12"	15'	FLORIDA PALM	01-002
12"	15'	FLORIDA PALM	01-003
12"	15'	FLORIDA PALM	01-004
12"	15'	FLORIDA PALM	01-005
12"	15'	FLORIDA PALM	01-006
12"	15'	FLORIDA PALM	01-007
12"	15'	FLORIDA PALM	01-008
12"	15'	FLORIDA PALM	01-009
12"	15'	FLORIDA PALM	01-010
12"	15'	FLORIDA PALM	01-011
12"	15'	FLORIDA PALM	01-012
12"	15'	FLORIDA PALM	01-013
12"	15'	FLORIDA PALM	01-014
12"	15'	FLORIDA PALM	01-015
12"	15'	FLORIDA PALM	01-016
12"	15'	FLORIDA PALM	01-017
12"	15'	FLORIDA PALM	01-018
12"	15'	FLORIDA PALM	01-019
12"	15'	FLORIDA PALM	01-020

GENERAL NOTES:
1. THE CONTRACTOR SHALL MAINTAIN ALL EXISTING UTILITIES AND STRUCTURES THAT ARE NOT TO BE DEMOLISHED.
2. THE CONTRACTOR SHALL BE RESPONSIBLE FOR THE PROTECTION AND RESTORATION OF ALL ENVIRONMENTAL FEATURES, INCLUDING WETLANDS AND WATERWAYS.
3. THE CONTRACTOR SHALL MAINTAIN ACCESS TO ALL ADJACENT PROPERTIES AT ALL TIMES.
4. THE CONTRACTOR SHALL BE RESPONSIBLE FOR THE REMOVAL OF ALL DEBRIS AND WASTE MATERIALS FROM THE SITE.
5. THE CONTRACTOR SHALL MAINTAIN ALL NECESSARY RECORDS AND AS-BUILT DRAWINGS OF THE DEMOLITION AND CONSTRUCTION WORK.

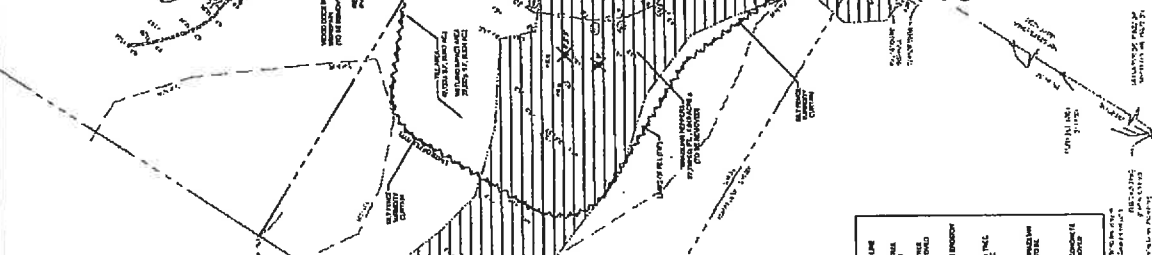
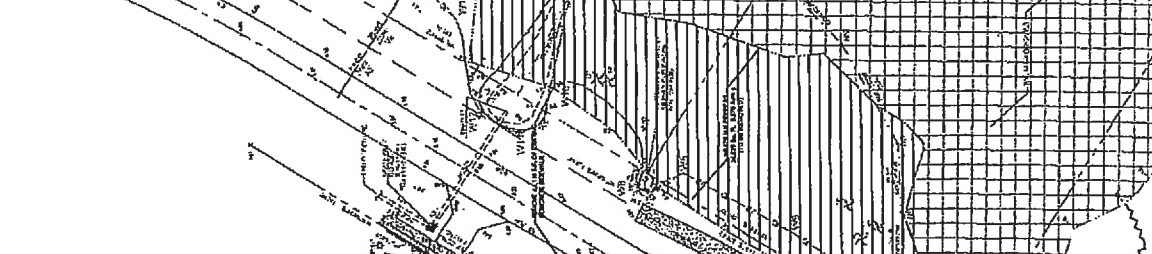
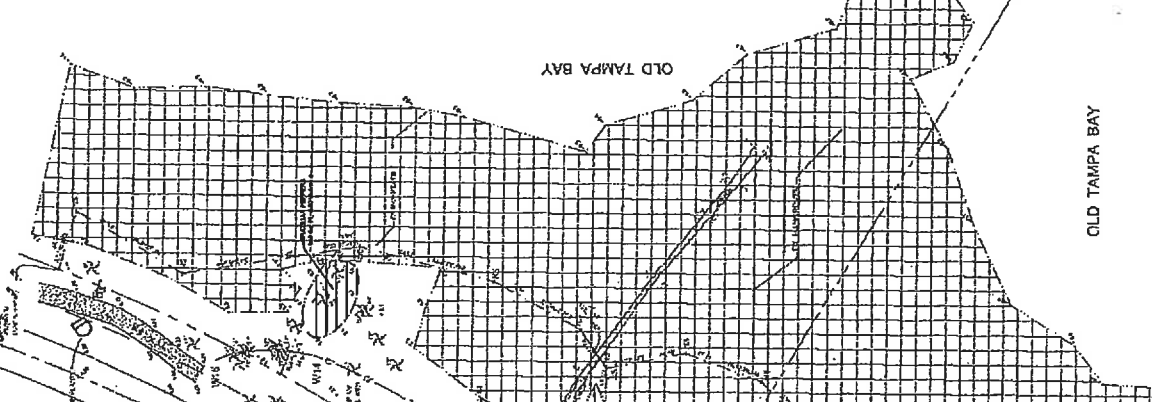

EXISTING TREES TO BE DEMOLISHED

DBH	HEIGHT	SPECIES	LOCATION
12"	15'	FLORIDA PALM	01-001
12"	15'	FLORIDA PALM	01-002
12"	15'	FLORIDA PALM	01-003
12"	15'	FLORIDA PALM	01-004
12"	15'	FLORIDA PALM	01-005
12"	15'	FLORIDA PALM	01-006
12"	15'	FLORIDA PALM	01-007
12"	15'	FLORIDA PALM	01-008
12"	15'	FLORIDA PALM	01-009
12"	15'	FLORIDA PALM	01-010
12"	15'	FLORIDA PALM	01-011
12"	15'	FLORIDA PALM	01-012
12"	15'	FLORIDA PALM	01-013
12"	15'	FLORIDA PALM	01-014
12"	15'	FLORIDA PALM	01-015
12"	15'	FLORIDA PALM	01-016
12"	15'	FLORIDA PALM	01-017
12"	15'	FLORIDA PALM	01-018
12"	15'	FLORIDA PALM	01-019
12"	15'	FLORIDA PALM	01-020

