

Map 1 - Location

CASE #: CW17-7

FROM: Residential Medium

AREA: 0.4 Acres

JURISDICTION: St. Petersburg

TO: Multimodal Corridor





Map 2 - Current Countywide Plan Map & Jurisdictional Map

CASE #: CW17-7

FROM: Residential Medium

AREA: 0.4 Acres

JURISDICTION: St. Petersburg

TO: Multimodal Corridor

LEGEND:

 St Petersburg

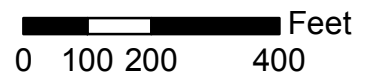

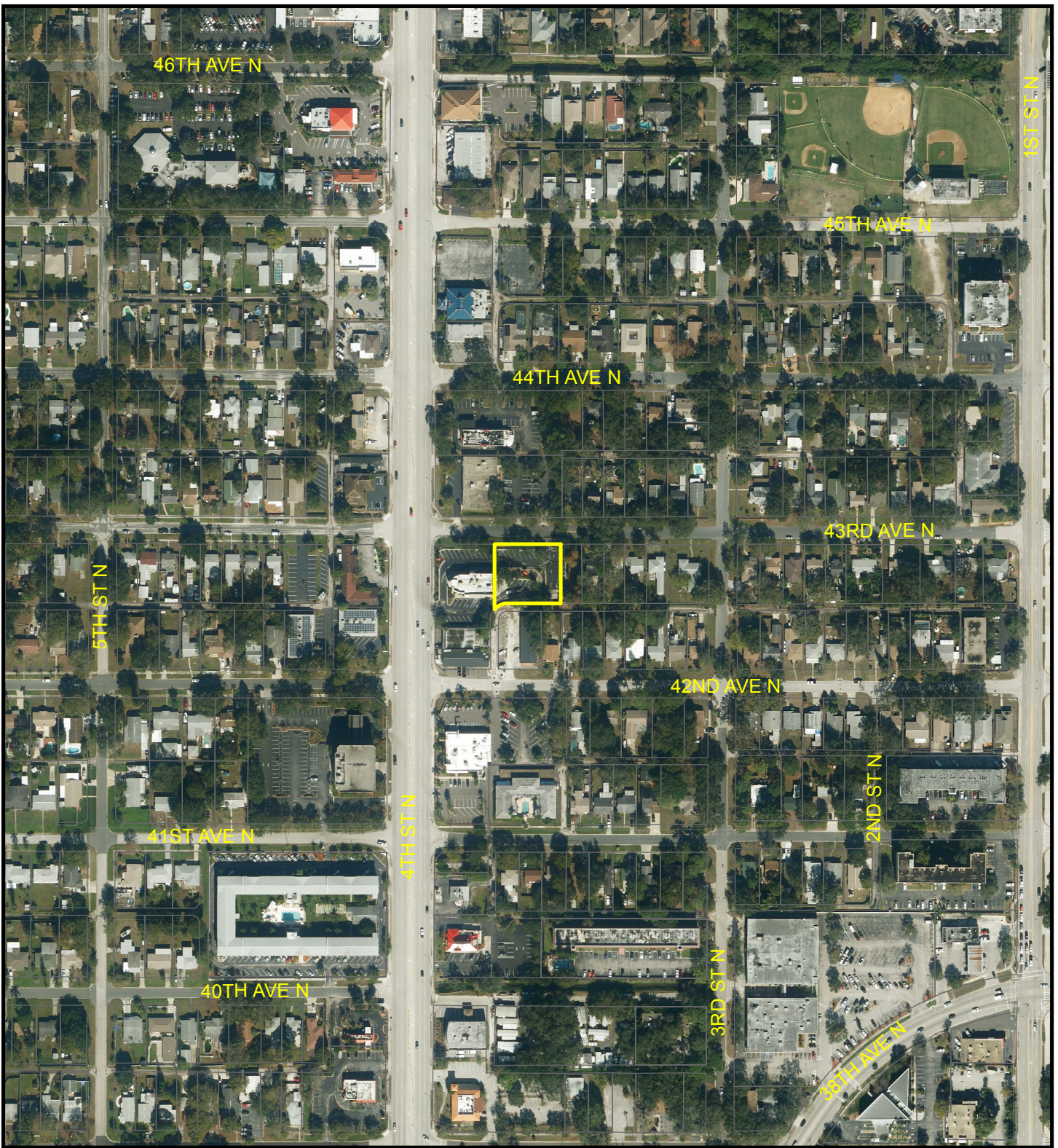

Map 3 - Aerial

CASE #: CW17-7

FROM: Residential Medium

AREA: 0.4 Acres

JURISDICTION: St. Petersburg

TO: Multimodal Corridor

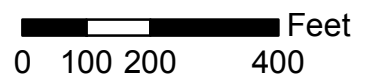

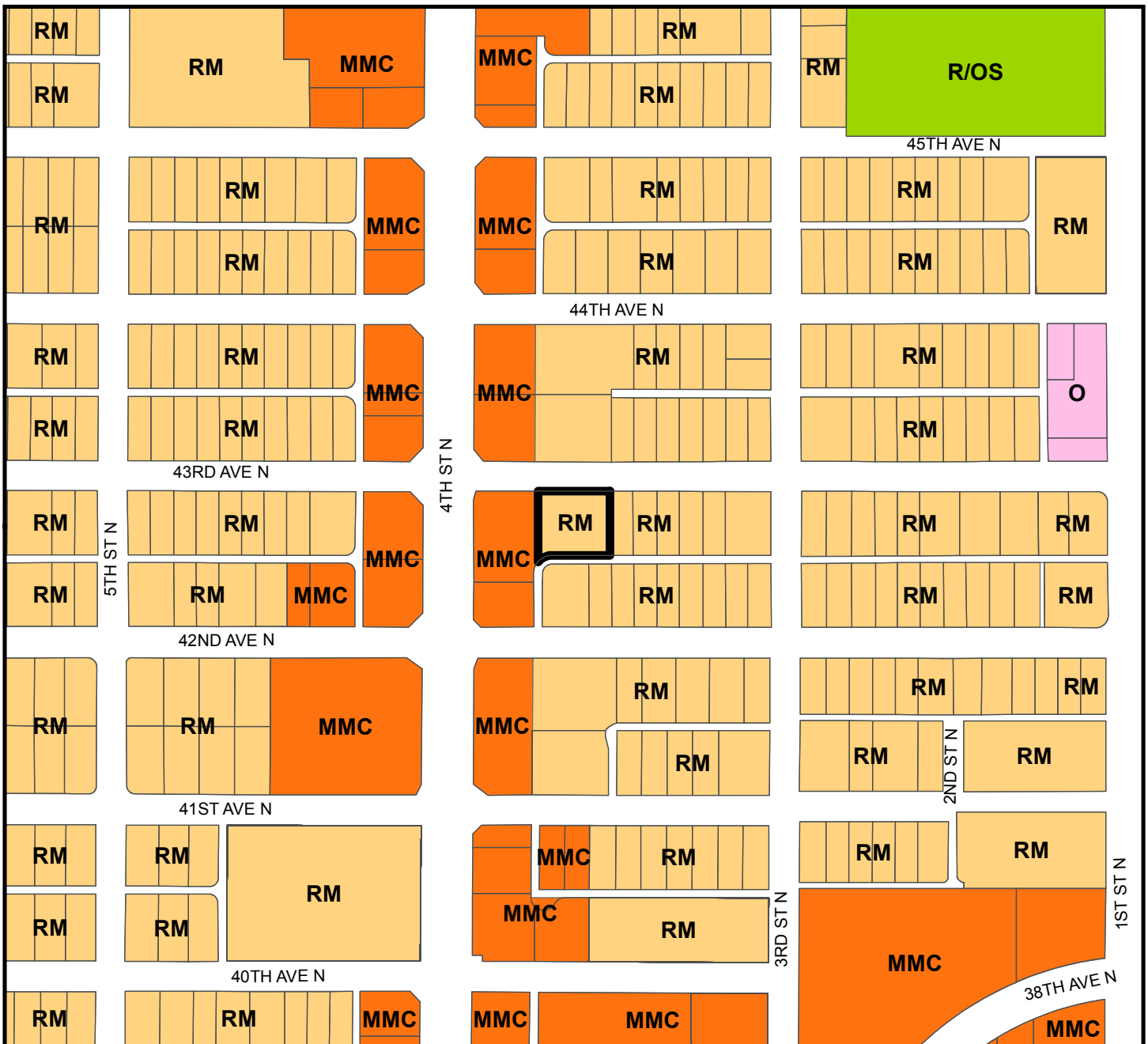

Countywide Plan Map Categories

- Residential Medium
- Recreation/Open Space
- Office
- Multimodal Corridor

Map 4 - Current Countywide Plan Map

CASE #: CW17-7

FROM: Residential Medium

AREA: 0.4 Acres

JURISDICTION: St. Petersburg

TO: Multimodal Corridor

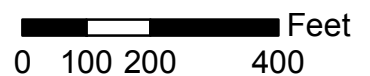



Countywide Plan Map Categories

- Residential Medium
- Recreation/Open Space
- Office
- Multimodal Corridor

Map 5 - Proposed Countywide Plan Map

CASE #: CW17-7

FROM: Residential Medium

AREA: 0.4 Acres

JURISDICTION: St. Petersburg

TO: Multimodal Corridor

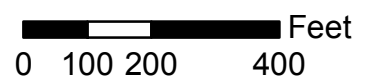



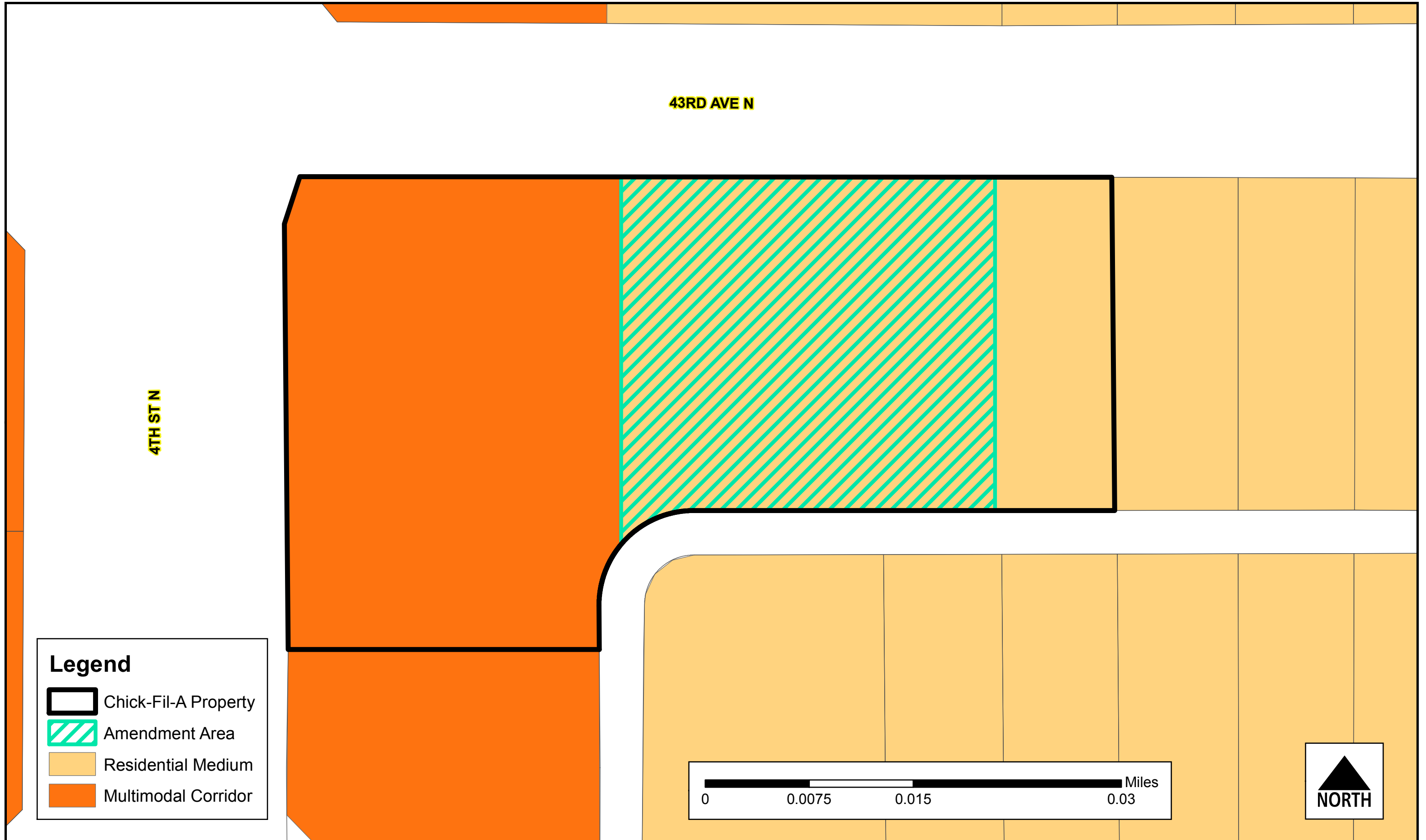

Countywide Plan Map Categories



43RD AVE N

4TH ST N

Legend

-  Chick-Fil-A Property
-  Amendment Area
-  Residential Medium
-  Multimodal Corridor

