

JOINT PROJECT AGREEMENT

BETWEEN PINELLAS COUNTY, THE CITY OF ST. PETE BEACH, AND THE CITY OF SOUTH PASADENA, FOR THE REPLACEMENT OF A SECTION OF A RECLAIMED WATER TRANSMISSION MAIN ADJACENT TO THE COREY CAUSEWAY MAINTAINED BY PINELLAS COUNTY.

**SECTION 1
INTENT OF AGREEMENT**

This AGREEMENT made and entered into this 15th day of August, 2023, by and between PINELLAS COUNTY, a political subdivision of the State of Florida, acting by and through its County Administrator, hereinafter referred to as "COUNTY", the CITY OF ST. PETE BEACH, FLORIDA, a municipal corporation within said Pinellas County, acting by and through its City Commission, herein referred to as "ST. PETE BEACH", and the CITY OF SOUTH PASADENA, FLORIDA, a municipal corporation within said Pinellas County, acting by and through its City Commission, herein referred to as "SOUTH PASADENA", collectively "PARTIES".

WITNESSETH that:

WHEREAS, the COUNTY desires to maintain the reclaimed water transmission main, herein referred to as TRANSMISSION MAIN, in good working order; and

WHEREAS, the COUNTY, ST. PETE BEACH, and SOUTH PASADENA previously entered into a reclaimed water service agreement on September 24, 1991, herein referred to as "SERVICE AGREEMENT", and subsequent amendment executed on April 6, 1993, herein referred to as "FIRST AMENDMENT", that establishes shared ownership of the TRANSMISSION MAIN as tenants in common; and

WHEREAS, the COUNTY owns and operates the reclaimed water transmission main, that had fallen into disrepair requiring emergency inspection, repair, and ultimate relocation along the Corey Causeway, in the general vicinity of Sun Island Drive South to Sailboat Key Boulevard South, as described in Exhibit A, herein referred to as the "PROJECT"; and

WHEREAS, the COUNTY and the PARTIES have determined that it would be to the best interest of the public and to the economic advantage of all PARTIES to enter into this AGREEMENT for the PROJECT accomplished by the COUNTY's contractor.

WHEREAS the COUNTY found that the scope of work to be performed was of significant complexity thereby requiring remediation by a specialized contractor herein referred to as "CONTRACTOR"; and

NOW, THEREFORE, in consideration of the monies hereinafter agreed to be paid and the mutual covenants contained herein, the PARTIES hereby mutually agree as follows:

**SECTION 2
SCOPE OF CONSTRUCTION SERVICES**

The scope of Construction Services for the PROJECT included the following:

The design and installation of a subaqueous reclaimed water transmission main, removal/disposal of the deficient appurtenances, easements, permits, and COUNTY survey, engineering, and construction management staff time chargeable to the PROJECT.

**SECTION 3
SERVICES TO BE PROVIDED BY THE COUNTY**

The COUNTY has provided in-house construction, engineering, and surveying staff time to the PROJECT, with design, construction and other requisite activities having been performed by or at the expense of the CONTRACTOR, or other private consultants through the COUNTY's general engineering services contracts.

The COUNTY shall ensure that any warranty, including materials, equipment, workmanship, and closeout documents, provided by the CONTRACTOR constructing the PROJECT, is passed on to ST. PETE BEACH and SOUTH PASADENA under the same terms and conditions as that warranty applies to facilities constructed or installed on behalf of the COUNTY.

**SECTION 4
FUNDING AND INVOICING**

The COUNTY has paid the total construction cost for the PROJECT in an amount of Two Million One Hundred Thirty-Seven Thousand Three Hundred and Two Dollars (\$2,137,302.00). Pursuant to Section 2, paragraph A, of the RECLAIMED WATER SERVICE AGREEMENT, shared capital costs were to be based on anticipated capacity commitments. The COUNTY will invoice ST. PETE BEACH and SOUTH PASADENA for the costs of the PROJECT based on proportionate flow-utilization using the past ten (10) fiscal years of available flow-data as provided in Exhibit B.

ST. PETE BEACH will reimburse the COUNTY an amount of One Million One Hundred Sixty-One Thousand Six Hundred Twenty-Three and 64/100 Dollars (\$1,161,623.64) for Design and Construction of the PROJECT. SOUTH PASADENA will reimburse the COUNTY an amount of Two Hundred Seventy-Seven Thousand Eight Hundred Forty-Nine and 26/100 Dollars (\$277,849.26) for Design and Construction of the PROJECT. SOUTH PASADENA will reimburse the COUNTY in full within thirty (30) days of execution of this Agreement. ST. PETE BEACH shall pay the COUNTY in accordance with the following schedule:

ST. PETE BEACH

Due October 1, 2023: \$232,324.73
Due October 1, 2024: \$232,324.73
Due October 1, 2025: \$232,324.73
Due October 1, 2026: \$232,324.73
Due October 1, 2027: \$232,324.72
TOTAL: \$1,161,623.64

The COUNTY shall process invoices from the CONTRACTOR and submit a copy to ST. PETE BEACH and SOUTH PASADENA along with requests for payment. ST. PETE BEACH and SOUTH PASADENA shall make all payments to the COUNTY in accordance with the Florida Prompt Payment Act.

**SECTION 5
ACCOUNTING RECORDS**

Records of expenses pertaining to all services performed shall be kept in accordance with generally recognized accounting principles and procedures.

**SECTION 6
TERM OF AGREEMENT**

This AGREEMENT shall commence on the date of execution and upon filing with the Clerk of Circuit Court in Pinellas County in accordance with Florida Statutes, Section 163.01(11), and shall continue in full force and until the Cities provides to the County mutually agreeable documentation which substantiates that this AGREEMENT has been fully performed and COUNTY has paid all invoices under Section 5.

**SECTION 7
TERMINATION**

Upon written notice, this AGREEMENT may be terminated by any of the PARTIES in the event of substantial failure of another party to fulfill its obligation under this AGREEMENT through no fault of the terminating party. This AGREEMENT shall be deemed terminated on the fifteenth (15th) day after receipt of written notice of termination. The COUNTY, however, shall be entitled to receive payment for all work completed as of the date of termination.

**SECTION 8
NOTICE**

All notices or reports under this AGREEMENT shall be directed to the following addresses:

Project Manager for the COUNTY:	Dennis Simpson, P.E. Pinellas County Utilities Engineering 14 S. Ft. Harrison Avenue, 6 th Floor Clearwater, FL 33756
Project Manager for ST. PETE BEACH:	Nancy Bostock City of St. Pete Beach 155 Corey Avenue St. Pete Beach, FL 33706
Project Manager for SOUTH PASADENA:	Shawn Shimko City of South Pasadena 7047 Sunset Drive South South Pasadena, FL 33707

**SECTION 9
PRIOR AGREEMENTS**

Nothing in the AGREEMENT is intended to modify the Reclaimed Water Service Agreement between the COUNTY and ST. PETE BEACH and SOUTH PASADENA executed September 24, 1991, amended April 6, 1993, or the Maintenance and Customer Services Agreement between the COUNTY and the CITY executed November 24, 1992 and the renewal agreement for maintenance and customer services between the COUNTY and ST. PETE BEACH executed November 4, 1997, except as explicitly captured in Section 4: Funding and Invoicing, of this AGREEMENT.

**SECTION 10
ENTIRE AGREEMENT**

This document embodies the whole AGREEMENT of the PARTIES. There are no promises, terms, conditions, or allegations other than those contained herein, and this document shall supersede all previous communications, representations and/or Agreements, whether written or verbal, between the PARTIES hereto. This AGREEMENT may be modified only in writing executed by all PARTIES. This AGREEMENT shall be binding upon the PARTIES, their successors, assigns and legal representatives.

IN WITNESS WHEREOF, the PARTIES hereto, or their lawful representative, have executed this AGREEMENT as of the date first above written.

CITY OF ST. PETE BEACH,
a municipal corporation
of the State of Florida

By: 

Adrian Petrita, City Mayor

ATTEST:

By: 

Amber LaRowe, City Clerk

APPROVED AS TO FORM:

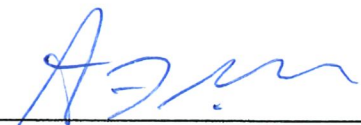
By: 

Office of City Attorney

IN WITNESS WHEREOF, the PARTIES hereto, or their lawful representative, have executed this AGREEMENT as of the date first above written.

CITY OF SOUTH PASADENA,
a municipal corporation
of the State of Florida

By: 
Arthur Penny, City Mayor

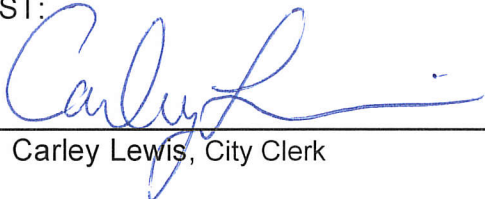
ATTEST:
By: 
Carley Lewis, City Clerk

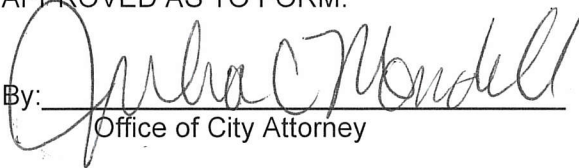
APPROVED AS TO FORM:
By: 
Office of City Attorney

IN WITNESS WHEREOF, the PARTIES hereto, or their lawful representative, have executed this AGREEMENT as of the date first above written.

PINELLAS COUNTY, FLORIDA, a political subdivision of the State of Florida, by and through its Board of County Commissioners

By: *Janet C. Long*
Janet Long, Chair

ATTEST:

By: *Ken Burke*
Ken Burke, Clerk of the Circuit Court



APPROVED AS TO FORM:

APPROVED AS TO FORM

By: *Miles Belknap*

By: Office of the County Attorney
Office of the County Attorney

EXHIBIT A



REPLY TO
ATTENTION OF

DEPARTMENT OF THE ARMY
CORPS OF ENGINEERS, JACKSONVILLE DISTRICT
TAMPA PERMITS SECTION
10117 PRINCESS PALM AVE, SUITE 120
TAMPA, FLORIDA 33610-8302

August 21, 2019

Regulatory Division
West Permits Branch
Tampa Permits Section
SAJ-2019-02720 (RP-KRD)

Mr. Dennis Simpson
Pinellas County
14 S. Ft. Harrison Avenue
Clearwater, Florida 33756
Sent via Email: dsimpson@pinellascounty.org

Dear Mr. Simpson:

The U.S. Army Corps of Engineers (Corps) has completed reviewed of your application for a Department of the Army (DA) permit, which the Corps received on July 29, 2019 and assigned DA file number SAJ-2019-02720 (NW-KRD). A review of the information and drawings provided indicates that the proposed work would result in the removal of the existing 20-inch reclaimed water main attached to the FDOT/SR-693 southbound bridge and installation of a new 24-inch HDPE pipe via HDD under Boca Ciega Bay between the SR-693/Pasadena Avenue South bridges, in Section 36, Township 31 South, Range 15 East, South Pasadena, Pinellas County, Florida. Approximate center coordinates: Latitude 27.751287 and Longitude -82.740784.

You are authorized to conduct the work as described above and as depicted on the enclosed drawings (Enclosure 1) by Regional General Permit (GP) SAJ-14 - *Subaqueous Utility and Transmission Lines in Florida*. You must ensure that the work is performed in accordance with the SAJ-14 Special Conditions (Enclosure 2) and the Project-Specific Special Conditions listed below or you may be subject to enforcement action. This DA permit authorization is being issued pursuant to Section 10 of the Rivers and Harbors Act of 1899 (Section 10). Section 10 requires prior authorization for structures and work in, over, under, and affecting navigable waters. This authorization is valid until **February 22, 2024**.

You can also access the Corps' Regulatory webpage to view the special and general conditions for SAJ-14, which apply specifically to this authorization. The website address is as follows: <http://www.saj.usace.army.mil/Missions/Regulatory/SourceBook.aspx>. Please be aware this web address is case sensitive and should be entered as it appears above. Once there you will need to click on "General Permits." Then you can click on the specific SAJ permit.

Project Specific Special Conditions:

The following project specific special conditions are included with this verification:

- 1. Reporting Addresses:** The Permittee shall submit all reports, notifications, documentation and correspondence required by the general and special conditions of this permit to the following address:

- a. For standard mail: U.S. Army Corps of Engineers, Regulatory Division, Special Projects & Enforcement Branch, Tampa Office (ATTN: Tracy Hurst), 10117 Princess Palm Avenue, Suite 120, Tampa, Florida 33610-8302.
 - b. For electronic mail: SAJ-RD-Enforcement@usace.army.mil (not to exceed 10 MB). To submit files larger than 10MB, contact the Corps to obtain a code/link to our Secure Access File Exchange. Once you have received your code, go to <https://safe.apps.mil/> to "Drop-off" (upload) your file. The Permittee shall reference this DA permit number, SAJ-2019-00688, on all submittals.
2. **Commencement Notification:** Within ten (10) days from the date of initiating the work authorized by this permit the Permittee shall provide a written notification of the date of commencement of authorized work to the Corps at the address provided in Project Specific Special Condition #1.
3. **As-Built Certification:** You must provide the required as-built certification and plans as specified in Regional General Permit (GP) SAJ-14 Special Condition #34 (Enclosure 2). Submit the as-built certification (Enclosure 3) and plans to at the email address provided in Project Specific Special Condition #1 above.
4. **Authorized Depth:** All subaqueous utility and/or transmission lines authorized by this regional general permit must be installed a minimum of 14 feet below the authorized depth of any federally-maintained shallow draft navigation channel it crosses. The 14-foot criterion applies to the entire authorized width of the channel, plus a minimum of 25 feet outside the channel edges to allow for maintenance of the side slopes.
5. **Manatee Conditions:** The Permittee shall comply with the 2013 *Standard Manatee Conditions for In-Water Work* provided as an attachment to this permit (Enclosure 2).
6. **National Marine Fisheries Service's Jacksonville District's Programmatic Biological Opinion (JAXBO) Project Design Criteria (PDC) Conditions:** The permittee shall comply with the following PDCs and special conditions to ensure the project does not have an adverse impact on listed species protected under Section 7 of the Endangered Species Act.
 - a. **Project Design Criteria (PDCs) for In-Water Activities:** The Permittee shall comply with National Marine Fisheries Service's "PDCs for In-Water Activities" dated November 20, 2017 (Figure 3 in Enclosure 2).
7. **Frac-Out Contingency Plan:** The Permittee shall comply with the Frac-out contingency plan (Enclosure 1). In the event of a frac-out, the permittee shall notify the Corps within 48 hours of the incident. Notification shall include the time/location of the frac-out, an estimate of the area/volume of the discharge, and a description of impacts to aquatic resources, e.g., seagrass, mangrove, hard bottom. Additionally, the notification shall include measures being taken to contain the discharge and protect aquatic resources. Drilling mud (fluid) discharged as a result of the Frac-out shall be removed from Corps

jurisdictional waters and wetlands, and the area restored to pre-impact conditions to the extent determined to be practicable by the Corps.

- 8. Posting of Permit:** The Permittee shall ensure that all contractors, subcontractors, and entities associated with the implementation of the project review, understand, and comply with the approved plans and special conditions made part of this permit. The Permittee shall inform all parties associated with the activity of the construction area boundaries and the location of adjacent wetlands to be avoided. Complete copies of the permit and approved plans shall be available at the construction site at all times. Failure to comply with the approved plans and permit special conditions may subject the Permittee to enforcement action.

- 9. Regulatory Agency Changes/Approvals:** Should any other agency require and/or approve changes to the work authorized or obligated by this permit, the Permittee is advised a modification to this permit instrument is required prior to initiation of those changes. It is the Permittee's responsibility to request a modification of this permit from the Tampa Permits Section. The Corps reserves the right to fully evaluate, amend, and approve or deny the request for modification of this permit.

This letter of authorization does not obviate the necessity to obtain any other Federal, State, or local permits, which may be required. Prior to the initiation of any construction, projects qualifying for this Nationwide permit must qualify for an exemption under section 403.813(1), Florida Statutes or 373.406, Florida Statutes, or otherwise be authorized by the applicable permit required under Part IV of Chapter 373, Florida Statutes, by the Department of Environmental Protection, a water management district under section 373.069, Florida Statutes, or a local government with delegated authority under section 373.441, Florida Statutes, and receive Water Quality Certification and applicable Coastal Zone Consistency Concurrence or waiver thereto, as well as any authorizations required for the use of state-owned submerged lands under Chapter 253, Florida Statutes, and, as applicable, Chapter 258, Florida Statutes. You should check State-permitting requirements with the Florida Department of Environmental Protection or the appropriate water management district.

This letter of authorization does not include conditions that would prevent the 'take' of a state-listed fish or wildlife species. These species are protected under sec. 379.411, Florida Statutes, and listed under Rule 68A-27, Florida Administrative Code. With regard to fish and wildlife species designated as species of special concern or threatened by the State of Florida, you are responsible for coordinating directly with the Florida Fish and Wildlife Conservation Commission (FWC). You can visit the FWC license and permitting webpage (<http://www.myfwc.com/license/wildlife/>) for more information, including a list of those fish and wildlife species designated as species of special concern or threatened. The Florida Natural Areas Inventory (<http://www.fnai.org/>) also maintains updated lists, by county, of documented occurrences of those species.

This letter of authorization does not give absolute Federal authority to perform the work as specified on your application. The proposed work may be subject to local building restrictions mandated by the National Flood Insurance Program. You should contact your local office that

issues building permits to determine if your site is located in a flood-prone area, and if you must comply with the local building requirements mandated by the National Flood Insurance Program.

Thank you for your cooperation with our permit program. The Corps Jacksonville District Regulatory Division is committed to improving service to our customers. We strive to perform our duty in a friendly and timely manner while working to preserve our environment. We invite you to complete our automated Customer Service Survey at http://corpsmapu.usace.army.mil/cm_apex/f?p=regulatory_survey. Please be aware this Internet address is case sensitive; and, you will need to enter it exactly as it appears above. Your input is appreciated – favorable or otherwise.

Should you have any questions related to this NWP verification or have issues accessing the documents reference in this letter, please contact me via telephone at (813) 769-7076 or via e-mail at Katy.R.Damico@usace.army.mil.

Sincerely,

A handwritten signature in blue ink that reads "Katy R. Damico". The signature is written in a cursive style with a loop for the letter 'K'.

Katy R. Damico
Project Manager
Tampa Permits Section

Enclosures

Cc (via email):

Kevin Gerszuny, Kimley-Horn, Kevin.Gerszuny@kimley-horn.com

GENERAL CONDITIONS
33 CFR PART 320-330

1. The time limit for completing the work authorized ends on **February 22, 2024**.
2. You must maintain the activity authorized by this permit in good condition and in conformance with the terms and conditions of this permit. You are not relieved of this requirement if you abandon the permitted activity, although you may make a good faith transfer to a third party in compliance with General Condition 4 below. Should you wish to cease to maintain the authorized activity or should you desire to abandon it without a good faith transfer, you must obtain a modification of this permit from this office, which may require restoration of the area.
3. If you discover any previously unknown historic or archeological remains while accomplishing the activity authorized by this permit, you must immediately notify this office of what you have found. We will initiate the Federal and state coordination required to determine if the remains warrant a recovery effort or if the site is eligible for listing in the National Register of Historic Places.
4. If you sell the property associated with this permit you must obtain the signature of the new owner in the space provided and forward a copy of the permit to this office to validate the transfer of this authorization.
5. If a conditioned water quality certification has been issued for your project, you must comply with the conditions specified in the certification as special conditions to this permit.
6. You must allow a representative from this office to inspect the authorized activity at any time deemed necessary to ensure that it is being or has been accomplished in accordance with the terms and conditions of your permit.

DEPARTMENT OF THE ARMY PERMIT TRANSFER REQUEST

DA PERMIT NUMBER: SAJ-2019-02720 (RP-KRD)

When the structures or work authorized by this permit are still in existence at the time the property is transferred, the terms and conditions of this permit will continue to be binding on the new owner(s) of the property. Although the construction period for works authorized by Department of the Army permits is finite, the permit itself, with its limitations, does not expire.

To validate the transfer of this permit and the associated responsibilities associated with compliance with its terms and conditions, have the transferee sign and date below and mail to the U.S. Army Corps of Engineers, Enforcement Section, Post Office Box 4970, Jacksonville, FL 32232-0019.

(TRANSFeree-SIGNATURE)

(SUBDIVISION)

(DATE)

(LOT)

(BLOCK)

(NAME-PRINTED)

(STREET ADDRESS)

(MAILING ADDRESS)

(CITY, STATE, ZIP CODE)



SOUTH PASADENA RECLAIMED WATER MAIN RELOCATION 90% DESIGN

PID 2936B FINANCIAL PID 2936B

PINELLAS COUNTY
LOCATION MAP



PROJECT LOCATION

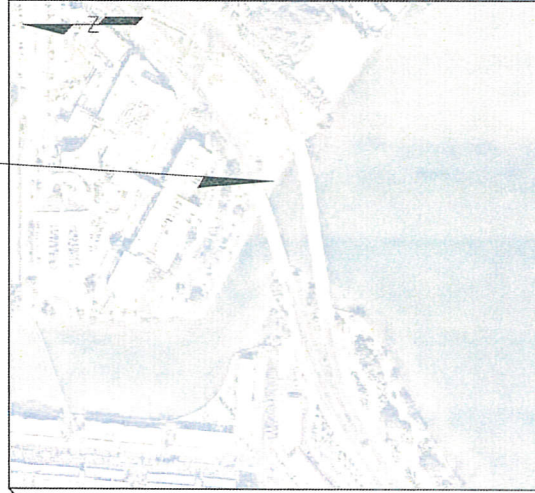

SECTION 06, TOWNSHIP 31 SOUTH, RANGE 16 EAST

KEY MAP
NOT TO SCALE

SHEET INDEX

SHEET NO.	DESCRIPTION
01	COVER SHEET
02 - 04	GENERAL NOTES
05 - 06	PLAN & PROFILE
07 - 09	DETAILS

PROJECT MANAGER: DENNIS SIMPSON, P.E.
727-464-4223

PINELLAS COUNTY
14 SOUTH FORT HARRISON AVENUE
ST. PETERSBURG, FL 33701
PHONE: (727)464-3588

PREPARED BY:

100 S.W. 3rd St. Suite 300
St. Petersburg, FL 33701
CERTIFICATE OF PROFESSIONAL ENGINEERING
NO. 12456
EXPIRES 12/31/2019

STATE OF FLORIDA
PROFESSIONAL ENGINEER IN CHARGE
DATE

US Army Corps of Engineers
Tampa Permits Section
Received by CESALRD-WTKRD
Date: August 15, 2019

RELATED STANDARDS AND SPECIFICATIONS:

DOCUMENT	DESCRIPTION
D-1	U.S. DEPARTMENT OF TRANSPORTATION FEDERAL HIGHWAY ADMINISTRATION (FHWA) UNIFORM TRAFFIC CONTROL DEVICES FOR STREETS AND HIGHWAYS, 2009.
D-2	FLORIDA DEPARTMENT OF TRANSPORTATION (FDOT) "STANDARD SPECIFICATIONS FOR ROAD AND BRIDGE CONSTRUCTION" DIVISION II & III LATEST EDITION AND ALL SUPPLEMENTAL STANDARDS THEREIN.
D-3	STATE OF FLORIDA "MANUAL OF UNIFORM MINIMUM STANDARDS FOR DESIGN, CONSTRUCTION AND MAINTENANCE FOR STREETS AND HIGHWAYS", 2009 ("GREEN BOOK").
D-4	FLORIDA DEPARTMENT OF TRANSPORTATION "DESIGN STANDARDS FOR DESIGN, CONSTRUCTION, MAINTENANCE AND UTILITY OPERATIONS ON THE STATE HIGHWAY SYSTEM", 2012.
D-5	FLORIDA STORMWATER EROSION AND SEDIMENTATION CONTROL INSPECTOR'S MANUAL, 2008.
D-6	STATE OF FLORIDA EROSION AND SEDIMENT CONTROL DESIGNER AND REVIEWER MANUAL, LATEST EDITION.
D-7	PINELLAS COUNTY PUBLIC WORKS "STANDARD TECHNICAL SPECIFICATIONS FOR ROADWAY AND RELATED CONSTRUCTION", LATEST EDITION AVAILABLE ON-LINE (http://www.pinelascounty.org/technical/pdf/roadway-tech-specs-January-2016.pdf).
D-8	PINELLAS COUNTY "STANDARD ENGINEERING DETAILS", LATEST EDITION AVAILABLE ON-LINE (http://www.pinelascounty.org/technical).
D-9	PINELLAS COUNTY STANDARD TECHNICAL SPECIFICATIONS FOR UTILITIES AND RELATED CONSTRUCTION, LATEST EDITION AVAILABLE ONLINE (http://www.pinelascounty.org/utilities/pdf/eng_speccu.pdf).
D-10	PINELLAS COUNTY UTILITIES "MATERIAL SPECIFICATION MANUAL", LATEST EDITION AVAILABLE ON-LINE (http://www.pinelascounty.org/technical/pdf/material-specs-manual.pdf).
D-11	PINELLAS COUNTY "SPECIFICATIONS FOR HOT BITUMINOUS MIXTURES, PLANT METHODS, EQUIPMENT AND CONSTRUCTION METHODS, 2013.

NOTE: PROVISIONS OF DOCUMENT D-11 SHALL SUPERSEDE CORRESPONDING PROVISIONS OF DOCUMENT D-2 WITH RESPECT TO OPERATION AND TESTING.

EXCAVATION AND GRADING

- ALL SUB-PHASES SHALL BE GOOD, CLEAN, ACCEPTABLE MATERIAL COMPROMISED TO MAXIMUM DENSITY AS DETERMINED BY ASP10 T-99, IN ACCORDANCE WITH FOOT STANDARD SPECIFICATIONS FOR ROAD AND BRIDGE CONSTRUCTION.
- FINAL GROUND COVER FOR ALL AREAS OF EXPOSED EARTH RESULTING FROM CONSTRUCTION ACTIVITIES SHALL BE SODDED AS SHOWN ON THE PLANS AND AS DIRECTED BY THE ENGINEER. SEEDING SHALL NOT BE USED AS FINAL GROUND COVER EXCEPT WHERE SPECIFICALLY SHOWN IN THE PLANS OR AS DIRECTED BY THE ENGINEER.
- THE CONTRACTOR SHALL BACKFILL AREAS TO BE SODDED WITH CLEAN FILL TO MAINTAIN PROPER GRADE OF PLANTING AREAS, AND THE SOD SHALL BE PROPERLY CUT-IN AND TAMPED. THE COST OF THIS WORK SHALL BE INCLUDED IN THE UNIT PRICE BID FOR SODDING (SY).
- SOD STABILIZATION SHALL OCCUR IMMEDIATELY AFTER ACHIEVING FINAL GRADE. SEEDING SHALL BE INCLUDED IN THE SOD STABILIZATION WORK. THE COST OF THIS WORK SHALL BE INCLUDED IN THE UNIT PRICE BID FOR SODDING (SY).
- THE CONTRACTOR SHALL PROVIDE ALL SHEETING, SHORING, AND BRACING REQUIRED TO PROTECT ADJACENT STRUCTURES AND UTILITIES, OR TO MINIMIZE TRENCH WIDTH. THE COST OF ALL SHEETING, SHORING, AND BRACING REQUIRED SHALL BE INCLUDED IN THE UNIT PRICE BID FOR THE NEW WORK FOR WHICH SHEETING, SHORING, AND BRACING IS REQUIRED.
- UNSUITABLE MATERIAL SHALL BECOME THE PROPERTY OF THE CONTRACTOR AND SHALL BE DISPOSED OF OFF-SITE, AT A SUITABLE SITE PROVIDED BY THE CONTRACTOR. THE CONTRACTOR SHALL BE

- RESPONSIBLE FOR ANY AND ALL PERMITS AND UNSUITABLE MATERIAL REQUIRED FOR THE TRANSPORT AND DISPOSAL OF UNSUITABLE MATERIAL. NO ADDITIONAL PAYMENT WILL BE MADE FOR UNSUITABLE MATERIAL UNLESS A SPECIFIC PAY ITEM IS PROVIDED IN THE CONTRACT.
- ALL EXCESS EXCAVATED SUITABLE AND UNSUITABLE MATERIAL NOT CLAIMED BY THE COUNTY SHALL BECOME THE PROPERTY OF THE CONTRACTOR, AND SHALL BE DISPOSED OF BY THE CONTRACTOR IN ACCORDANCE WITH ALL APPLICABLE REGULATIONS, PERMITS, AND OTHER COSTS INCURRED SHALL BE INCLUDED IN THE UNIT PRICE BID FOR GRADING (LUMP SUM).
- BORROW MATERIAL REQUIRED FOR CONSTRUCTION SHALL BE PROVIDED BY THE CONTRACTOR FROM BORROW AREAS PROVIDED BY THE CONTRACTOR.
- EXCEPT FOR THE COST OF EXCAVATING UNSUITABLE MATERIAL AND THE COST OF FURNISHING, PLACING, AND COMPACTING FILL TO REPLACE UNSUITABLE MATERIAL, THE CONTRACTOR SHALL BE RESPONSIBLE FOR THE ENTIRE COST OF ALL EMBANKMENT AND EXCAVATION, GRADED CONNECTIONS, FINAL DRESSING, AND SIMILAR EARTHWORK OPERATIONS REQUIRED FOR THE COMPLETION OF THE PROJECT, UNLESS OTHERWISE DIRECTED BY THE ENGINEER.
- ANY GRADING OR CONSTRUCTION PERMITTED ON THE PLANS BEYOND THE RIGHT-OF-WAY AND WITHIN THE LIMITS OF CONSTRUCTION IS TO BE PERFORMED ONLY AFTER RECEIPT OF PERMISSION FROM THE PROPERTY OWNER THROUGH A RIGHT OF ENTRY AGREEMENT AND/OR A SIDEWALK, UTILITY, OR DRAINAGE EASEMENT. ONLY AFTER NOTIFICATION BY THE ENGINEER THAT THE AGREEMENT/EASEMENT HAS BEEN OBTAINED SHALL THE CONTRACTOR CONSTRUCT WITHIN THIS AREA. SHOULD THE CONTRACTOR BE REQUIRED TO EXCEED THE CONSTRUCTION LIMITS, THE CONTRACTOR SHALL MODIFY THE CONSTRUCTION LIMITS AS DIRECTED BY THE ENGINEER, IN ORDER TO KEEP WITHIN THE EXISTING RIGHT-OF-WAY.

SIDEWALK AND DRIVEWAY RESTORATION

- ALL EXISTING AND PROPOSED UTILITY AND STORM SEWER STRUCTURE SHALL BE REPAIRED TO ORIGINAL CONDITION. THE CONTRACTOR SHALL BE RESPONSIBLE FOR THE TOP SURFACE OF COVERS OR FRAMES SHALL BE FLUSH WITH THE SIDEWALK OR PAVEMENT SURFACE. ALL EXISTING AND PROPOSED UTILITY AND STORM SEWER STRUCTURE TOPS THAT WILL BE EXPOSED WITHIN UNPAVED AREAS SUBJECT TO VEHICULAR CYCLE, OR PEDESTRIAN TRAFFIC SHALL BE ADJUSTED SO THAT THE TOP SURFACE OF COVERS OR FRAMES SHALL BE NO MORE THAN ONE INCH ABOVE THE FINISHED GRADE. WHERE SODDING IS REQUIRED, THE FINISHED GRADE SHALL BE THE NOMINAL HEIGHT OF GRASS AFTER THE SOD IS FINELY PLACED.
- ANY PRIVATELY OWNED FEATURES LOCATED ON PRIVATE PROPERTY AND OUTSIDE THE DESIGNATED AREA OF CONSTRUCTION DAMAGED AS A RESULT OF CONSTRUCTION ACTIVITIES SHALL BE REPAIRED IN A TIMELY MANNER, AT THE EXPENSE OF THE CONTRACTOR.
- THE CONTRACTOR SHALL DISTURB NO MORE GROUND THAN WHAT IS NECESSARY FOR CONSTRUCTION. NO OPEN EXCAVATED TRENCH, OR OTHER UNSAFE CONDITION, WILL BE LEFT OVERNIGHT. ALL WORK SITES WILL BE COMPLETELY RESTORED WITHIN SEVEN (7) CALENDAR DAYS OF THE CONCRETE POUR FOR SIDEWALK. THE INTENT OF THIS PROVISION IS TO "SAFE UP" THE PROJECT SITE AS WORK PROGRESSES, AND SHALL INCLUDE REMOVING FORMS, FILLING HOLES, GRADING, AND REMOVAL OF DEBRIS.
- SIDEWALK SHALL BE CONSTRUCTED ACCORDING TO FOOT INDEX 310, AND SIDEWALK RAMPS SHALL BE CONSTRUCTED ACCORDING TO FOOT INDEX 304, UNLESS A SEPARATE DETAIL IS PROVIDED. SIDEWALK RAMPS SHALL BE CONSTRUCTED TO A MINIMUM THICKNESS OF SIX (6) INCHES AND SHALL BE REINFORCED WITH EITHER WELDED WIRE FABRIC OR REINFORCING STEEL BARS. CONTRACTORS WILL INSTALL AN EXPANSION JOINT AT EACH END OF A CURB OUT.
- THE CONTRACTOR WILL REQUEST A PRE-FOUR INSPECTION BY THE DESIGNATED COUNTY INSPECTOR. THE CONTRACTOR SHALL NOT POUR ANY SIDEWALK OR SIDEWALK RAMP CONCRETE UNTIL IT PASSES A PRE-FOUR INSPECTION AND COUNTY INSPECTOR APPROVES THAT ALL FOOTING AND CONCRETE WORK IS IN ACCORDANCE WITH ALL APPLICABLE PERMITS AND ORDINANCES WITH CORRESPONDING TO VERIFY THAT ALL FORM WORK IS SUFFICIENT, AND THAT THE SUBGRADE IS CUT TO THE PROPER DEPTH AND COMPACTED PROPERLY. WORK NOT IN

- ACCORDANCE WITH A COUNTY "POST-POUR" INSPECTION MAY REQUIRE THE COMPLETE REMOVAL OF REJECTED WORK OR RESULT IN A REQUIRED PAYMENT OF THE DELIVERABLE. THE PRE-POUR INSPECTION APPROVAL SHALL NOT RELEASE THE CONTRACTOR FROM THE RESPONSIBILITY OF COMPLETING ALL WORK IN ACCORDANCE WITH PLANS AND SPECIFICATIONS OR DIRECTIONS OF THE ENGINEER.
- THE CONTRACTOR SHALL REMOVE AND DISPOSE, IN AREAS PROVIDED BY THE CONTRACTOR, ALL EXCESS CONCRETE BYPRODUCTS (CURB, SIDEWALK, ETC.)
- ALL SIDEWALK DAMAGED BY THE CONTRACTOR OR SUBCONTRACTORS SHALL BE REPLACED AT THE EXPENSE OF THE CONTRACTOR, AT THE DIRECTION OF THE ENGINEER.
- SIDEWALK CURB RAMPS SHALL BE PAID FOR AS DEFINED BY FOOT "DESIGN STANDARDS" INDEX 304 (FROM BACK OF CURB TO THE LANDING, INCLUDING CURB AND TACTILE PAD.)

UTILITIES

- EXCEPT WHERE THE PLANS AND SPECIFICATIONS PROVIDE THAT SUCH WORK SHALL BE PERFORMED UNDER THE CONTRACT FOR THIS PROJECT, ALL UTILITIES INTERFERING WITH CONSTRUCTION SHALL BE REMOVED, RELOCATED, OR ADJUSTED BY THEIR OWNERS, AT THEIR EXPENSE. THE CONTRACTOR SHALL ARRANGE THEIR SCHEDULE TO ALLOW UTILITY OWNERS TIME FOR THE NECESSARY RELOCATION AND ADJUSTMENT OF UTILITIES AND RELATED STRUCTURES. THE OWNERS-HAVING LINES AND FACILITIES ARE INCLUDED BUT NOT LIMITED TO THE FOLLOWING:
DUKE ENERGY
FRONTIER COMMUNICATIONS
KNOLLOGY BROADBAND OF FLORIDA
PINELLAS COUNTY UTILITIES
TECO PEOPLES GAS, ST. PETERSBURG
FLORIDA POWER AND LIGHT COMPANY
FLORIDA COUNTY PROPERTY ENGINEERING
CHARTER COMMUNICATIONS
LEVEL 3 COMMUNICATIONS
UNIT FIBER
- ABOVE GROUND AND/OR UNDERGROUND UTILITIES MAY BE IN THE AREA OF THIS PROJECT - PROCEED WITH CAUTION - THE CONTRACTOR SHALL CALL "SUNSHINE STATE ONE CALL" AND THE UTILITY OWNERS IN ADVANCE OF ANY CONSTRUCTION. THE CONTRACTOR SHALL BE RESPONSIBLE FOR VERIFYING THE STATUS, UNDERGROUND FACILITY DAMAGE PREVENTION & SAFETY. ALL UTILITY OWNERS MAY NOT BE A MEMBER, REQUIRING DIRECT CONTACT. THE CONTRACTOR SHALL FURTHER COORDINATE WITH UTILITY OWNERS TO RESOLVE CONFLICTS THAT MAY ARISE IN THE FIELD DURING CONSTRUCTION. THE CONTRACTOR WILL BE RESPONSIBLE FOR ANY UTILITIES DAMAGED AS A RESULT OF THE CONTRACTOR'S FAILURE TO CALL "SUNSHINE STATE ONE CALL" AND THE UTILITY OWNERS.
- THE CONTRACTOR IS REQUIRED TO COORDINATE AND/OR PROVIDE FOR THE BRACING/SUPPORT OF EXISTING UTILITY POLES WITH THE UTILITY OWNERS, PRIOR TO THE COMMENCEMENT OF EXCAVATION/CONSTRUCTION ACTIVITIES.
- THE CONTRACTOR SHALL PROVIDE TEMPORARY FACILITIES AS REQUIRED TO MAINTAIN WASTEWATER SERVICE THROUGHOUT THE CONSTRUCTION PERIOD. THE CONTRACTOR SHALL PROVIDE TEMPORARY FACILITIES AS REQUIRED TO MAINTAIN WASTEWATER SERVICE THROUGHOUT THE CONSTRUCTION PERIOD. THE CONTRACTOR SHALL PROVIDE TEMPORARY FACILITIES AS REQUIRED TO MAINTAIN WASTEWATER SERVICE THROUGHOUT THE CONSTRUCTION PERIOD. THE CONTRACTOR SHALL PROVIDE TEMPORARY FACILITIES AS REQUIRED TO MAINTAIN WASTEWATER SERVICE THROUGHOUT THE CONSTRUCTION PERIOD.
- ALL EXISTING WATER MAINS, SANITARY SEWER LINES, WATER/SEWER PUMP STATIONS AND OTHER UTILITIES SHALL REMAIN IN SERVICE UNTIL THE RELOCATED UTILITIES ARE PLACED IN SERVICE. THE OWNER OF THESE UTILITIES RELATED CONSTRUCTION ACTIVITIES WITH THE OWNER OF THESE UTILITIES.
- ALL CONSTRUCTION WITHIN THE RIGHT-OF-WAY WILL BE IN ACCORDANCE WITH THE PRACTICES REQUIRED BY PINELLAS COUNTY LAND DEVELOPMENT CODE, CHAPTER 170, ARTICLE V, SECTION 170B-266 TO 170B-276, ALONG WITH THE FOOT UTILITY ACCOMMODATION MANUAL.
- CONTRACTOR WILL NOTIFY THE RESPONSIBLE UTILITY FOR RELOCATION OF METER BOXES FOR DRINKING WATER AND RECLAIMED WATER SERVICES.

DATE:	8/15/19
PROJECT NO.:	2835B
SHEET:	03 OF 05
APPROVED:	DATE:
DESCRIPTION:	UTILITIES
PROJECT:	14 S. FT. HARRISON AVE., CLEARWATER, FL 33756
GENERAL NOTES:	

US Army Corps of Engineers
Tampa Permits Section
Approved by CESALRD-MTKRD
Date: August 15, 2019

REV. NO.	DATE	REV. BY



PROJECT:
SOUTH PASADENA
RECLAIMED WATER MAIN
RELOCATION

PREVENTION, CONTROL, AND ABATEMENT OF EROSION AND WATER POLLUTION

- IT IS THE RESPONSIBILITY OF THE CONTRACTOR TO CONTROL AND PREVENT EROSION AND THE TRANSPORTATION OF SEDIMENT TO SURFACE DRAINS AND DITCHES USING BEST MANAGEMENT PRACTICES. REFER TO CONSTRUCTION BEST MANAGEMENT PRACTICES (BMP) MANUAL FOR BEST MANAGEMENT PRACTICES. SEDIMENT DEPOSITS SHALL BE REMOVED WHEN THEY REACH ONE HALF THE HEIGHT ON AN EROSION DEVICE OR AS DIRECTED BY THE ENGINEER.
- DURING THE CONSTRUCTION OF DRAINAGE STRUCTURES AND OTHER STRUCTURES REQUIRING EXCAVATION, THE CONTRACTOR SHALL PLACE APPROVED BARRIERS OR OTHER APPROVED DEVICES AROUND SUCH STRUCTURES TO PREVENT EROSION AND THE MIGRATION OF SEDIMENT TO ADJACENT AREAS. APPROVED BARRIERS OR OTHER APPROVED DEVICES SHALL BE PLACED IN ACCORDANCE WITH REQUIREMENTS OF FLORIDA STORMWATER EROSION AND SEDIMENTATION CONTROL INSPECTOR'S MANUAL, 2008, STATE OF FLORIDA, EDITION AND PINELLAS COUNTY STANDARD TECHNICAL SPECIFICATIONS FOR EROSION AND SEDIMENTATION CONTROL DEVICES. APPROVED BARRIERS OR OTHER APPROVED DEVICES SHALL BE PLACED AS DIRECTED BY THE ENGINEER.
- REQUIRED EROSION CONTROL MEASURES MUST REMAIN INTACT THROUGHOUT CONSTRUCTION. EROSION CONTROL MEASURES SHALL BE MAINTAINED AND REPAIRED AS REQUIRED. EROSION CONTROL MEASURES, SAND, SILT, AND DEBRIS SHALL BE REMOVED FROM ALL DRAINAGE PIPES AND STRUCTURES AFTER CONSTRUCTION HAS BEEN COMPLETED AND PRIOR TO COUNTY FINAL WALK-THROUGH.
- THE CONTRACTOR SHALL PROVIDE AND MAINTAIN SILT/TURBIDITY BARRIERS TO CONTROL EROSION AND SEDIMENT FROM TRILING PLACE OUTSIDE THE PERMITS FROM THE LOCAL WATER MANAGEMENT DISTRICT OR OTHER REGULATORY AGENCY. APPROVED BARRIERS SHALL BE INSTALLED IN ACCORDANCE WITH REQUIREMENTS OF FLORIDA STORMWATER EROSION AND SEDIMENTATION CONTROL INSPECTOR'S MANUAL, 2008, STATE OF FLORIDA EROSION AND SEDIMENT CONTROL DESIGNER AND REVIEWER MANUAL, LATEST EDITION AND PINELLAS COUNTY STANDARD TECHNICAL SPECIFICATIONS FOR EROSION AND SEDIMENTATION CONTROL DEVICES. APPROVED BARRIERS OR OTHER APPROVED DEVICES SHALL BE REPLACED AT NO ADDITIONAL COST TO THE COUNTY.
- EROSION CONTROL PLAN - ANY MODIFICATIONS TO THIS PLAN MUST BE SIGNED AND SEALED BY A PROFESSIONAL ENGINEER REPRESENTING THE CONTRACTOR. THESE MODIFICATIONS MUST BE APPROVED BY THE COUNTY ENGINEER. CONTRACT DELAYS WILL BE ALLOWED FOR SUCH MODIFICATIONS OR APPROVALS.
- OUTFALL PROTECTION - PROJECT PIPE OR DITCH DISCHARGES INTO EXISTING DRAINAGE SYSTEMS SHALL BE PROTECTED. APPROVED BARRIERS OR OTHER APPROVED DEVICES SHALL BE INSTALLED TO PREVENT EROSION AND SEDIMENT BUILDUP OR TRANSPORT. OUTFALLS SHALL BE PROTECTED THROUGH USE OF EROSION CONTROL FEATURES AS NECESSARY TO CONTAIN ANY SEDIMENT LOSS TO THE IMMEDIATE AREA OF THE PROJECT. ANY EROSION OR SEDIMENTATION SHALL BE IMMEDIATELY STOPPED AND THE CONTRACTOR'S RESPONSIBILITY TO REMEDY. THE CONTRACTOR SHALL USE APPROPRIATE MEASURES TO PREVENT EROSION AND SEDIMENTATION FROM OUTFALL PROTECTION.
- APPROVED BARRIERS (OR OTHER APPROVED SEDIMENT CONTROL DEVICES) - THESE SHALL BE PLACED AT THE BASE OF ANY SLOPE WHERE A RAINFALL EVENT COULD ERODE A SLOPE AND TRANSPORT SEDIMENTS TO ADJACENT AREAS. APPROVED BARRIERS OR OTHER APPROVED DEVICES SHALL BE INSTALLED IN ACCORDANCE WITH FLORIDA STORMWATER EROSION AND SEDIMENTATION CONTROL INSPECTOR'S MANUAL, 2008, AND STATE OF FLORIDA EROSION AND SEDIMENT CONTROL DESIGNER AND REVIEWER MANUAL, LATEST EDITION, ANY EROSION OR SEDIMENTATION SHALL BE IMMEDIATELY STOPPED AND THE CONTRACTOR'S RESPONSIBILITY TO REMEDY. APPROVED BARRIERS OR OTHER APPROVED DEVICES SHALL BE AS DIRECTED BY THE PROJECT ENGINEER.
- BACK OF SPERMALY INLETS OR MESH INLETS - THESE SHALL BE PROTECTED FROM SEDIMENT INTAKE UNTIL PROJECT IS COMPLETE. APPROVED BARRIERS OR OTHER APPROVED DEVICES SHALL BE INSTALLED TO PREVENT EROSION AND SEDIMENT BUILDUP OR TRANSPORT. APPROVED BARRIERS OR OTHER APPROVED DEVICES SHALL BE INSTALLED AROUND INLET TOP WITHOUT EROSION PROTECTION. APPROVED BARRIERS OR OTHER APPROVED DEVICES SHALL BE INSTALLED AROUND APPROXIMATELY 24" OUTSIDE FIRST ROW. BETWEEN ROWS THERE SHALL BE A DEPRESSION TO ACT AS A SEDIMENT BASIN. COMPLETED INLETS IN APPROVED BARRIERS OR OTHER APPROVED SEDIMENT CONTROL DEVICES TO PREVENT SEDIMENT INTAKE FROM OTHER AREAS.
- STOCKPILED MATERIALS SHALL BE PROTECTED BY COVER, APPROVED BARRIERS OR OTHER APPROVED SEDIMENT CONTROL DEVICES.
- ALL DISTURBED AREAS SHALL BE STABILIZED WITHIN 3 DAYS AFTER 2" RAIN EVENT OCCURS.

11. SEDIMENT TRAPPING MEASURES: SEDIMENT BASINS AND TRAPS, PERMETER BERMS, FILTER FENCES, BERMS, SEDIMENT BARRIERS, VEGETATIVE BUFFERS AND OTHER MEASURES INTENDED TO TRAP SEDIMENT AND/OR PREVENT THE TRANSPORT OF SEDIMENT TO ADJACENT AREAS. APPROVED BARRIERS OR OTHER APPROVED DEVICES SHALL BE INSTALLED, CONSTRUCTED OR IN THE CASE OF VEGETATIVE BUFFERS, PROTECTED FROM DISTURBANCE, AS A FIRST STEP IN THE LAND ALTERATION PROCESS.
12. CONTRACTOR IS RESPONSIBLE FOR OBTAINING THE NECESSARY DRAINAGE PERMITS FROM THE LOCAL WATER MANAGEMENT DISTRICT OR OTHER REGULATORY AGENCY.
13. SUBMIT A DRAINAGE PLAN TO THE ENGINEER FOR HIS RECORDS BEFORE BEGINNING CONSTRUCTION.
14. WHERE PUMPS ARE TO BE USED TO REMOVE TURBID WATER FROM THE CONSTRUCTION AREA, THE WATER SHALL BE TREATED TO REDUCE TURBIDITY TO STATE WATER QUALITY STANDARDS PRIOR TO DISCHARGE TO THE WETLANDS. TREATMENT METHODS INCLUDE, FOR EXAMPLE, TURBID WATER BEING PUMPED ON TO A PRESERVATION AREA OR WETLAND BUFFERS, SEDIMENT BASINS, UPLAND PRESERVATION AREAS AND WETLAND BUFFERS. SEDIMENT BASINS, UPLAND PRESERVATION AREAS AND WETLAND BUFFERS SHALL BE CONFORMED BY AN APPROPRIATE ENCLOSURE SUCH AS TURBIDITY BARRIERS, AND KEPT CONFINED UNTIL ITS TURBIDITY LEVEL MEETS STATE WATER QUALITY STANDARDS.
15. IF WIND EROSION BECOMES SIGNIFICANT DURING CONSTRUCTION, THE CONTRACTOR SHALL STABILIZE THE AFFECTED AREA USING SPRINKLING, IRRIGATION, OR OTHER ACCEPTABLE METHODS.
16. WHERE APPLICABLE, SOIL TRACKING PREVENTION DEVICES SHALL BE PROVIDED AND MAINTAINED PER PINELLAS COUNTY EROSION & SEDIMENT CONTROL DETAILS.
17. THE EROSION CONTROL DEVICE QUANTITIES SHOWN ON THE BID FORMS ARE ESTIMATES OF THE ACTUAL QUANTITIES THAT MAY BE ENCOUNTERED DURING CONSTRUCTION. THE CONTRACTOR SHALL SUBMIT A PROPOSED EROSION CONTROL IMPLEMENTATION SCHEDULE. EROSION CONTROL ITEMS MAY BE ADDED OR DELETED FROM THE PAY ITEM LIST AS THE EROSION CONTROL MEASURES ARE DETERMINED BY THE CONTRACTOR IS MODIFIED TO MEET SITE SPECIFIC CONDITIONS.
18. ALL EROSION CONTROL FENCES, BARRIERS, AND SILTATION DEVICES SHALL BE MAINTAINED THROUGHOUT CONSTRUCTION. APPROVED BARRIERS OR OTHER APPROVED DEVICES SHALL BE MAINTAINED AND REPAIRED AS REQUIRED. APPROVED BARRIERS OR OTHER APPROVED DEVICES SHALL BE MAINTAINED AND REPAIRED FOLLOWING SOIL STABILIZATION AND FINAL DRESSING. STOCKPILE AREAS SHALL INCLUDE SILT FENCING AROUND THE PERMETER.
19. THE CONTRACTOR SHALL NOT RESTRICT OR BLOCK THE EXISTING DRAINAGE PIPE OVERLAND OR WITHIN RESHAPED SWALES. FLOW WITHIN EXISTING DRAINAGE PIPES SHALL BE MAINTAINED AT ALL TIMES. STORMWATER WILL BE CONVEYED THROUGH EXISTING DRAINAGE PIPES, OR PROPOSED DITCHES, EXISTING AND PROPOSED STORM SEWERS.
20. THERE IS TO BE NO DISCHARGE (I.E. PUMPING, SHEET FLOW, SWALE, DITCH, ETC.) INTO THE EXISTING DRAINAGE SYSTEMS. APPROVED BARRIERS OR OTHER APPROVED DEVICES SHALL BE INSTALLED TO PREVENT DISCHARGE INTO EXISTING DITCHES OR CANALS IF A SETTLING POND PLAN PREPARED BY THE CONTRACTOR MUST BE SUBMITTED TO AND APPROVED BY THE ENGINEER OF RECORD AND LOCAL REGULATORY AGENCY PRIOR TO CONSTRUCTION.
21. DURING DRAINAGE OPERATIONS, THE CONTRACTOR SHALL NOT DISCHARGE DIRECTLY TO RECEIVING WATERS. EXISTING CONVEYANCES TO RECEIVING WATERS SHALL BE MAINTAINED THROUGHOUT CONSTRUCTION. APPROVED BARRIERS OR OTHER APPROVED DEVICES SHALL BE UTILIZED TO COLLECT THE DISCHARGE FROM DRAINAGE ACTIVITIES TO ELIMINATE THE POTENTIAL FOR OFF-SITE SEDIMENT TRANSPORT AND TO INSURE THAT DIRECT DISCHARGE DOES NOT OCCUR.
22. BANKS SHALL BE PROTECTED FROM EROSION OR COLLAPSE DURING CONSTRUCTION. BANK PROTECTION MATERIAL SHALL BE CAREFULLY PLACED TO PREVENT EROSION OR COLLAPSE. APPROVED BARRIERS OR OTHER APPROVED DEVICES SHALL BE INSTALLED TO PREVENT EROSION OR COLLAPSE. APPROVED BARRIERS OR OTHER APPROVED DEVICES SHALL BE INSTALLED TO PROTECT THE BANKS UNLESS OTHERWISE SPECIFIED IN THE PLANS. UPON COMPLETION OF CONSTRUCTION, APPROVED BARRIERS OR OTHER APPROVED DEVICES SHALL BE RESTORED TO THEIR PRE-CONSTRUCTION CONFIGURATION AND PROTECTED FROM EROSION.
23. THE CONTRACTOR SHALL BE RESPONSIBLE FOR PROTECTING POND FILTRATION SYSTEMS FROM BEING CLOGGED UNTIL PINELLAS COUNTY DETERMINES THE CONSTRUCTION IS COMPLETE. IF FILTER MATERIAL IS CONTAMINATED, IT SHALL BE REPLACED AT THE EXPENSE OF THE CONTRACTOR.

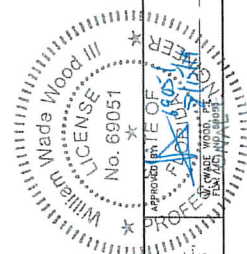

DATE: 8/15/19
PROJECT NO.: 2935B
SHEET: 04 OF 09

UTILITIES
14 S. FT. HARRISON AVE.,
CLEARWATER, FL 33756

GENERAL NOTES

DESCRIPTION:
SOUTH PASADENA
RECLAIMED WATER MAIN
RELOCATION



WTFW	DESIGNED	BY	DATE
	BD		
	CHK		
	APP		

US Army Corps of Engineers
Tampa Permits Section
Reviewed by: GESA LBP-WTK/RD
Date: August 15, 2019

REV.	NO.	DATE	DESCRIPTION	REV. BY

SAJ-2019-02720 - ENCLOSURE 1

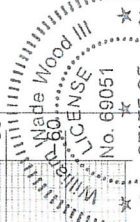
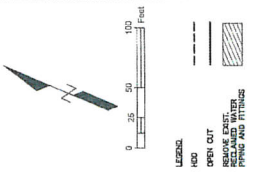
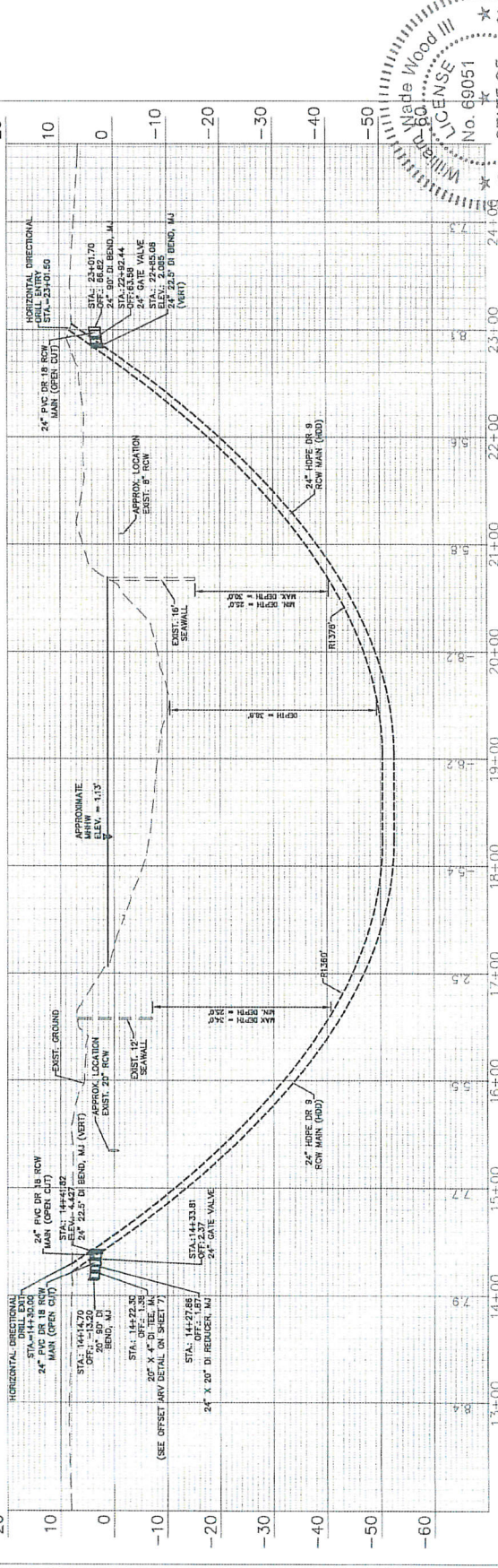
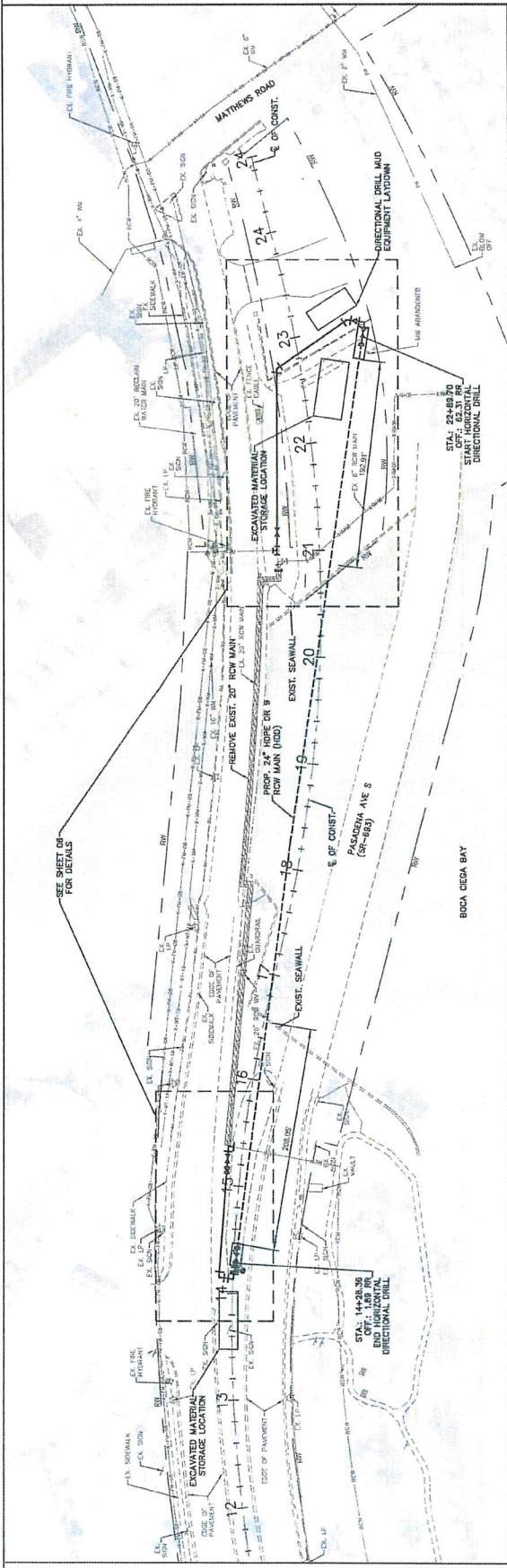

DATE:	8/15/19
PROJECT NO.:	29356B
DATE:	8/15/19
SHEET:	05 OF 09
PROJECT:	UTILITIES
DESCRIPTION:	14 S. FT. HARRISON AVE., CLEARWATER, FL 33756
PROJECT:	SOUTH PASADENA RECLAIMED WATER MAIN RELOCATION
PLAN & PROFILE	
US Army Corps of Engineers Tampa Permits Section Received by CESAJ-RD-WT/KRD	
DATE:	August 15, 2019

SAJ-2019-02720 - ENCLOSURE 1

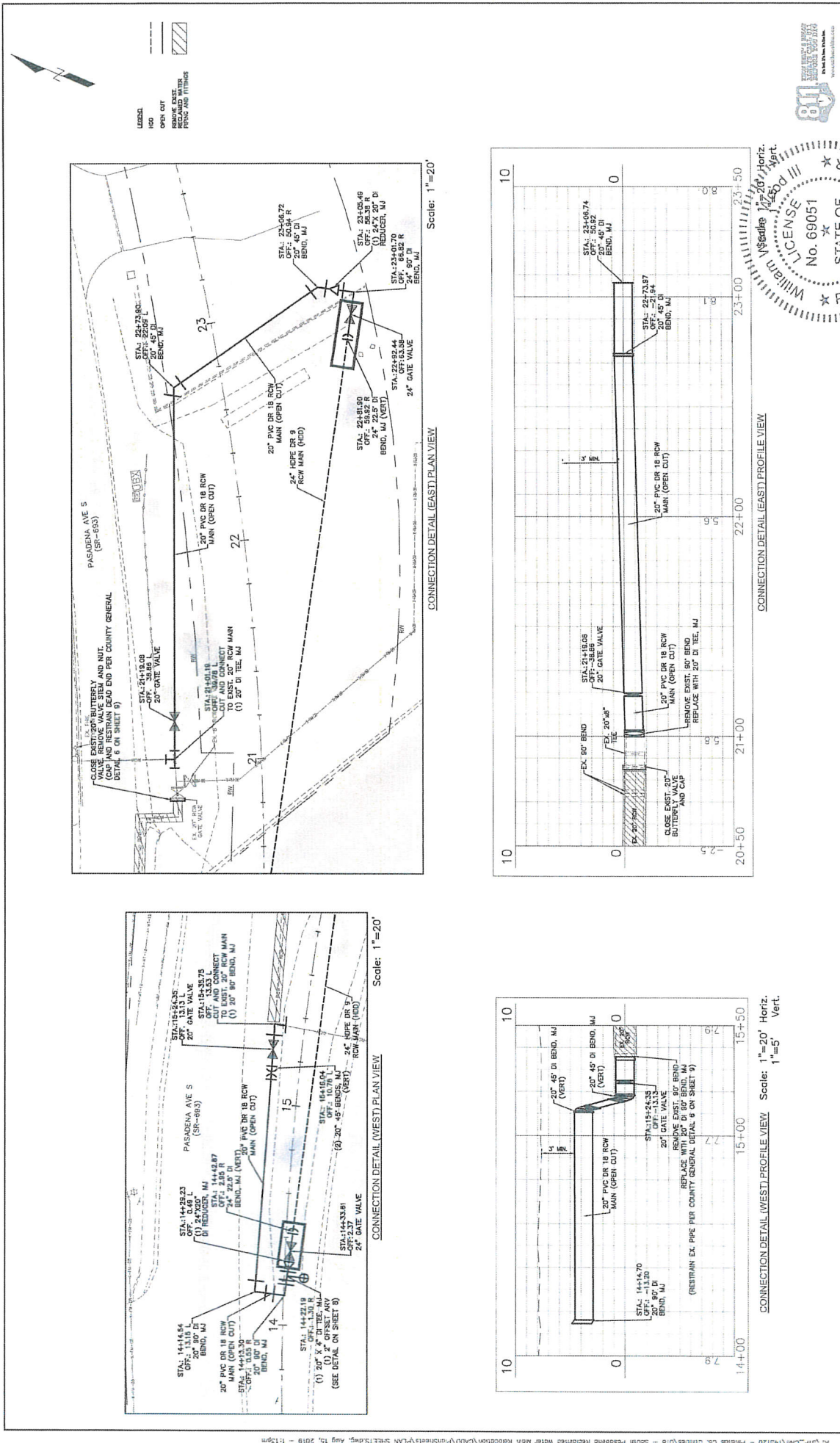

DATE	8/15/19
PROJECT NO.	2936B
SHEET	06 OF 09
DATE	
DESCRIPTION:	UTILITIES
PROJECT:	SOUTH PASADENA RECLAIMED WATER MAIN RELOCATION
CONNECTION DETAILS	14 S. FT. HARRISON AVE., CLEARWATER, FL 33756
 PINELLAS COUNTY FLORIDA	
W/REV DESIGNED CHECKED DRAWN EDD REG REV. BY OVERLAD	
US Army Corps of Engineers Tampa Permits Section Received by CFSAL-RD-WTKRD Date: August 15, 2019	

NOTE: MATERIALS SHALL BE IN ACCORDANCE WITH THE LATEST F.C.C. APPROVED MATERIAL SPECIFICATION MANUAL. ALL MATERIALS SHALL BE APPROVED BY THE LATEST F.C.C. APPROVED MATERIAL SPECIFICATION MANUAL.

- ALL MATERIALS SHALL BE IN ACCORDANCE WITH THE LATEST F.C.C. APPROVED MATERIAL SPECIFICATION MANUAL.
- ALL MATERIALS SHALL BE APPROVED BY THE LATEST F.C.C. APPROVED MATERIAL SPECIFICATION MANUAL.
- ALL MATERIALS SHALL BE APPROVED BY THE LATEST F.C.C. APPROVED MATERIAL SPECIFICATION MANUAL.
- ALL MATERIALS SHALL BE APPROVED BY THE LATEST F.C.C. APPROVED MATERIAL SPECIFICATION MANUAL.
- ALL MATERIALS SHALL BE APPROVED BY THE LATEST F.C.C. APPROVED MATERIAL SPECIFICATION MANUAL.
- ALL MATERIALS SHALL BE APPROVED BY THE LATEST F.C.C. APPROVED MATERIAL SPECIFICATION MANUAL.

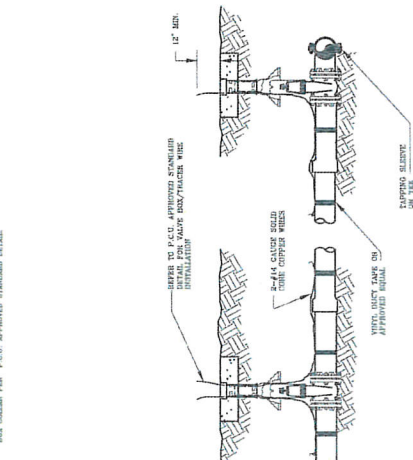

PINELLAS COUNTY
TRACER WIRE INSTALLATION
DETAIL

DATE: FEB/2016
DRAWN BY: J.C.K.

NOTE: MATERIALS SHALL BE IN ACCORDANCE WITH THE LATEST F.C.C. APPROVED MATERIAL SPECIFICATION MANUAL. ALL MATERIALS SHALL BE APPROVED BY THE LATEST F.C.C. APPROVED MATERIAL SPECIFICATION MANUAL.

- ALL MATERIALS SHALL BE IN ACCORDANCE WITH THE LATEST F.C.C. APPROVED MATERIAL SPECIFICATION MANUAL.
- ALL MATERIALS SHALL BE APPROVED BY THE LATEST F.C.C. APPROVED MATERIAL SPECIFICATION MANUAL.
- ALL MATERIALS SHALL BE APPROVED BY THE LATEST F.C.C. APPROVED MATERIAL SPECIFICATION MANUAL.
- ALL MATERIALS SHALL BE APPROVED BY THE LATEST F.C.C. APPROVED MATERIAL SPECIFICATION MANUAL.
- ALL MATERIALS SHALL BE APPROVED BY THE LATEST F.C.C. APPROVED MATERIAL SPECIFICATION MANUAL.
- ALL MATERIALS SHALL BE APPROVED BY THE LATEST F.C.C. APPROVED MATERIAL SPECIFICATION MANUAL.

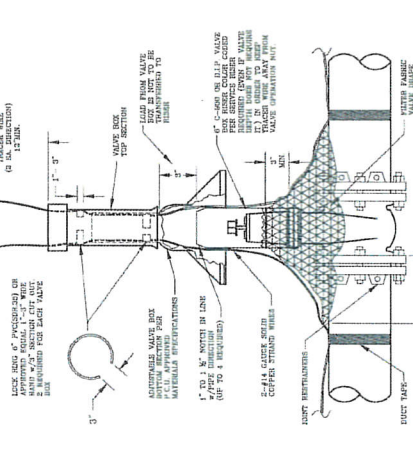

PINELLAS COUNTY
VALVE BON/TRACER WIRE INSTALLATION
DETAIL

DATE: FEB/2016
DRAWN BY: J.C.K.

NOTE: MATERIALS SHALL BE IN ACCORDANCE WITH THE LATEST F.C.C. APPROVED MATERIAL SPECIFICATION MANUAL. ALL MATERIALS SHALL BE APPROVED BY THE LATEST F.C.C. APPROVED MATERIAL SPECIFICATION MANUAL.

- ALL MATERIALS SHALL BE IN ACCORDANCE WITH THE LATEST F.C.C. APPROVED MATERIAL SPECIFICATION MANUAL.
- ALL MATERIALS SHALL BE APPROVED BY THE LATEST F.C.C. APPROVED MATERIAL SPECIFICATION MANUAL.
- ALL MATERIALS SHALL BE APPROVED BY THE LATEST F.C.C. APPROVED MATERIAL SPECIFICATION MANUAL.
- ALL MATERIALS SHALL BE APPROVED BY THE LATEST F.C.C. APPROVED MATERIAL SPECIFICATION MANUAL.
- ALL MATERIALS SHALL BE APPROVED BY THE LATEST F.C.C. APPROVED MATERIAL SPECIFICATION MANUAL.
- ALL MATERIALS SHALL BE APPROVED BY THE LATEST F.C.C. APPROVED MATERIAL SPECIFICATION MANUAL.

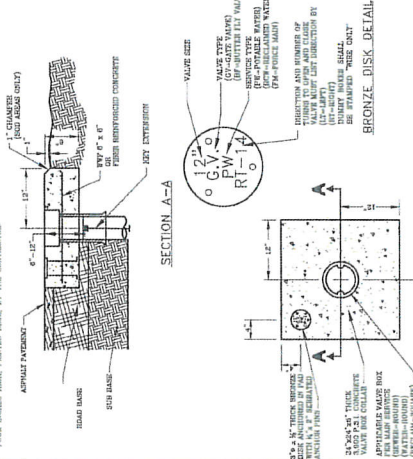

PINELLAS COUNTY
CONCRETE VALVE BOX AND COLLAR
DETAIL

DATE: FEB/2016
DRAWN BY: J.C.K.

NOTE: MATERIALS SHALL BE IN ACCORDANCE WITH THE LATEST F.C.C. APPROVED MATERIAL SPECIFICATION MANUAL. ALL MATERIALS SHALL BE APPROVED BY THE LATEST F.C.C. APPROVED MATERIAL SPECIFICATION MANUAL.

- ALL MATERIALS SHALL BE IN ACCORDANCE WITH THE LATEST F.C.C. APPROVED MATERIAL SPECIFICATION MANUAL.
- ALL MATERIALS SHALL BE APPROVED BY THE LATEST F.C.C. APPROVED MATERIAL SPECIFICATION MANUAL.
- ALL MATERIALS SHALL BE APPROVED BY THE LATEST F.C.C. APPROVED MATERIAL SPECIFICATION MANUAL.
- ALL MATERIALS SHALL BE APPROVED BY THE LATEST F.C.C. APPROVED MATERIAL SPECIFICATION MANUAL.
- ALL MATERIALS SHALL BE APPROVED BY THE LATEST F.C.C. APPROVED MATERIAL SPECIFICATION MANUAL.
- ALL MATERIALS SHALL BE APPROVED BY THE LATEST F.C.C. APPROVED MATERIAL SPECIFICATION MANUAL.

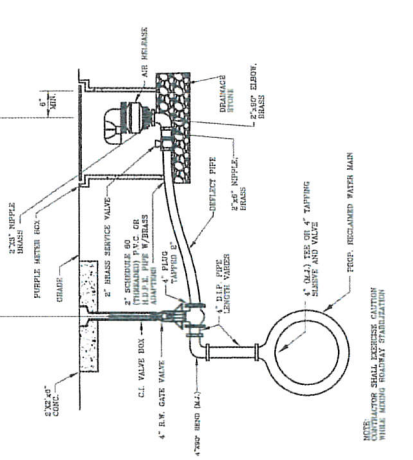

PINELLAS COUNTY
2\"/>
 OFFSET AIR RELEASE ASSEMBLY FOR RECLAIMED
WATER (BELOW GROUND) DETAIL

DATE: FEB/2016
DRAWN BY: J.C.K.

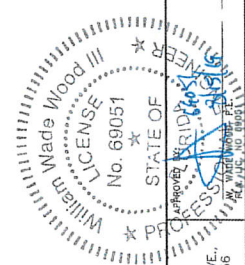

PROJECT:	UTILITIES	DATE:	8/15/2019
PROJECT:	14 S. FT. HARRISON AVE., CLEARWATER, FL 33736	PROJECT NO.:	2935B
DESCRIPTION:	DETAILS	SHEET:	07 OF 09
PROJECT:	SOUTH PASADENA RECLAIMED WATER MAIN RELOCATION	DATE:	
RESERVED:	WWW		
	BDD		
DRAWN BY:	REC		
CHECKED BY:			
REV. BY:			

US Army Corps of Engineers
Tampa Permit Section
Reviewed by: CESAJLRD-WTKRD
Date: August 15, 2019

NOTE: THIS PLAN LAYER SHALL COMPLY WITH SECTION 106 OF FLORIDA STANDARD SPECIFICATIONS FOR ROAD AND BRIDGE CONSTRUCTION. CURRENT EDITION.

1. ROAD AND BRIDGE CONSTRUCTION. CURRENT EDITION.
2. ROAD AND BRIDGE CONSTRUCTION. CURRENT EDITION.
3. ROAD AND BRIDGE CONSTRUCTION. CURRENT EDITION.
4. ROAD AND BRIDGE CONSTRUCTION. CURRENT EDITION.

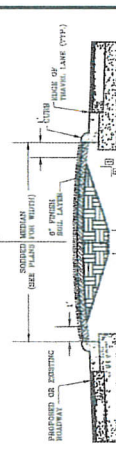
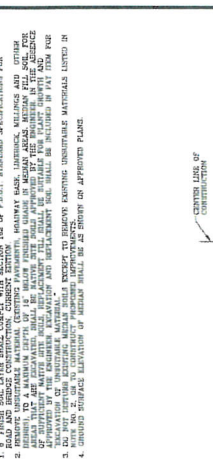

SEE NOTES TO J AND B
TYPICAL SECTION

DATE: 8/15/2019
PROJECT NO.: 29356B
SHEET: 08 OF 09

PINELLAS COUNTY
MEDIAN SOIL COMPOSITION AND DEPTH

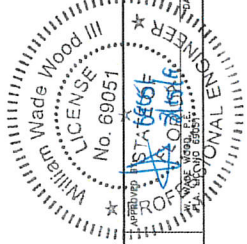

NOTE: MATERIALS SHALL BE IN ACCORDANCE WITH THE LATEST P.C.U. APPROVED MATERIAL SPECIFICATION

1. MATERIALS SHALL BE IN ACCORDANCE WITH THE LATEST P.C.U. APPROVED MATERIAL SPECIFICATION
2. MATERIALS SHALL BE IN ACCORDANCE WITH THE LATEST P.C.U. APPROVED MATERIAL SPECIFICATION
3. MATERIALS SHALL BE IN ACCORDANCE WITH THE LATEST P.C.U. APPROVED MATERIAL SPECIFICATION
4. MATERIALS SHALL BE IN ACCORDANCE WITH THE LATEST P.C.U. APPROVED MATERIAL SPECIFICATION



PIPE SIZE	FITTINGS		1/4\"/>
	REDUCERS	LARGER PIPE	
2"	1.00	1.00	1.00
3"	1.25	1.25	1.25
4"	1.50	1.50	1.50
6"	2.00	2.00	2.00
8"	2.50	2.50	2.50
10"	3.00	3.00	3.00
12"	3.50	3.50	3.50
14"	4.00	4.00	4.00
16"	4.50	4.50	4.50
18"	5.00	5.00	5.00
20"	5.50	5.50	5.50
24"	6.50	6.50	6.50
30"	8.00	8.00	8.00
36"	9.50	9.50	9.50

DATE: FEB/2016
PROJECT NO.: 29356B
SHEET: 08 OF 09

PINELLAS COUNTY
PRESSURE MAIN RESTRAINED JOINT DETAIL

NOTE: MATERIALS SHALL BE IN ACCORDANCE WITH THE LATEST P.C.U. APPROVED MATERIAL SPECIFICATION

1. MATERIALS SHALL BE IN ACCORDANCE WITH THE LATEST P.C.U. APPROVED MATERIAL SPECIFICATION
2. MATERIALS SHALL BE IN ACCORDANCE WITH THE LATEST P.C.U. APPROVED MATERIAL SPECIFICATION
3. MATERIALS SHALL BE IN ACCORDANCE WITH THE LATEST P.C.U. APPROVED MATERIAL SPECIFICATION
4. MATERIALS SHALL BE IN ACCORDANCE WITH THE LATEST P.C.U. APPROVED MATERIAL SPECIFICATION

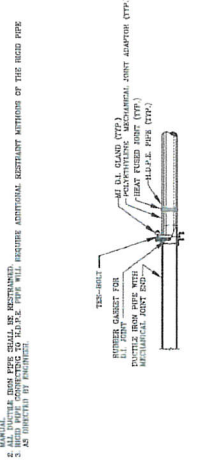

PIPE SIZE	FITTINGS		1/4\"/>
	REDUCERS	LARGER PIPE	
2"	1.00	1.00	1.00
3"	1.25	1.25	1.25
4"	1.50	1.50	1.50
6"	2.00	2.00	2.00
8"	2.50	2.50	2.50
10"	3.00	3.00	3.00
12"	3.50	3.50	3.50
14"	4.00	4.00	4.00
16"	4.50	4.50	4.50
18"	5.00	5.00	5.00
20"	5.50	5.50	5.50
24"	6.50	6.50	6.50
30"	8.00	8.00	8.00
36"	9.50	9.50	9.50

DATE: FEB/2016
PROJECT NO.: 29356B
SHEET: 08 OF 09

PINELLAS COUNTY
FLUSTIBLE PVC/HDRPE PIPE CONNECTIONS DETAIL

NOTE: MATERIALS SHALL BE IN ACCORDANCE WITH THE LATEST P.C.U. APPROVED MATERIAL SPECIFICATION

1. MATERIALS SHALL BE IN ACCORDANCE WITH THE LATEST P.C.U. APPROVED MATERIAL SPECIFICATION
2. MATERIALS SHALL BE IN ACCORDANCE WITH THE LATEST P.C.U. APPROVED MATERIAL SPECIFICATION
3. MATERIALS SHALL BE IN ACCORDANCE WITH THE LATEST P.C.U. APPROVED MATERIAL SPECIFICATION
4. MATERIALS SHALL BE IN ACCORDANCE WITH THE LATEST P.C.U. APPROVED MATERIAL SPECIFICATION

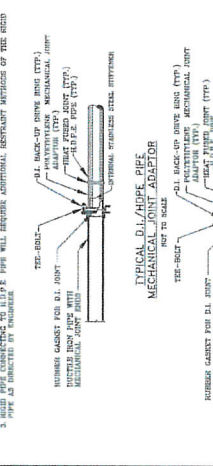

PIPE SIZE	FITTINGS		1/4\"/>
	REDUCERS	LARGER PIPE	
2"	1.00	1.00	1.00
3"	1.25	1.25	1.25
4"	1.50	1.50	1.50
6"	2.00	2.00	2.00
8"	2.50	2.50	2.50
10"	3.00	3.00	3.00
12"	3.50	3.50	3.50
14"	4.00	4.00	4.00
16"	4.50	4.50	4.50
18"	5.00	5.00	5.00
20"	5.50	5.50	5.50
24"	6.50	6.50	6.50
30"	8.00	8.00	8.00
36"	9.50	9.50	9.50

DATE: FEB/2016
PROJECT NO.: 29356B
SHEET: 08 OF 09

PINELLAS COUNTY
FLUSTIBLE PVC/HDRPE PIPE CONNECTIONS DETAIL

REV. NO. DATE

US Army Corps of Engineers
Tampa Permits Section
Reviewed by: CESALBD-WTKRD
Date: August 15, 2019

PROJECT: SOUTH PASADENA RECLAIMED WATER MAIN RELOCATION

DESCRIPTION: UTILITIES

14 S. FT. HARRISON AVE., CLEARWATER, FL 33756

DATE: 8/15/2019
PROJECT NO.: 29356B
SHEET: 08 OF 09

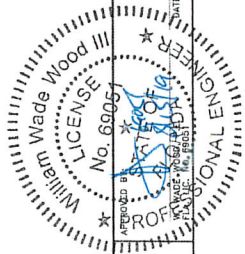
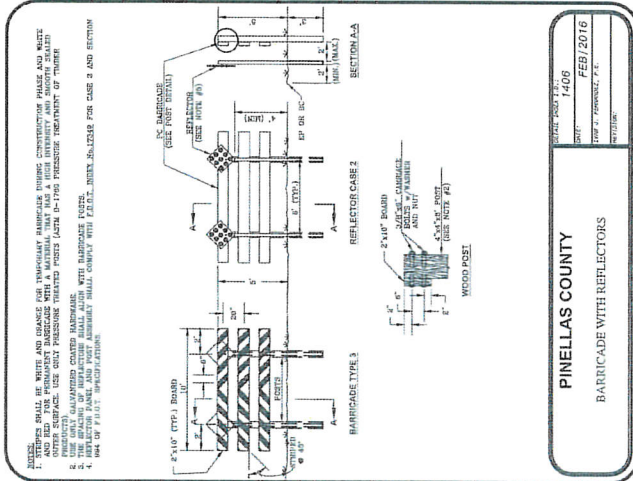
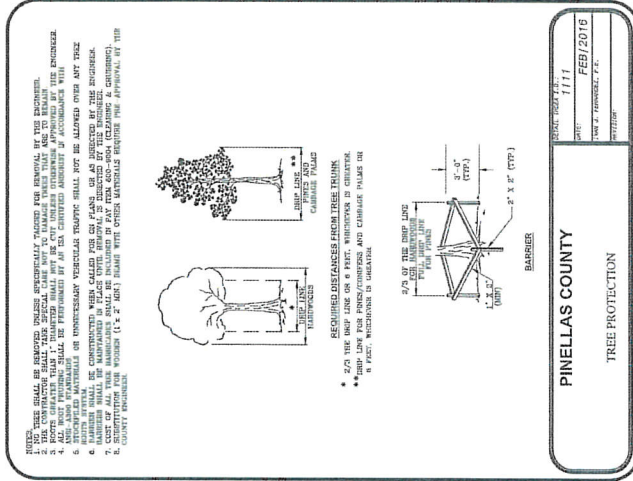
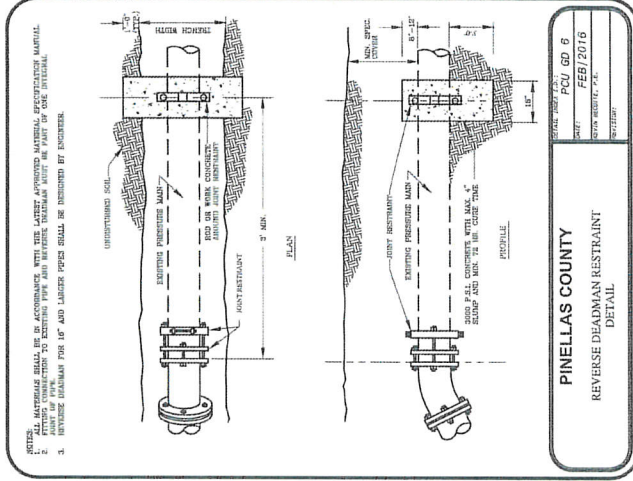

DATE: 8/15/2019
 PROJECT NO. 2835B
 SHEET: 09 OF 09

APPROVED BY: [Signature]
 PROJECT: UTILITIES
 14 S. FT. HARRISON AVE.,
 CLEARWATER, FL 33756

DESCRIPTION:
 SOUTH PASADENA RECLAIMED
 WATER MAIN RELOCATION



REV. NO. DATE
 1408 FEB 2016
 1409 FEB 2016
 1410 FEB 2016

US Army Corps of Engineers
 Tampa Permits Section
 Approved by CESAJ-RD-WJK/RD
 Date: August 15, 2019

EXHIBIT B

South Pasadena, St Pete Beach, & Tierra Verde Reclaimed Water

10YR Flow Averages (%)

YEAR	S.Pas*	SPB	TV (PC)
FY11/12	13.00	51.50	35.50
FY12/13	13.00	48.72	38.28
FY13/14	13.00	44.20	42.80
FY14/15	13.00	46.95	40.05
FY15/16	13.00	49.07	37.94
FY16/17	13.00	58.96	28.04
FY17/18	13.00	59.32	27.68
FY18/19	13.00	60.87	26.14
FY19/20	13.00	58.99	28.01
FY20/21	13.00	59.70	27.30
FY21/22**	13.00	59.61	27.39
Avg.Flow	13.00	54.35	32.648

* S.Pas calculated at 15% Total Flow to SPB & TV

** Partial Data

\$277,849.26

\$1,161,623.64

\$697,829.10

Total Project Cost
= \$2,137,302

South Pasadena, St Pete Beach, & Tierra Verde Reclaimed Water

FY20 (Revised)			
MONTH	S. Pasadena* Flow per MG	St. Pete Bch Flow per MG	Tierra Verde Flow per MG
Oct-20	19.58	89.09	41.46
Nov-20	18.81	86.01	39.40
Dec-20	16.79	76.40	35.54
Jan-21	11.68	53.32	24.55
Feb-21	13.68	62.75	28.45
Mar-21	18.82	84.68	40.80
Apr-21	17.24	78.32	36.60
May-21	18.66	84.35	40.05
Jun-21	22.41	103.78	45.65
Jul-21	19.31	88.16	40.57
Aug-21	19.86	94.24	38.00
Sep-21	17.83	81.20	37.67
Total	214.68	982.30	448.74
MGD	0.588	2.691	1.229

FY15 (Original)			
MONTH	S. Pasadena* Flow per MG	St. Pete Bch Flow per MG	Tierra Verde Flow per MG
Oct-14	15.79	51.51	53.77
Nov-14	13.40	45.09	44.25
Dec-14	15.90	50.64	55.37
Jan-15	12.09	37.05	43.53
Feb-15	11.91	42.49	36.89
Mar-15	17.18	65.85	48.71
Apr-15	17.57	68.39	48.75
May-15	16.09	61.54	45.70
Jun-15	18.46	72.28	50.80
Jul-15	18.59	73.47	50.44
Aug-15	18.47	71.48	51.67
Sep-15	17.69	67.55	50.35
Total	193.14	707.34	580.23
MGD	0.529	1.938	1.590

Transmission Main Percentages			
Amendment No. 1 of Agreement (1993)**	30.6%	52.1%	17.3%
Based on Actual Flows (FY 2020)	13.0%	59.7%	27.3%

Transmission Main Percentages			
Amendment No. 1 of Agreement (1993)**	30.6%	52.1%	17.3%
Based on Actual Flows (FY 2015)	13.0%	47.8%	39.2%

St. Pete Beach Trunk Percentages			
Agreement (1991)		75%	25%
Based on Actual Flows (FY 2020)***		69%	31%

St. Pete Beach Trunk Percentages			
Agreement (1991)		75%	25%
Based on Actual Flows (FY 2015)***		55%	45%

*Reclaimed Water to South Pasadena is based on 15% of the metered flow to St. Pete Beach

**Percentages from "First Amendment to Reclaimed Water Services Agreement..." dated April 6, 1993, Section 1, page 2 of 3, filename "040693 Increase Pipeline Size"

*** Percentages derived from "Reclaimed Water Service Agreement..." dated September 24, 1991, Section 2B, page 3, filename "City of St Pete Bch, City of South Pasadena 092491"

** "First Amendment to Reclaimed Water Services Agreement..." dated April 6, 1993, Section 1, page 2 of 3, filename "040693 Increase Pipeline Size"

NOW, THEREFORE, the parties hereto agree:

1. With regard to the cost sharing on the transmission main Paragraph 2A shall be modified to add the following:

The percentages listed below shall be applied to the total construction cost and first year maintenance of the transmission main from Sixth Avenue North through South Pasadena to as bus stop including the valve on the South Pasadena side of the Intracoastal Waterway.

St. Petersburg Beach	-	\$1.14
South Pasadena	-	\$0.54
County (Tierra Verde)	-	\$7.39

*** "Reclaimed Water Services Agreement..." dated September 24, 1991, Section 2B, page 3, filename "City of St Pete Bch, City of South Pasadena 092491"

2. A. St. Petersburg Beach shall have primary responsibility for the design, construction and maintenance of the Transmission System. The County, St. Petersburg Beach and South Pasadena shall share ownership as tenants in common and share the costs for planning, design, construction, operations, maintenance and renewals and replacement of the Transmission System on the basis of their respective system capacity commitments. The Transmission System capacity commitments shall be: County = 500,000 gallons per day; St. Petersburg Beach = 1,500,000 gallons per day; South Pasadena = 500,000 gallons per day.

B. St. Petersburg Beach shall own and have primary responsibility for the design, construction and maintenance of the St. Petersburg Beach Trunk. The County and St. Petersburg Beach shall share the costs for planning, design, construction, operations, maintenance and renewals and replacement of the St. Petersburg Beach Trunk on the basis of their respective capacity commitments. The St. Petersburg Beach Trunk capacity commitments shall be: County = 500,000 gallons per day; St. Petersburg Beach = 1,500,000 gallons per day.

WHOLESALE REUSE FLOW READINGS
FY 2021/2022

		SPB 570 MTR#14886385	TIERRA VERDE MTR# 07W017045	BILLING
OCT 21	10/29	1774163	1603423	125.79
	9/30	<u>1648364</u>	<u>1563025</u>	<u>-40.39</u>
		125799	40398	85.40
NOV 21	11/30	1907185	1645714	133.02
	10/29	<u>1774163</u>	<u>1603423</u>	<u>-42.29</u>
		133022	42291	90.73
DEC 21	12/30	0	1683373	119.51
	11/30	<u>1907185</u>	<u>1645714</u>	<u>-37.65</u>
	Annual avg due to totalizer issue. Reset to zero 1/7/22.*	119510	37659	81.86
JAN 22	1/31	85667	1720134	120.14
	12/30	<u>0</u>	<u>1683373</u>	<u>-36.76</u>
	Annual avg due to totalizer issue. Reset to zero 1/7/22.*	120141	36761	83.38
FEB 22	2/28			
	1/31	<u> </u>	<u> </u>	<u>-</u>
				0.00
MAR 22	3/31			
	2/28	<u> </u>	<u> </u>	<u>-</u>
				0.00
APR 22	4/29			
	3/31	<u> </u>	<u> </u>	<u>-</u>
				0.00
MAY 22	5/31			
	4/29	<u> </u>	<u> </u>	<u>-</u>
				0.00
JUN 22	6/30			
	5/31	<u> </u>	<u> </u>	<u>-</u>
				0.00
JUL 22	7/29			
	6/30	<u> </u>	<u> </u>	<u>-</u>
				0.00
AUG 22	8/31			
	7/29	<u> </u>	<u> </u>	<u>-</u>
				0.00
SEP 22	9/30			
	8/31	<u> </u>	<u> </u>	<u>-</u>
				0.00

WHOLESALE REUSE FLOW READINGS
FY 2020/2021

		SPB 570		TIERRA VERDE		BILLING
		MTR#14886385		MTR# 07W017045		
OCT 20	10/30	347645		1162109		130.55
	9/30	<u>217090</u>		<u>1120649</u>		<u>-41.46</u>
		130555		41460		89.09
NOV 20	11/30	473063		1201509		125.41
	10/30	<u>347645</u>		<u>1162109</u>		<u>-39.40</u>
		125418		39400		86.01
DEC 20	12/31	585008		1237050		111.94
	11/30	<u>473063</u>		<u>1201509</u>		<u>-35.54</u>
		111945		35541		76.40
JAN 21	1/29	662878		1261600		77.87
	12/31	<u>585008</u>		<u>1237050</u>		<u>-24.55</u>
	Shut off & line break.*	77870		24550		53.32
FEB 21	2/26	754083		1290050		91.20
	1/29	<u>662878</u>		<u>1261600</u>		<u>-28.45</u>
		91205		28450		62.75
MAR 21	3/31	879564		1330851		125.48
	2/26	<u>754083</u>		<u>1290050</u>		<u>-40.80</u>
		125481		40801		84.68
APR 21	4/30	994485		1367451		114.92
	3/31	<u>879564</u>		<u>1330851</u>		<u>-36.60</u>
		114921		36600		78.32
MAY 21	5/31	1118890		1407507		124.40
	4/30	<u>994485</u>		<u>1367451</u>		<u>-40.05</u>
		124405		40056		84.35
JUN 21	6/30	1268324		1453161		149.43
	5/31	<u>1118890</u>		<u>1407507</u>		<u>-45.65</u>
		149434		45654		103.78
JUL 21	7/30	1397060		1493738		128.73
	6/30	<u>1268324</u>		<u>1453161</u>		<u>-40.57</u>
		128736		40577		88.16
AUG 21	8/31	1529490		1525353		132.24
	7/30	<u>1397060</u>		<u>1493738</u>		<u>-38.00</u>
		132430	Annual avg due to power loss.*	38002		94.24
SEP 21	9/30	1648364		1563025		118.87
	8/31	<u>1529490</u>		<u>1525353</u>		<u>-37.67</u>
		118874		37672		81.20

WHOLESALE REUSE FLOW READINGS
FY 2019/2020

		SPB 570 MTR#14886385	TIERRA VERDE MTR# 07W017045	BILLING
SEP 19	9/30	748662	632809	142.92
	8/31	<u>605738</u>	<u>586492</u>	<u>-46.31</u>
		142924	46317	96.61
OCT 19	10/31	895237	679533	146.57
	9/30	<u>748662</u>	<u>632809</u>	<u>-46.72</u>
		146575	46724	99.85
NOV 19	11/29	1016378	718518	121.14
	10/31	<u>895237</u>	<u>679533</u>	<u>-38.98</u>
		121141	38985	82.16
DEC 19	12/31	1133401	757056	117.02
	11/29	<u>1016378</u>	<u>718518</u>	<u>-38.53</u>
		117023	38538	78.49
JAN 20	1/31	1246562	795220	113.16
	12/31	<u>1133401</u>	<u>757056</u>	<u>-38.16</u>
		113161	38164	75.00
FEB 20	2/28	1348457	829639	101.89
	1/31	<u>1246562</u>	<u>795220</u>	<u>-34.41</u>
		101895	34419	67.48
MAR 20	3/31	1481163	873314	132.70
	2/28	<u>1348457</u>	<u>829639</u>	<u>-43.67</u>
		132706	43675	89.03
APR 20	4/30	1608307	913066	127.14
	3/31	<u>1481163</u>	<u>873314</u>	<u>-39.75</u>
		127144	39752	87.39
MAY 20	5/29	1737110	954524	128.80
	4/30	<u>1608307</u>	<u>913066</u>	<u>-41.45</u>
		128803	41458	87.35
JUN 20	6/30	1878333	1000248	141.22
	5/29	<u>1737110</u>	<u>954524</u>	<u>-45.72</u>
		141223	45724	95.50
JUL 20	7/31	2001000	1037715	127.70
	6/30	<u>1878333</u>	<u>1000248</u>	<u>-37.46</u>
	Annual avg due to mtr reset 8/11/20.*	127709	37467	90.24
AUG 20	8/31	92698	1081692	126.43
	7/31	<u>2001000</u>	<u>1037715</u>	<u>-43.97</u>
	Annual avg due to mtr reset 8/11/20.*	126439	43977	82.46
SEP 20	9/30	217090	1120649	124.39
	8/31	<u>92698</u>	<u>1081692</u>	<u>-38.95</u>
		124392	38957	85.44

WHOLESALE REUSE FLOW READINGS
FY 2018/2019

		SPB 570	TIERRA VERDE	BILLING
		MTR#14886385	MTR# 07W017045	
		<i>* Meter change 04/09/19, old # 1664054</i>	<i>* Meter change 10/05/18, old # 3K6256026.</i>	
OCT 18	10/31	5625855	217759	
			180875	
			5634001	136.78
	9/28	<u>5489072</u>	<u>5628164</u>	<u>-42.72</u>
		136783	42721	94.06
NOV 18	11/30	5754524	259762	128.66
	10/31	<u>5625855</u>	<u>217759</u>	<u>-42.00</u>
		128669	42003	86.66
DEC 18	12/28	5843730	287109	89.20
	11/30	<u>5754524</u>	<u>259762</u>	<u>-27.34</u>
		89206	27347	61.86
JAN 19	1/31	5904465	323237	124.81
	12/28	<u>5843730</u>	<u>287109</u>	<u>-36.12</u>
	<i>Annual avg due to mtr malf*</i>	124813	36128	88.69
FEB 19	2/28	5993892	352848	124.98
	1/31	<u>5904465</u>	<u>323237</u>	<u>-29.61</u>
	<i>Annual avg due to mtr malf*</i>	124982	29611	95.37
MAR 19	3/31	6055506	382580	126.32
	2/28	<u>5993892</u>	<u>352848</u>	<u>-29.73</u>
	<i>Annual avg due to mtr malf*</i>	126324	29732	96.59
APR 19	4/30	83113	426059	126.29
	3/31	<u>6055506</u>	<u>382580</u>	<u>-43.47</u>
	<i>Annual avg, final read not avail*</i>	126291	43479	82.82
	<i>04/09 #14886385 read @ 0.</i>			
MAY 19	5/31	216752	465088	133.63
	4/30	<u>83113</u>	<u>426059</u>	<u>-39.02</u>
		133639	39029	94.61
JUN 19	6/30	345822	504849	129.07
	5/31	<u>216752</u>	<u>465088</u>	<u>-39.76</u>
		129070	39761	89.31
JUL 19	7/31	488769	547210	142.94
	6/30	<u>345822</u>	<u>504849</u>	<u>-42.36</u>
		142947	42361	100.58
AUG 19	8/31	605738	586492	116.96
	7/31	<u>488769</u>	<u>547210</u>	<u>-39.28</u>
		116969	39282	77.68
SEP 19	9/30	748662	632809	142.92
	8/31	<u>605738</u>	<u>586492</u>	<u>-46.31</u>
		142924	46317	96.61

WHOLESALE REUSE FLOW READINGS
FY 2017/2018

		SPB 570 MTR#1664054	TIERRA VERDE MTR# 3K6256026	BILLING
OCT 17	10/31	4081235	5180165	141.57
	9/30	<u>3939663</u>	<u>5135085</u>	<u>-45.08</u>
		141572	45080	96.49
NOV 17	11/30	4221296	5224164	140.06
	10/31	<u>4081235</u>	<u>5180165</u>	<u>-43.99</u>
		140061	43999	96.07
DEC 17	12/30	4345969	5263976	124.67
	11/30	<u>4221296</u>	<u>5224164</u>	<u>-39.81</u>
		124673	39812	84.86
JAN 18	1/31	4468754	5304136	122.78
	12/30	<u>4345969</u>	<u>5263976</u>	<u>-40.16</u>
		122785	40160	82.62
FEB 18	2/28	4577632	5338468	108.87
	1/31	<u>4468754</u>	<u>5304136</u>	<u>-34.33</u>
		108878	34332	74.54
MAR 18	3/31	4704352	5378205	126.72
	2/28	<u>4577632</u>	<u>5338468</u>	<u>-39.73</u>
		126720	39737	86.99
APR 18	4/28	4837148	5419577	132.79
	3/31	<u>4704352</u>	<u>5378205</u>	<u>-41.37</u>
		132796	41372	91.42
MAY 18	5/31	4963463	5458724	126.31
	4/28	<u>4837148</u>	<u>5419577</u>	<u>-39.14</u>
		126315	39147	87.17
JUN 18	6/30	5088083	5499155	124.62
	5/31	<u>4963463</u>	<u>5458724</u>	<u>-40.43</u>
		124620	40431	84.19
JUL 18	7/31	5229389	5544244	141.30
	6/30	<u>5088083</u>	<u>5499155</u>	<u>-45.08</u>
		141306	45089	96.22
AUG 18	8/31	5364476	5587938	135.08
	7/31	<u>5229389</u>	<u>5544244</u>	<u>-43.69</u>
		135087	43694	91.39
SEP 18	9/29	5489072	5628164	124.59
	8/31	<u>5364476</u>	<u>5587938</u>	<u>-40.22</u>
		124596	40226	84.37

WHOLESALE REUSE FLOW READINGS
FY 2016/2017

		SPB 570 MTR#1664054	TIERRA VERDE MTR# 3K6256026	BILLING
OCT 16	10/31	2427186	4659092	109.39
	9/30	<u>2317787</u>	<u>4614703</u>	<u>-44.38</u>
		109399	44389	65.01
NOV 16	11/30	2571592	4702861	144.40
	10/31	<u>2427186</u>	<u>4659092</u>	<u>-43.76</u>
		144406	43769	100.64
DEC 16	12/30	2705938	4744675	134.34
	11/30	<u>2571592</u>	<u>4702861</u>	<u>-41.81</u>
		134346	41814	92.53
JAN 17	1/31	2843786	4788653	137.84
	12/30	<u>2705938</u>	<u>4744675</u>	<u>-43.97</u>
		137848	43978	93.87
FEB 17	2/28	2959132	4825582	115.34
	1/31	<u>2843786</u>	<u>4788653</u>	<u>-36.92</u>
		115346	36929	78.42
MAR 17	3/31	3096839	4868558	137.70
	2/28	<u>2959132</u>	<u>4825582</u>	<u>-42.97</u>
		137707	42976	94.73
APR 17	4/28	3227040	4906735	130.20
	3/31	<u>3096839</u>	<u>4868558</u>	<u>-38.17</u>
		130201	38177	92.03
MAY 17	5/31	3389837	4957859	162.79
	4/28	<u>3227040</u>	<u>4906735</u>	<u>-51.12</u>
		162797	51124	111.67
JUN 17	6/30	3521989	5000989	132.15
	5/31	<u>3389837</u>	<u>4957859</u>	<u>-43.13</u>
		132152	43130	89.02
JUL 17	7/31	3670029	5048753	148.04
	6/30	<u>3521989</u>	<u>5000989</u>	<u>-47.76</u>
		148040	47764	100.28
AUG 17	8/31	3818138	5095493	148.10
	7/31	<u>3670029</u>	<u>5048753</u>	<u>-46.74</u>
		148109	46740	101.36
SEP 17	9/29	3939663	5135085	121.52
	8/31	<u>3818138</u>	<u>5095493</u>	<u>-39.59</u>
		121525	39592	81.93

WHOLESALE REUSE FLOW READINGS
FY 2015/2016

		SPB 550 MTR#1664054	TIERRA VERDE MTR# 3K6256026	BILLING
OCT 15	10/30	1018361	4049423	123.73
	9/30	<u>894623</u>	<u>3996721</u>	<u>-52.70</u>
		123738	52702	71.03
NOV 15	11/30	1142379	4103188	124.01
	10/30	<u>1018361</u>	<u>4049423</u>	<u>-53.76</u>
		124018	53765	70.25
DEC 15	12/31	1261539	4154704	119.16
	11/30	<u>1142379</u>	<u>4103188</u>	<u>-51.51</u>
		119160	51516	67.65
JAN 16	1/29	1350605	4196141	89.06
	12/31	<u>1261539</u>	<u>4154704</u>	<u>-41.43</u>
		89066	41437	47.63
FEB 16	2/29	1441677	4237418	91.07
	1/29	<u>1350605</u>	<u>4196141</u>	<u>-41.27</u>
		91072	41277	49.80
MAR 16	3/31	1538982	4280206	97.30
	2/29	<u>1441677</u>	<u>4237418</u>	<u>-42.78</u>
		97305	42788	54.52
APR 16	4/29	1640520	4324581	101.53
	3/31	<u>1538982</u>	<u>4280206</u>	<u>-44.37</u>
		101538	44375	57.16
MAY 16	5/31	1772765	4382690	132.24
	4/29	<u>1640520</u>	<u>4324581</u>	<u>-58.10</u>
		132245	58109	74.14
JUN 16	6/30	1894858	4437997	122.09
	5/31	<u>1772765</u>	<u>4382690</u>	<u>-55.30</u>
		122093	55307	66.79
JUL 16	7/29	2041364	4499705	146.50
	6/30	<u>1894858</u>	<u>4437997</u>	<u>61.70</u>
		146506	61708	84.80
AUG 16	8/31	2193373	4562400	152.00
	7/29	<u>2041364</u>	<u>4499705</u>	<u>62.69</u>
		152009	62695	89.31
SEP 16	9/30	2317787	4614703	124.41
	8/31	<u>2193373</u>	<u>4562400</u>	<u>52.30</u>
		124414	52303	72.11

WHOLESALE REUSE FLOW READINGS
FY 2014/2015

		SPB 550 MTR#1664054	TIERRA VERDE MTR# 3K6256026	BILLING
OCT 14	10/31	5639223	3470258	105.27
	9/30	<u>5533950</u>	<u>3416492</u>	<u>-53.76</u>
		105273	53766	51.51
NOV 14	11/26	5728564	3514508	89.34
	10/31	<u>5639223</u>	<u>3470258</u>	<u>-44.25</u>
		89341	44250	45.09
DEC 14	12/31	5834578	3569882	106.01
	11/26	<u>5728564</u>	<u>3514508</u>	<u>-55.37</u>
		106014	55374	50.64
JAN 15	1/30	5915155	3613411	80.57
	12/31	<u>5834578</u>	<u>3569882</u>	<u>-43.52</u>
		80577	43529	37.05
FEB 15	2/26	0 / 67624	3650301	79.38
	1/30	<u>5915155</u>	<u>3613411</u>	<u>-36.89</u>
		67624	36890	42.49
		79384 Estimated		
MAR 15	3/31	182187	3699011	114.56
	2/26	<u>67624</u>	<u>3650301</u>	<u>-48.71</u>
		114563	48710	65.85
APR 15	4/29	299332	3747763	117.14
	3/31	<u>182187</u>	<u>3699011</u>	<u>-48.75</u>
		117145	48752	68.39
MAY 15	5/29	406578	3793466	107.24
	4/29	<u>299332</u>	<u>3747763</u>	<u>-45.70</u>
		107246	45703	61.54
JUN 15	6/30	529664	3844269	123.08
	5/29	<u>406578</u>	<u>3793466</u>	<u>-50.80</u>
		123086	50803	72.28
JUL 15	7/31	653572	3894705	123.90
	6/30	<u>529664</u>	<u>3844269</u>	<u>-50.43</u>
		123908	50436	73.47
AUG 15	8/31	776717	3946370	123.14
	7/31	<u>653572</u>	<u>3894705</u>	<u>-51.66</u>
		123145	51665	71.48
SEP 15	9/30	894623	3996721	117.90
	8/31	<u>776717</u>	<u>3946370</u>	<u>-50.35</u>
		117906	50351	67.55

*Feb '15 SPB cons estimated based on daily avg due to meter malfunction. New register started at 0 2/4/15.

WHOLESALE REUSE FLOW READINGS
FY 2013/2014

		SPB 550	TIERRA VERDE	BILLING
		MTR#1664054	MTR# 3K6256026	
OCT 13	10/31	4485759	2902454	113.14
	9/30	<u>4372614</u>	<u>2848505</u>	<u>-53.94</u>
		113145	53949	59.20
NOV 13	11/27	4578463	2946780	92.70
	10/31	<u>4485759</u>	<u>2902454</u>	<u>-44.32</u>
		92704	44326	48.38
DEC 13	12/31	4683814	2998053	105.35
	11/27	<u>4578463</u>	<u>2946780</u>	<u>-51.27</u>
		105351	51273	54.08
JAN 14	1/31	4763321	3039951	79.50
	12/31	<u>4683814</u>	<u>2998053</u>	<u>-41.89</u>
		79507	41898	37.61
FEB 14	2/28	4833195	3076558	69.87
	1/31	<u>4763321</u>	<u>3039951</u>	<u>-36.60</u>
		69874	36607	33.27
MAR 14	3/31	4912670	3117009	79.47
	2/28	<u>4833195</u>	<u>3076558</u>	<u>-40.45</u>
		79475	40451	39.02
APR 14	4/29	4994687	3159118	82.01
	3/31	<u>4912670</u>	<u>3117009</u>	<u>-42.10</u>
		82017	42109	39.91
MAY 14	5/30	5099169	3209519	104.48
	4/30	<u>4994687</u>	<u>3159118</u>	<u>-50.40</u>
		104482	50401	54.08
JUN 14	6/30	5208126	3260273	108.95
	5/30	<u>5099169</u>	<u>3209519</u>	<u>-50.75</u>
		108957	50754	58.20
JUL 14	7/31	5314698	3310753	106.57
	6/30	<u>5208126</u>	<u>3260273</u>	<u>-50.48</u>
		106572	50480	56.09
AUG 14	8/29	5424438	3362115	109.74
	7/31	<u>5314698</u>	<u>3310753</u>	<u>-51.36</u>
		109740	51362	58.38
SEP 14	9/30	5533950	3416492	109.51
	8/29	<u>5424438</u>	<u>3362115</u>	<u>-54.37</u>
		109512	54377	55.14

WHOLESALE REUSE FLOW READINGS
FY 2012/2013

		SPB 550 MTR#1664054	TIERRA VERDE MTR# 3K6256026	BILLING
OCT 12	10/31	3160337	2311250	143.41
	9/28	<u>3016923</u>	<u>2255654</u>	<u>-55.59</u>
		143414	55596	87.82
NOV 12	11/30	3288439	2361165	128.10
	10/31	<u>3160337</u>	<u>2311250</u>	<u>-49.91</u>
		128102	49915	78.19
DEC 12	12/28	3397485	2404660	109.04
	11/30	<u>3288439</u>	<u>2361165</u>	<u>43.49</u>
		109046	43495	65.55
JAN 13	1/31	3520044	2456214	122.55
	12/28	<u>3397485</u>	<u>2404660</u>	<u>-51.55</u>
		122559	51554	71.00
FEB 13	2/28	3625415	2498626	105.37
	1/31	<u>3520044</u>	<u>2456214</u>	<u>-42.41</u>
		105371	42412	62.96
MAR 13	3/29	3732191	2542989	106.77
		<u>3625415</u>	<u>2498626</u>	<u>-44.36</u>
		106776	44363	62.41
APR 13	4/30	3837289	2591700	105.09
		<u>3732191</u>	<u>2542989</u>	<u>-48.71</u>
		105098	48711	56.38
MAY 13	5/31	3955646	2645973	118.35
		<u>3837289</u>	<u>2591700</u>	<u>-54.27</u>
		118357	54273	64.08
JUN 13	6/28	4061204	2695025	105.55
		<u>3955646</u>	<u>2645973</u>	<u>-49.05</u>
		105558	49052	56.50
JUL 13	7/31	4166798	2747260	105.59
		<u>4061204</u>	<u>2695025</u>	<u>-52.23</u>
		105594	52235	53.36
AUG 13	8/30	4272272	2798067	105.47
		<u>4166798</u>	<u>2747260</u>	<u>-50.80</u>
		105474	50807	54.67
SEP 13	9/30	4372614	2848505	100.34
		<u>4272272</u>	<u>2798067</u>	<u>-50.43</u>
		100342	50438	49.91

WHOLESALE REUSE FLOW READINGS
FY 2011/2012

		SPB 550	TIERRA VERDE	BILLING
		MTR#1664054	MTR# 3K6256026	
OCT 11	10/31	1733805	1717112	137.61
	09/30	<u>1596193</u>	<u>1660022</u>	<u>-57.09</u>
		137612	57090	80.52
NOV 11	11/30	1858080	1769747	124.27
	10/31	<u>1733805</u>	<u>1717112</u>	<u>-52.63</u>
		124275	52635	71.64
DEC 11	12/30	1974941	1819736	116.86
	11/30	<u>1858080</u>	<u>1769747</u>	<u>-49.98</u>
		116861	49989	66.88
JAN 12	01/31	2092047	1869990	117.10
	12/30	<u>1974941</u>	<u>1819736</u>	<u>-50.25</u>
		117106	50254	66.85
FEB 12	02/29	2147944	1912608	97.75
	01/31	<u>2092047</u>	<u>1869990</u>	<u>-42.61</u>
		55897	42618	55.14
		97759 *Estimated		
MAR 12	03/30	2276091	1963733	128.14
	02/29	<u>2147944</u>	<u>1912608</u>	<u>-51.12</u>
		128147	51125	77.02
APR 12	04/30	2403991	2014480	127.90
	03/30	<u>2276091</u>	<u>1963733</u>	<u>-50.74</u>
		127900	50747	77.16
MAY 12	05/31	2533618	2065408	129.62
	04/30	<u>2403991</u>	<u>2014480</u>	<u>-50.92</u>
		129627	50928	78.70
JUN 12	06/29	2648618	2108659	115.00
	05/31	<u>2533618</u>	<u>2065408</u>	<u>-43.25</u>
		115000	43251	71.75
JUL 12	07/31	2771868	2157700	123.25
	06/29	<u>2648618</u>	<u>2108659</u>	<u>-49.04</u>
		123250	49041	74.21
AUG 12	8/31	2900014	2208527	128.14
	07/31	<u>2771868</u>	<u>2157700</u>	<u>-50.82</u>
		128146	50827	77.32
SEP 12	9/28	3016923	2255654	116.90
	8/31	<u>2900014</u>	<u>2208527</u>	<u>-47.12</u>
		116909	47127	69.78

*Feb '12 SPB cons estimated based on daily avg due to meter malfunction and 2 days svc outage 2/23-2/25/12.