

Z-14-11-17

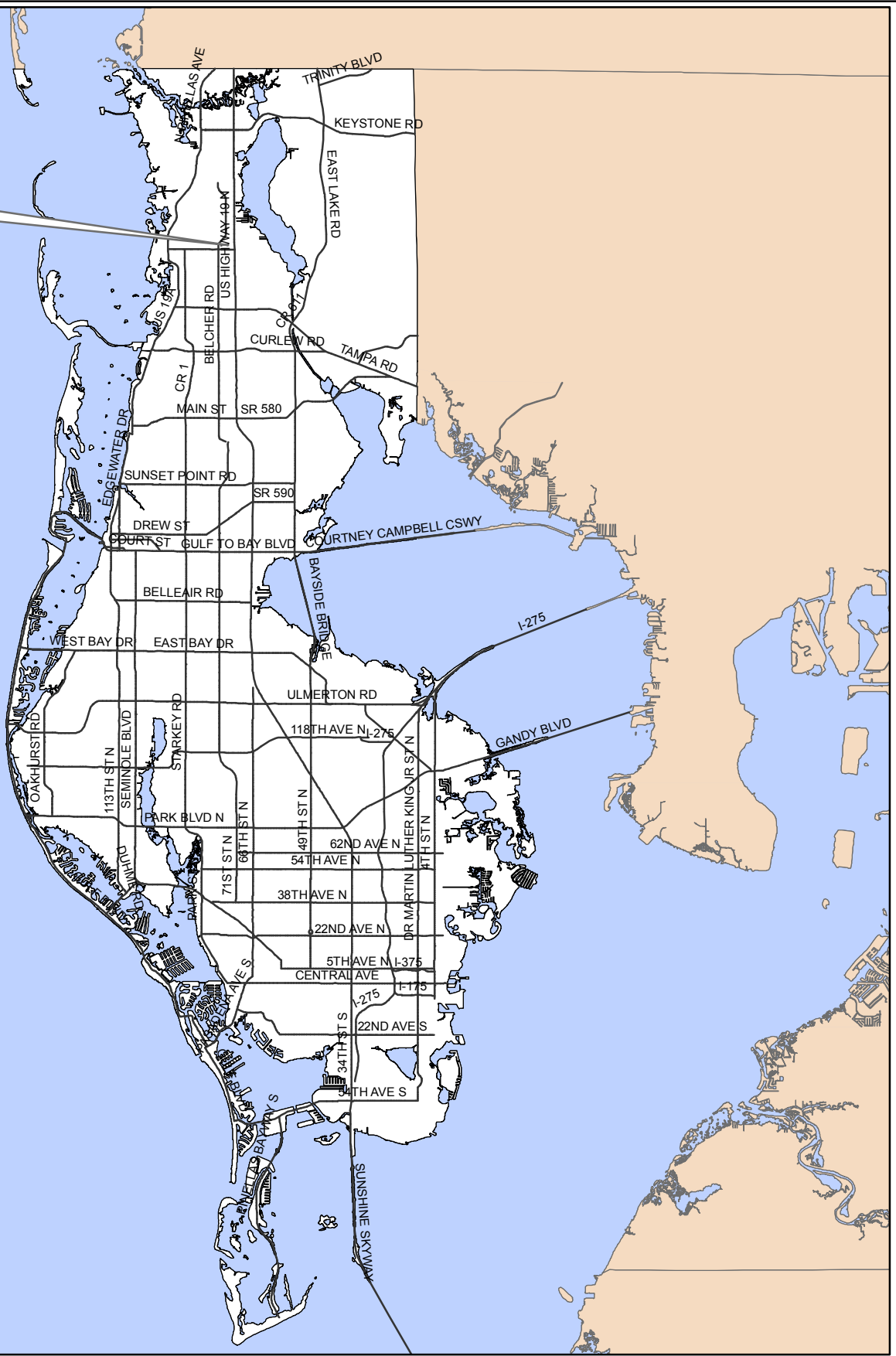

Surrounding Counties

# Z-14-11-17

## LOCATION MAP

**Zoning**

**From:** CP-1, Commercial Parkway  
**To:** CP-2, Commercial Parkway



Portion of 31/27/16/00000/240/0100

Prepared by: Pinellas County Planning Department



Date: 09/26/2017

1 inch = 4.5 miles

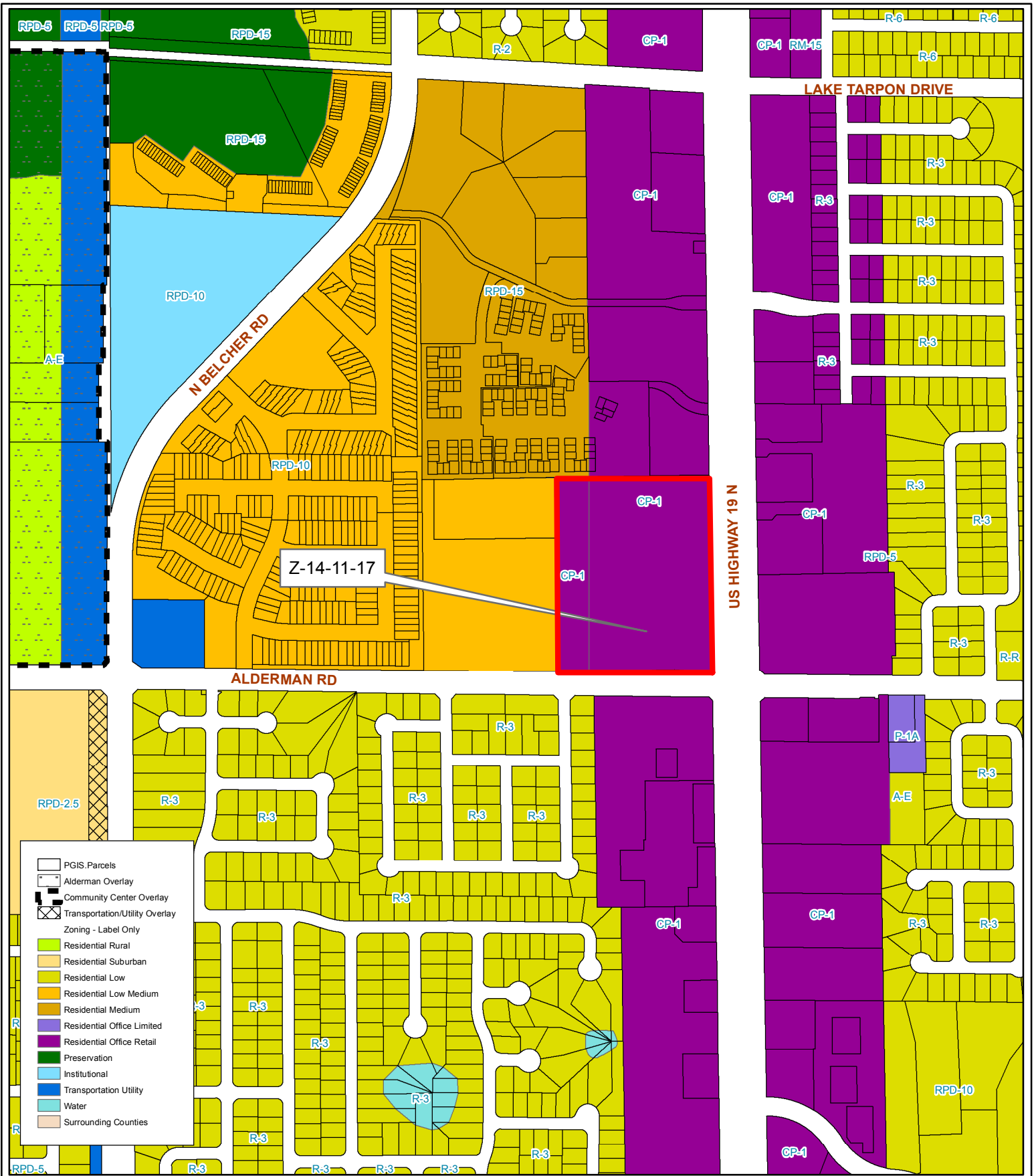

**Z-14-11-17**

**CURRENT ZONING**

**Zoning**

**From:** CP-1, Commercial Parkway  
**To:** CP-2, Commercial Parkway

Portion of 31/27/16/00000/240/0100

Prepared by: Pinellas County Planning Department



Date: 09/26/2017



1 inch = 0.1 miles



**Z-14-11-17**

**AERIAL MAP**

**Zoning**

**From:** CP-1, Commercial Parkway

**To:** CP-2, Commercial Parkway

Portion of 31/27/16/00000/240/0100

Prepared by: Pinellas County Planning Department



Date: 09/26/2017



1 inch = 0.1 miles

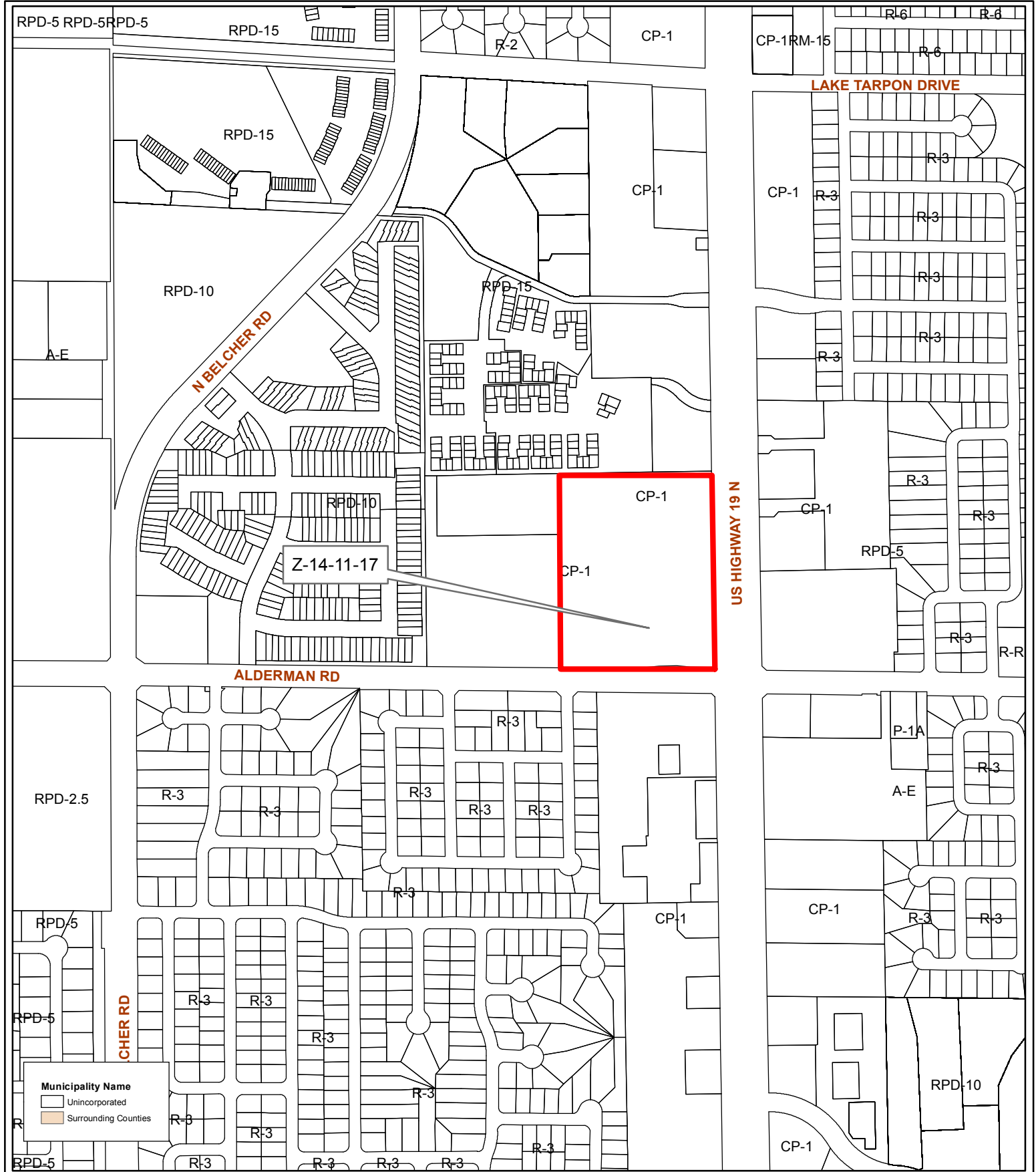

**Z-14-11-17**  
**MUNICIPAL MAP**

**Zoning**      **From:** CP-1, Commercial Parkway  
**To:** CP-2, Commercial Parkway



Portion of 31/27/16/00000/240/0100

Prepared by: Pinellas County Planning Department



Date: 09/26/2017

1 inch = 0.1 miles

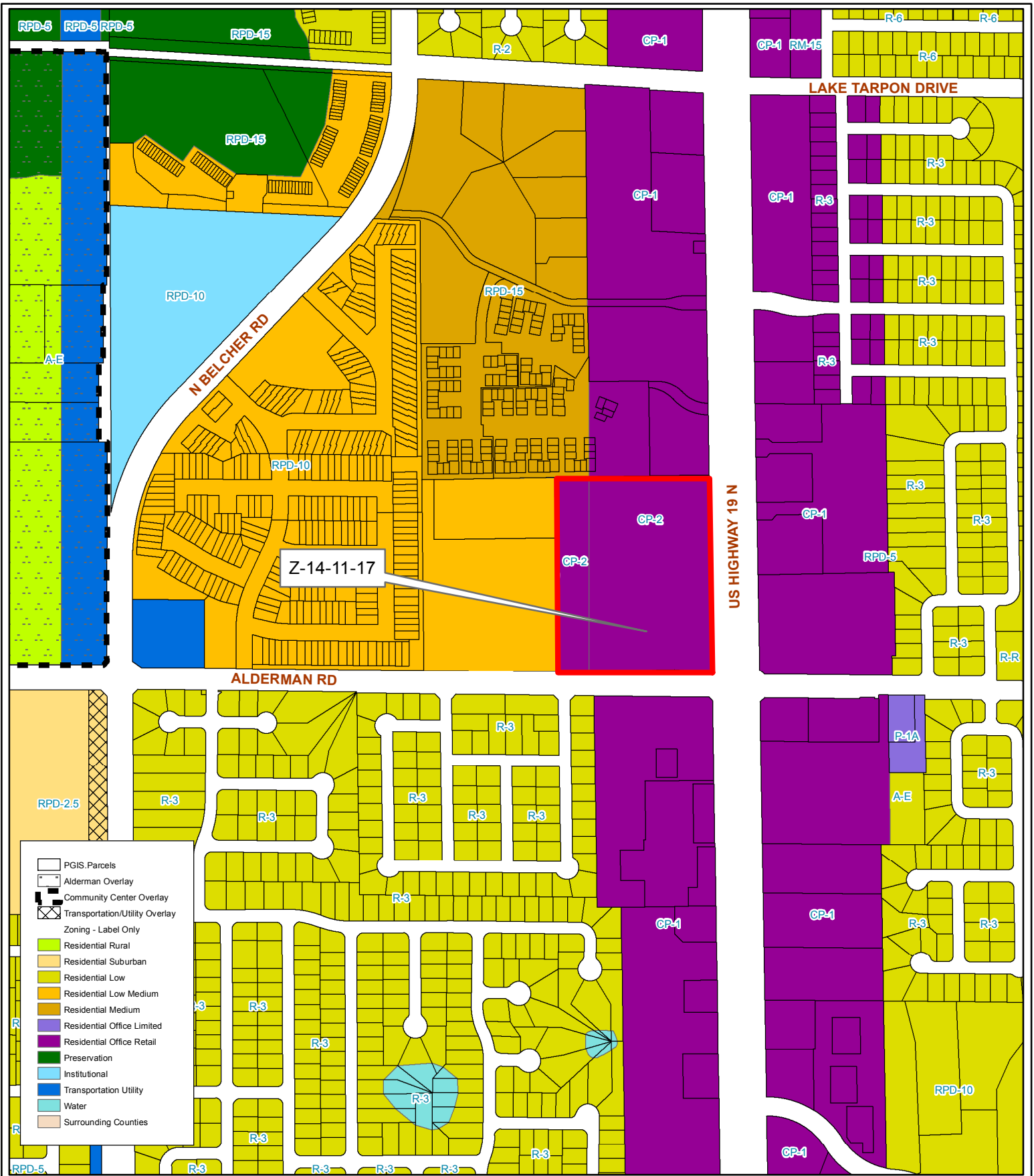

- PGIS Parcels
- Alderman Overlay
- Community Center Overlay
- Transportation/Utility Overlay
- Zoning - Label Only
- Residential Rural
- Residential Suburban
- Residential Low
- Residential Low Medium
- Residential Medium
- Residential Office Limited
- Residential Office Retail
- Preservation
- Institutional
- Transportation Utility
- Water
- Surrounding Counties

**Z-14-11-17**  
**PROPOSED ZONING**

**Zoning**      **From:** CP-1, Commercial Parkway  
**To:** CP-2, Commercial Parkway



Portion of 31/27/16/00000/240/0100

Prepared by: Pinellas County Planning Department



Date: 09/26/2017

1 inch = 0.1 miles