

Case CW24-02

Map 1: Location Map

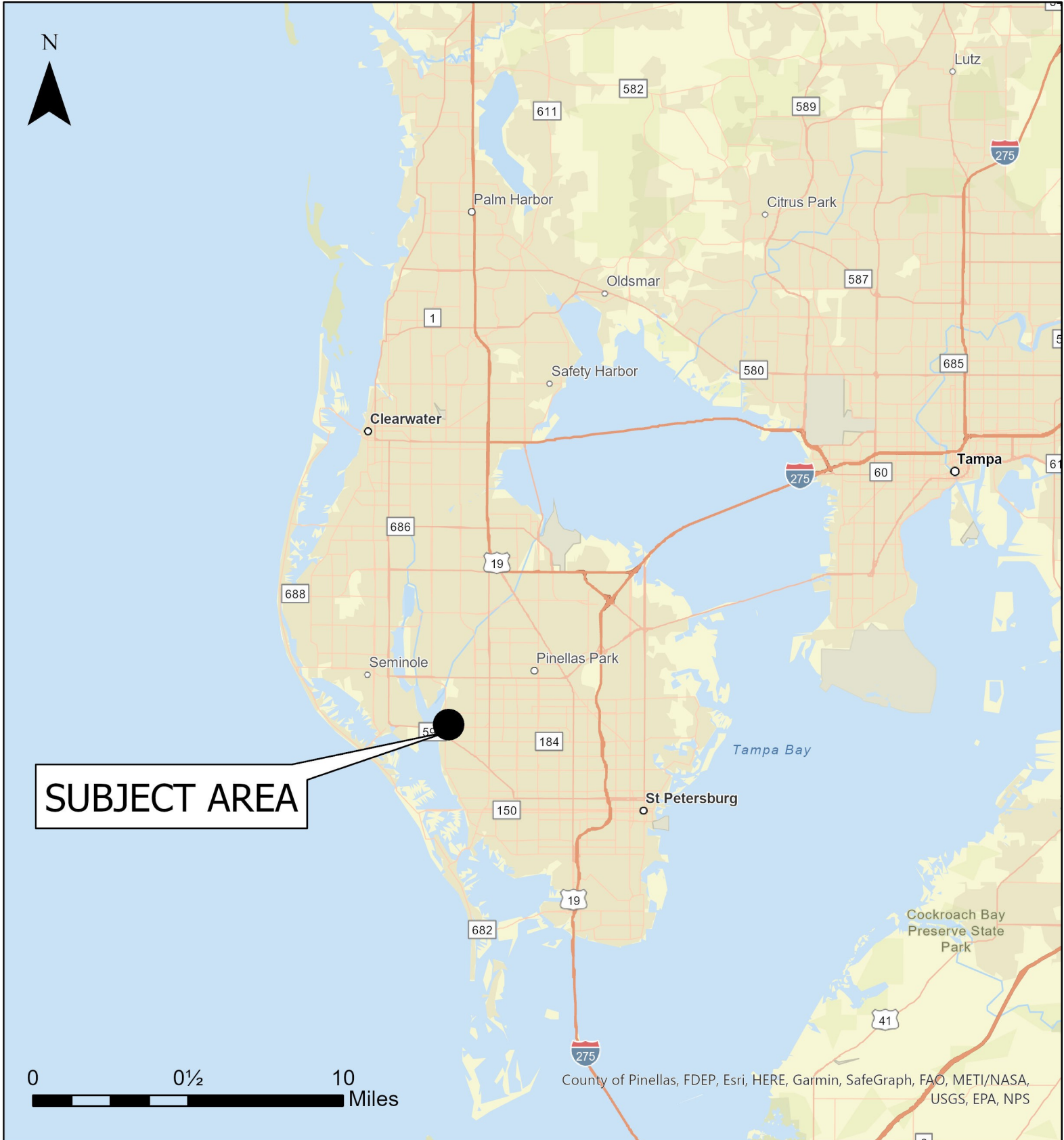

JURISDICTION: Pinellas County **FROM: Residential Low Medium**
AREA: 0.19 acres m.o.l. **TO: Retail & Services**

Case CW24-02

Map 2: Jurisdictional Map

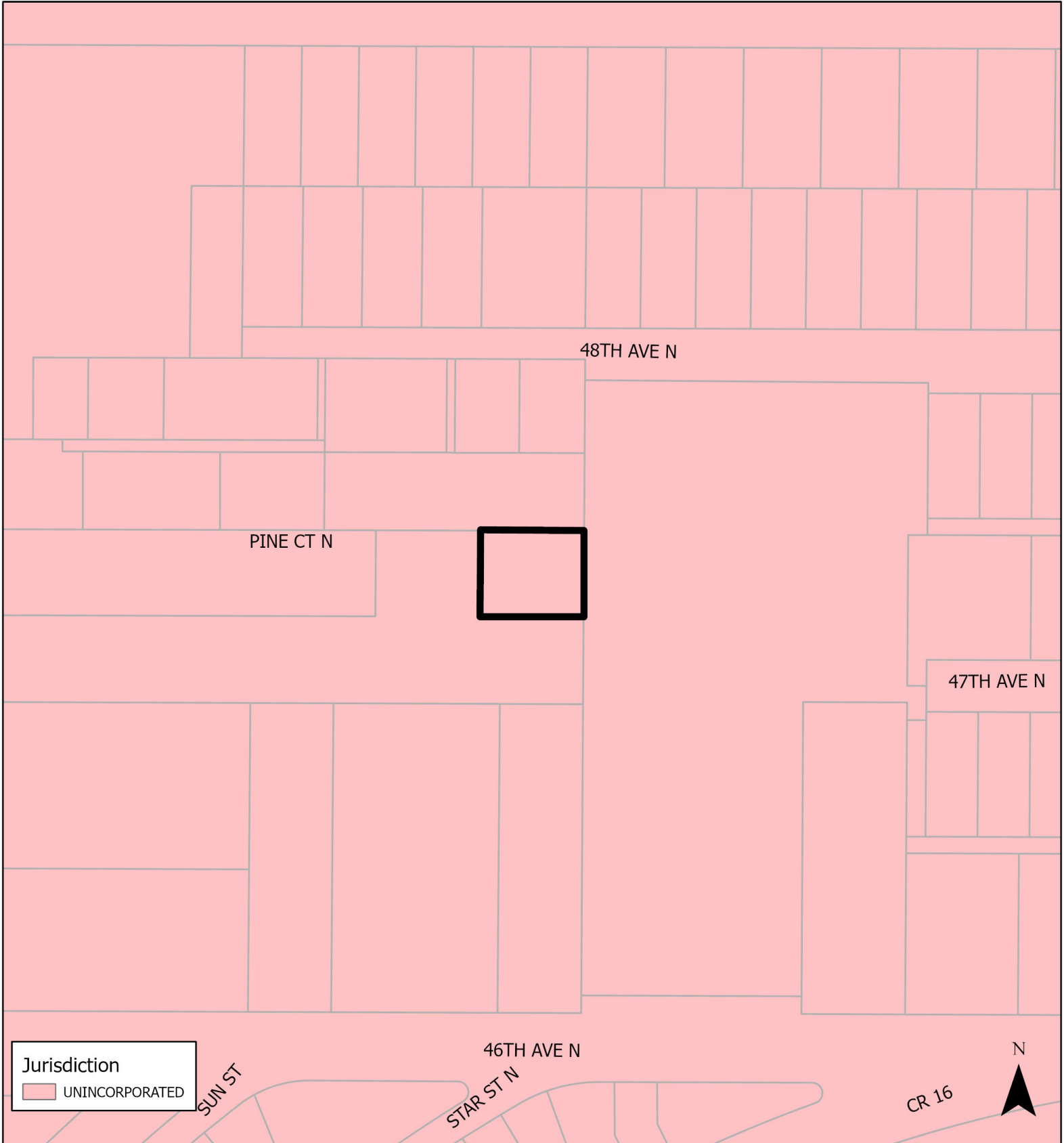

Jurisdiction
UNINCORPORATED

JURISDICTION: Pinellas County **FROM: Residential Low Medium**
AREA: 0.19 acres m.o.l. **TO: Retail & Services**

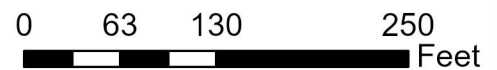

Case CW24-02

Map 3: Aerial Map



JURISDICTION: Pinellas County

FROM: Residential Low Medium

AREA: 0.19 acres m.o.l.

TO: Retail & Services



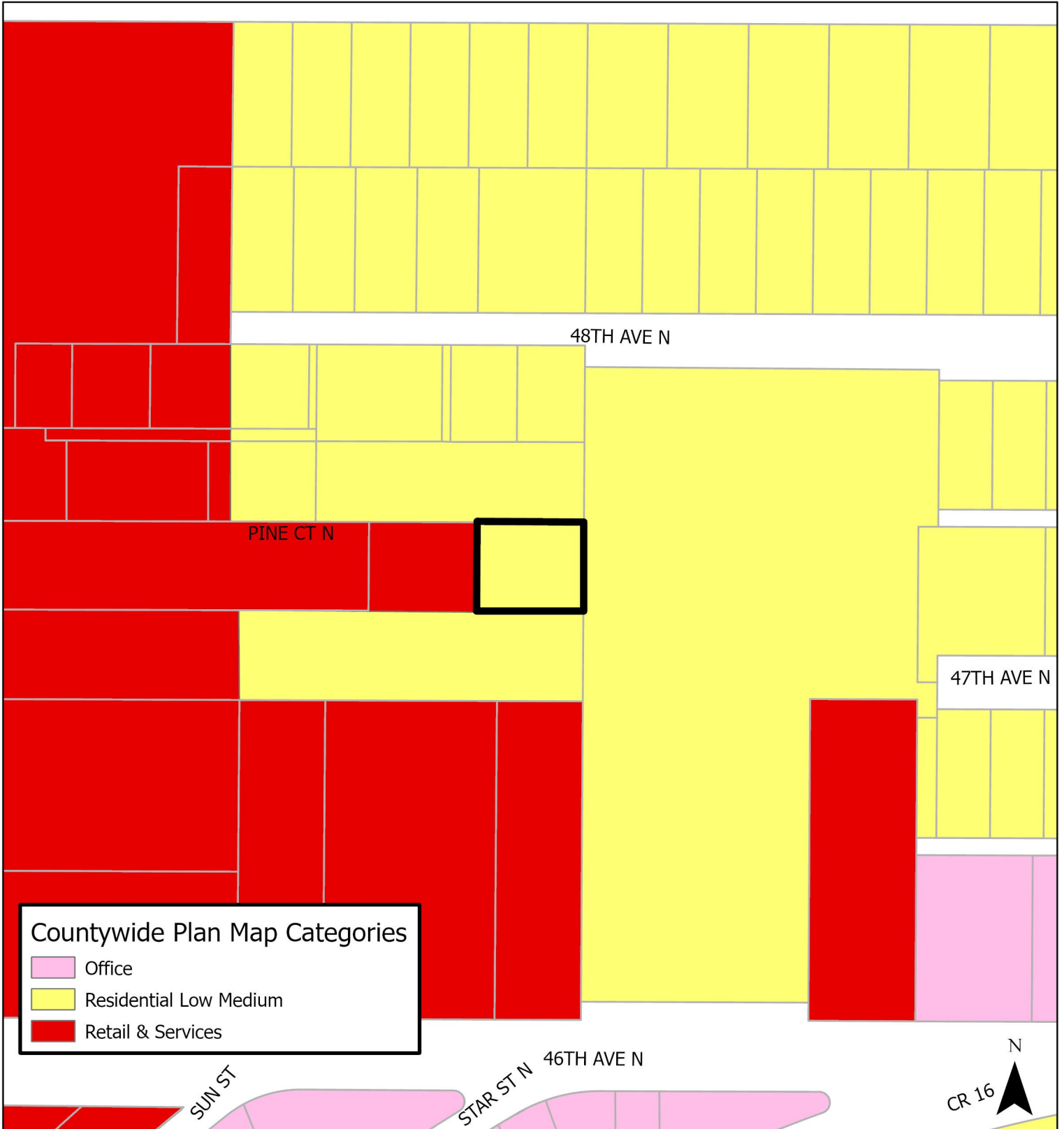

Countywide Plan Map Categories

- Office
- Residential Low Medium
- Retail & Services

JURISDICTION: Pinellas County FROM: Residential Low Medium

AREA: 0.19 acres m.o.l

TO: Retail & Services

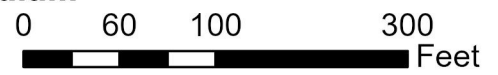

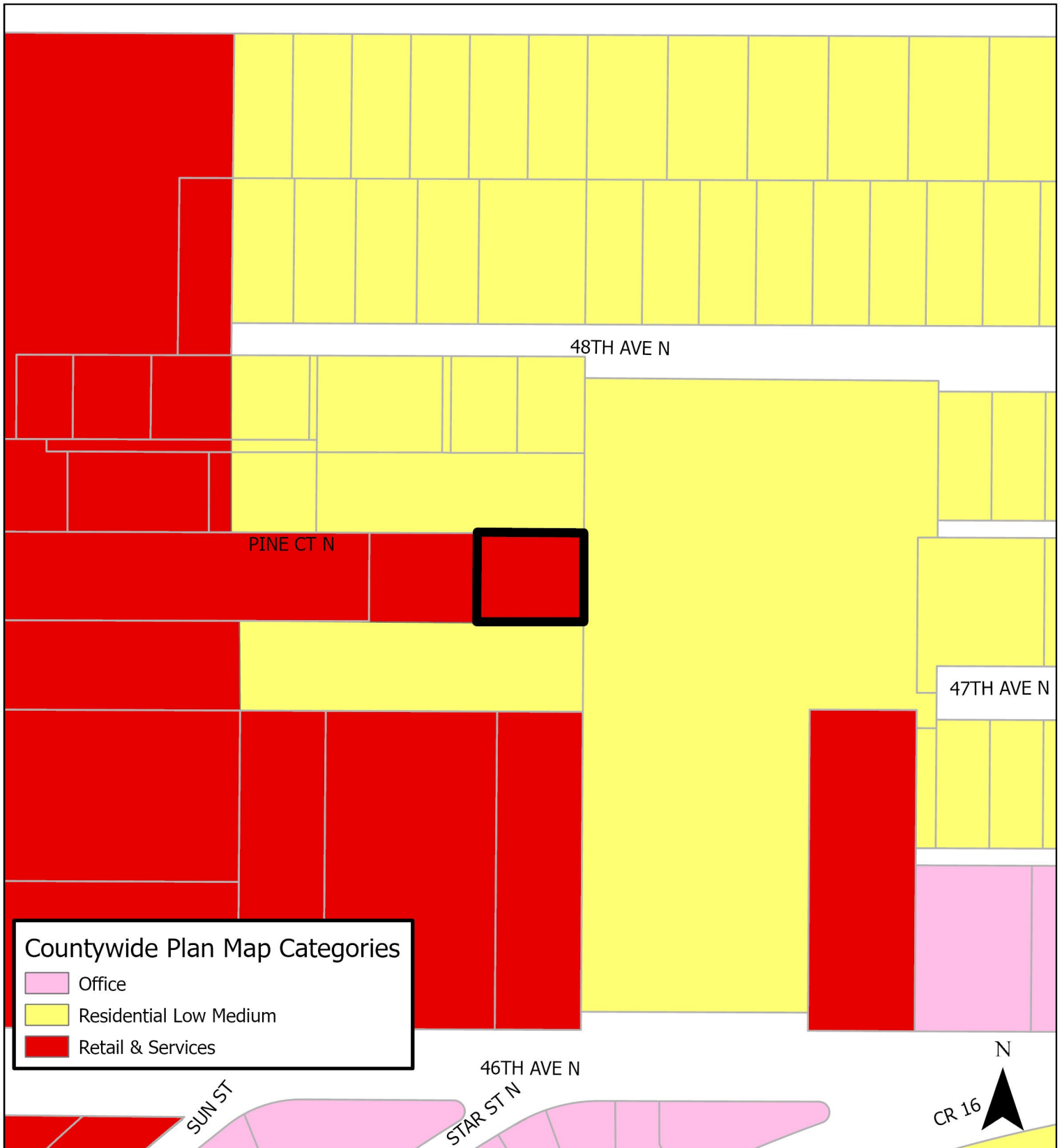

JURISDICTION: Pinellas County **FROM: Residential Low Medium**
AREA: 0.19 acres **TO: Retail & Services**

0 62.5 125 250
Feet