

PINELLAS COUNTY  
 PUBLIC WORKS  
 SURVEY AND MAPPING DIVISION  
 22211 U.S. HIGHWAY 19 N.  
 CLEARWATER, FLORIDA 33765-2328



**SECTION 8, TOWNSHIP 27 SOUTH, RANGE 16 EAST**

**DESCRIPTION**

A portion of a 30.00 foot Right-of-Way lying between Lots 7 & 17 and Lots 8 & 20 of the plat of TAMPA AND TARPON SPRINGS LAND COMPANY, recorded in Plat Book 1, Page 116 of the public records of Hillsborough County, Florida, of which Pinellas County was formerly a part, lying in the North 1/2 of Section 8, Township 27 South, Range 16 East, Pinellas County, Florida, being described as follows:

Commencing at the Southeast corner of the Northwest 1/4 of Section 8, Township 27 South, Range 16 East, thence run N01°21'44"W along the East line of said Northwest 1/4 of Section 8, for a distance of 1325.80 feet to the Southeast corner of the Northeast 1/4 of the Northwest 1/4 of said Section 8 and the POINT OF BEGINNING; thence N89°43'24"W, for a distance of 15.01 feet; thence N01°21'44"W, along a line being 15.00 feet West of and parallel with said East line of the Northwest 1/4, for a distance of 335.45 feet to a point on the proposed East Right-of-Way line of North Highland Avenue; thence N24°15'46"E along said proposed East Right-of-Way line, for a distance of 69.37 feet; thence leaving said proposed East Right-of-Way line S01°21'44"E, along a line being 15.00 feet East of and parallel with said East line of the Northwest 1/4, for a distance of 398.85 feet; thence N89°43'24"W, for a distance of 15.01 feet to the POINT OF BEGINNING.

CONTAINING: 11,015 square feet or 0.253 acres, more or less.

BASIS OF BEARINGS: Bearings indicated are assumed based on the East line of the NW 1/4 of Section 8, Township 27 South, Range 16 East, Pinellas County, Florida being N 01°21'44"W.

Additions or deletions by other than the Professional Surveyor and Mapper in responsible charge are prohibited. Sketch and/or Description is invalid without the original signature and seal of the Professional Surveyor and Mapper.

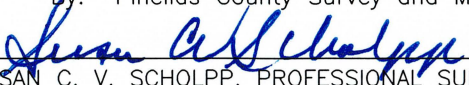
CALCULATED BY: RAC	The above Sketch and Land description was prepared under my supervision and is true and correct to the best of my knowledge and belief. By: Pinellas County Survey and Mapping Division  DATE <u>07/28/21</u> SUSAN C. V. SCHOLPP, PROFESSIONAL SURVEYOR AND MAPPER LICENSE NUMBER: 6034 SEAL STATE OF FLORIDA, PHONE # (727) 464-8904
CHECKED BY: GD	
S.F.N.: 1931_00002	

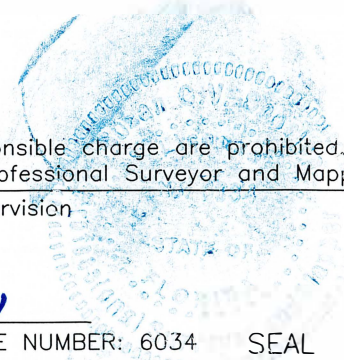



SECTION 8, TOWNSHIP 27 SOUTH, RANGE 16 EAST  
 SKETCH - NOT A SURVEY

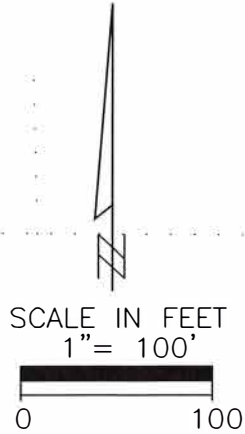

LOT 17  
 TAMPA & TARPON  
 SPRINGS LAND CO  
 HPB 1, PG 116

LOT 7  
 TAMPA & TARPON  
 SPRINGS LAND CO  
 HPB 1, PG 116

LOT 20  
 TAMPA & TARPON  
 SPRINGS LAND CO  
 HPB 1, PG 116

LOT 8  
 TAMPA & TARPON  
 SPRINGS LAND CO  
 HPB 1, PG 116

**LEGEND**  
 HPB HILLSBOROUGH PLAT BOOK  
 OR OFFICIAL RECORD  
 PG PAGE  
 POB POINT OF BEGINNING  
 POC POINT OF COMMENCEMENT  
 R/W RIGHT-OF-WAY  
 SEC SECTION

LINE TABLE		
LINE #	BEARING	LENGTH
L1	N89°43'24"W	15.01'
L2	N24°15'46"E	69.37'
L3	N89°43'24"W	15.01'

CALCULATED BY:  
 RAC  
 CHECKED BY:  
 GD  
 S.F.N.:  
 1931\_00002

