

Johns Hopkins All Children's Hospital

Dr. Jonathan Ellen
President and Vice Dean

December 13, 2016



JOHNS HOPKINS
M E D I C I N E

JOHNS HOPKINS
ALL CHILDREN'S HOSPITAL



Mission Focused

- Pediatric Healthcare Provider
 - Patient Centric
 - Institutes
 - Community Resource – St. Pete & Pinellas
 - Local, Regional, State, National, International
- Academics
 - 3 classes of JHACH residents; Fellowships
 - Teaching site for USF College of Medicine
- Research
 - Bench to bedside
 - Biorepository and Molecular Determinants

JHACH Accomplishments

- Rebrand of ACH to Johns Hopkins All Children's Hospital
- From Volume to Value-Based Care
- Groundbreaking for Johns Hopkins All Children's Research & Education Building

JHAC Research & Education Building

- 230,000 Square Feet
- \$95.5 M
- Construction Jobs
 - Minority
 - Local
 - Veteran



Opening 2018

JHAC Research & Education Building – First Floor Example

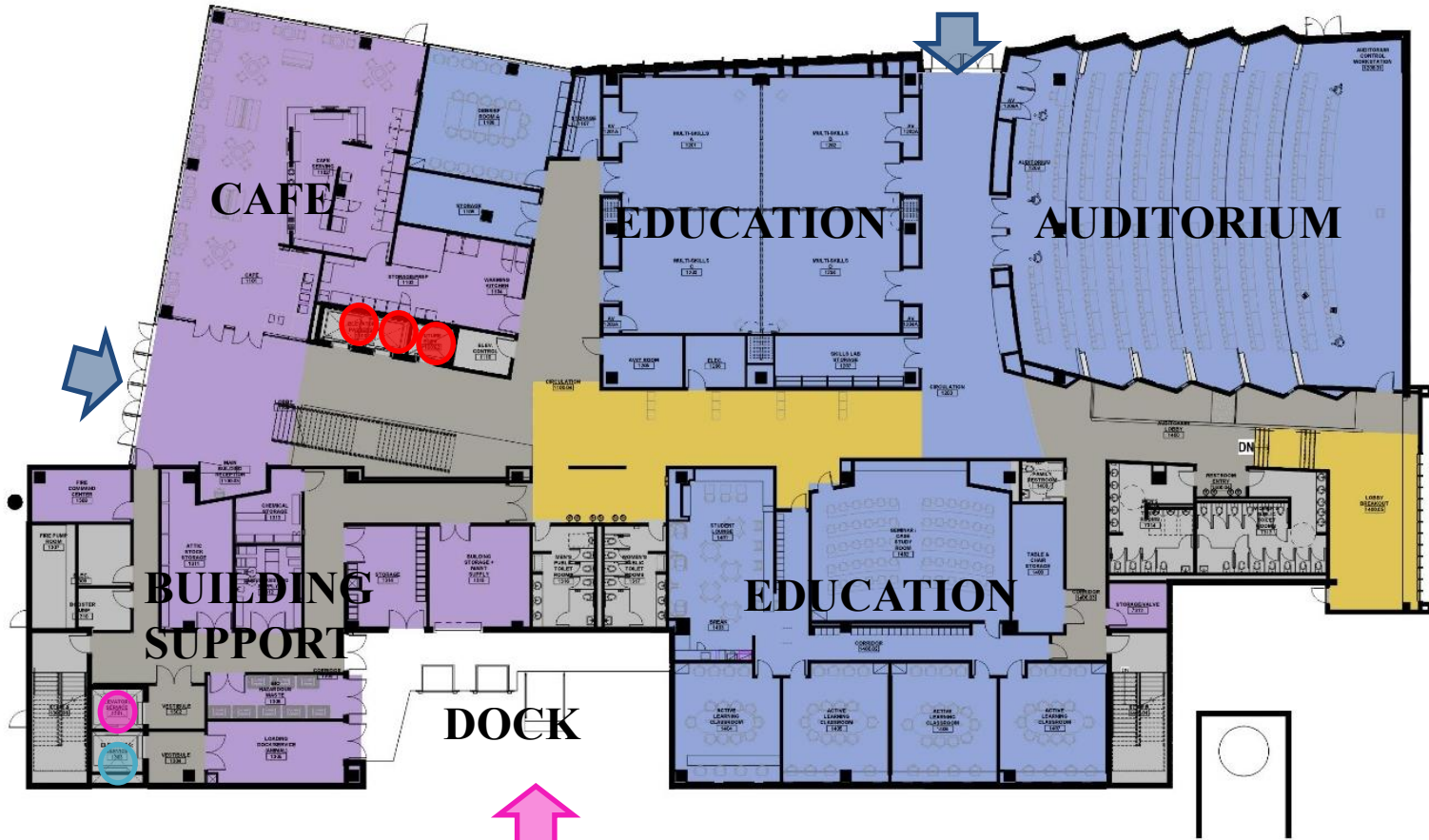

JHAC Research & Education Building – Fourth Floor Example

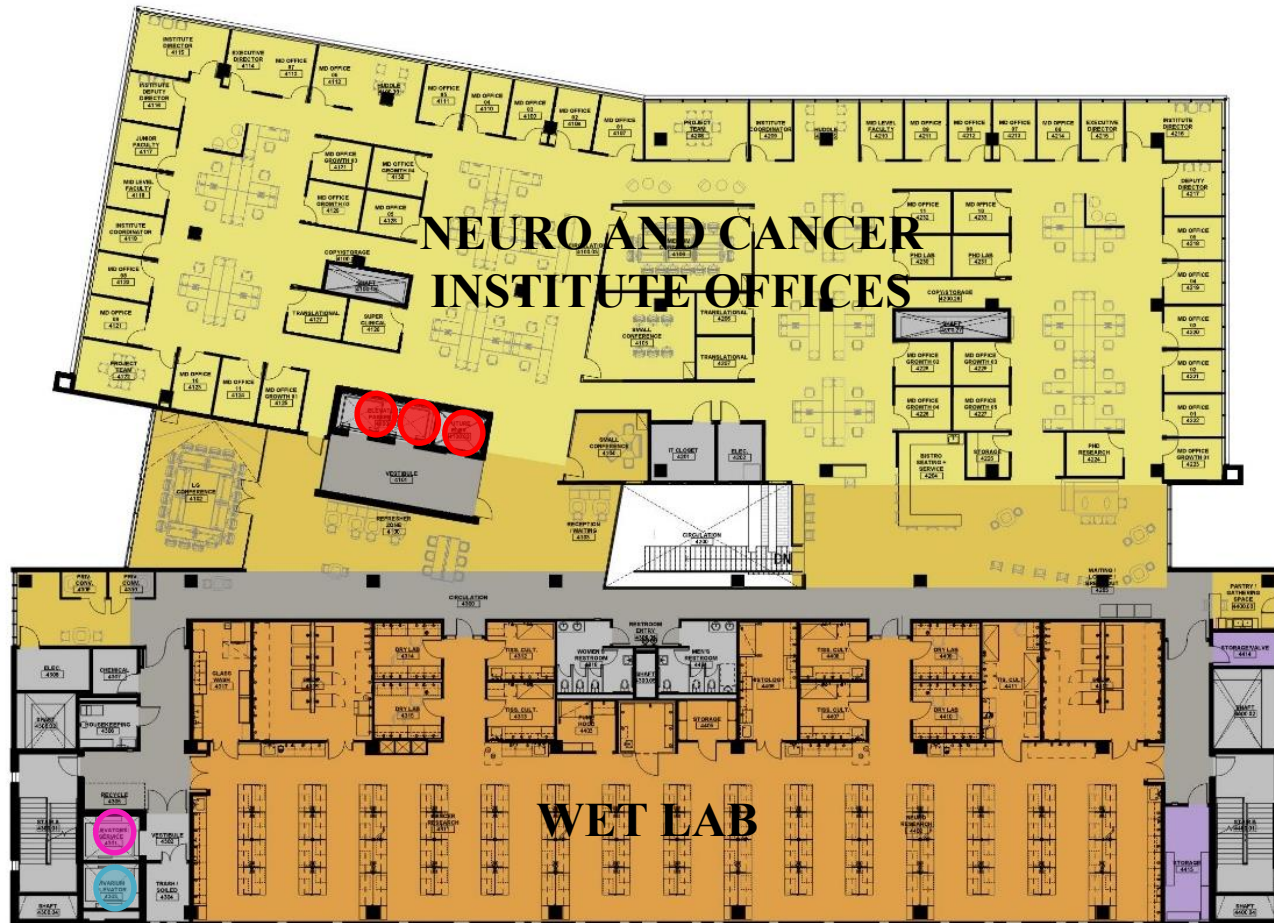

Critical Care Transport: LifeLine

- Goal: provide the most timely access to care possible
 - Impacted by the ability to provide:
 - Appropriate team available to respond 24/7
 - Medical Control
 - Advanced medical technology on transport
 - Timely access for emergent requests for care
 - Directly related to the control of the mode of transport
 - LifeLine introduced in July 2016



Academic FY2017

- Recruitment of people
- Investment in technology/innovation
- Evolution to world class care
- Welcoming new residents; graduating our first JHACH residency class
- Increasing patient access to research



JOHNS HOPKINS
M E D I C I N E

**JOHNS HOPKINS
ALL CHILDREN'S HOSPITAL**



all we do. all for kids.™

HopkinsAllChildrens.org