

# Case CW21-12

## Map 1: Location Map



**JURISDICTION:** Pinellas County **FROM:** Retail & Services

**AREA:** 0.65 Acres

**TO:** Residential Low Medium

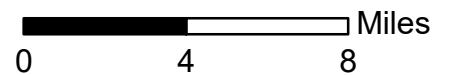

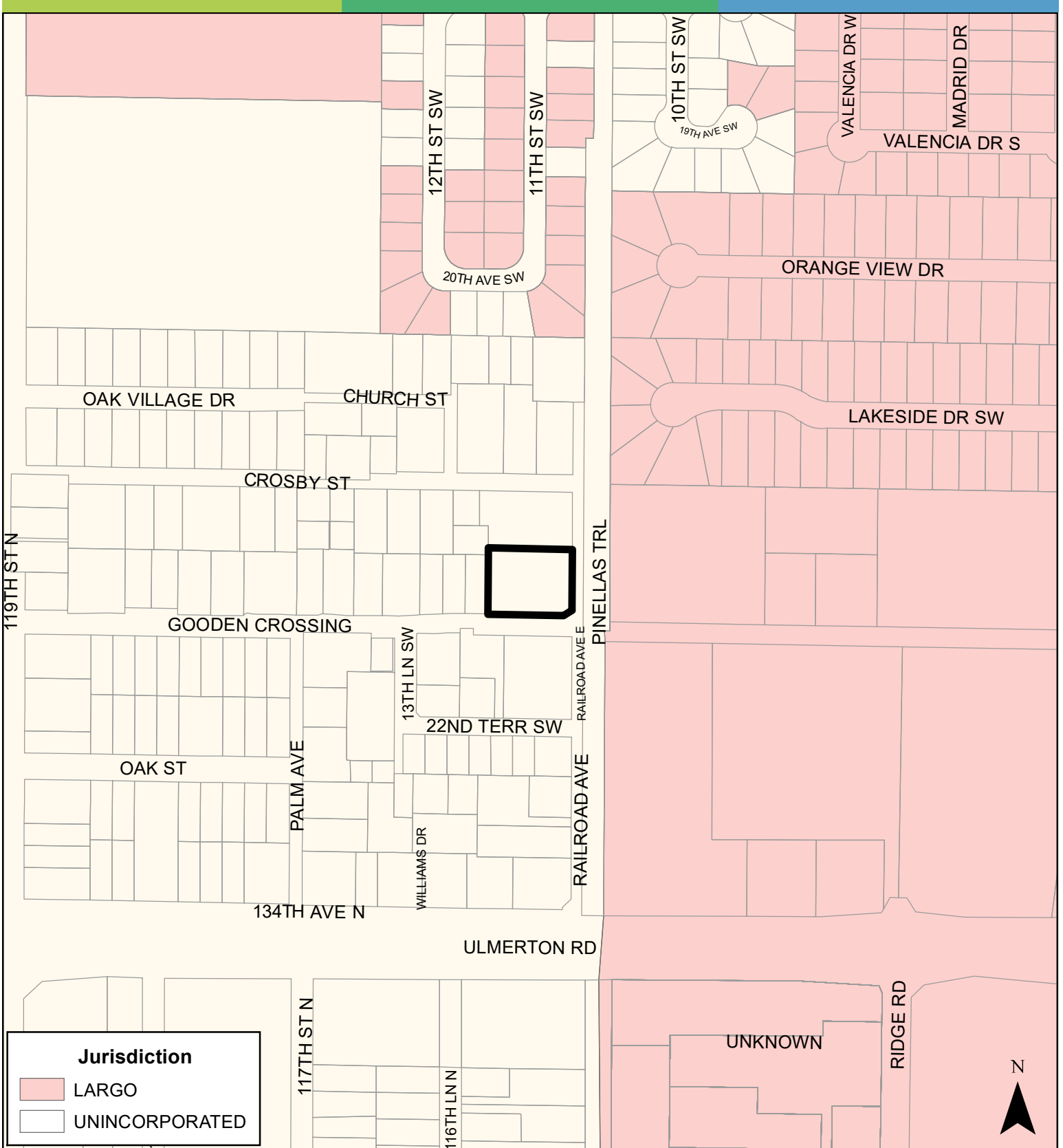

**JURISDICTION:** Pinellas County **FROM:** Retail & Services

**AREA:** 0.65 Acres

**TO:** Residential Low Medium

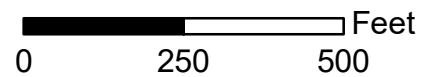

# Case CW21-12

## Map 3: Aerial Map



**JURISDICTION:** Pinellas County **FROM:** Retail & Services

**AREA:** 0.65 Acres

**TO:** Residential Low Medium

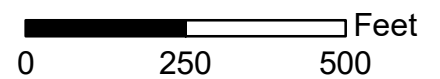

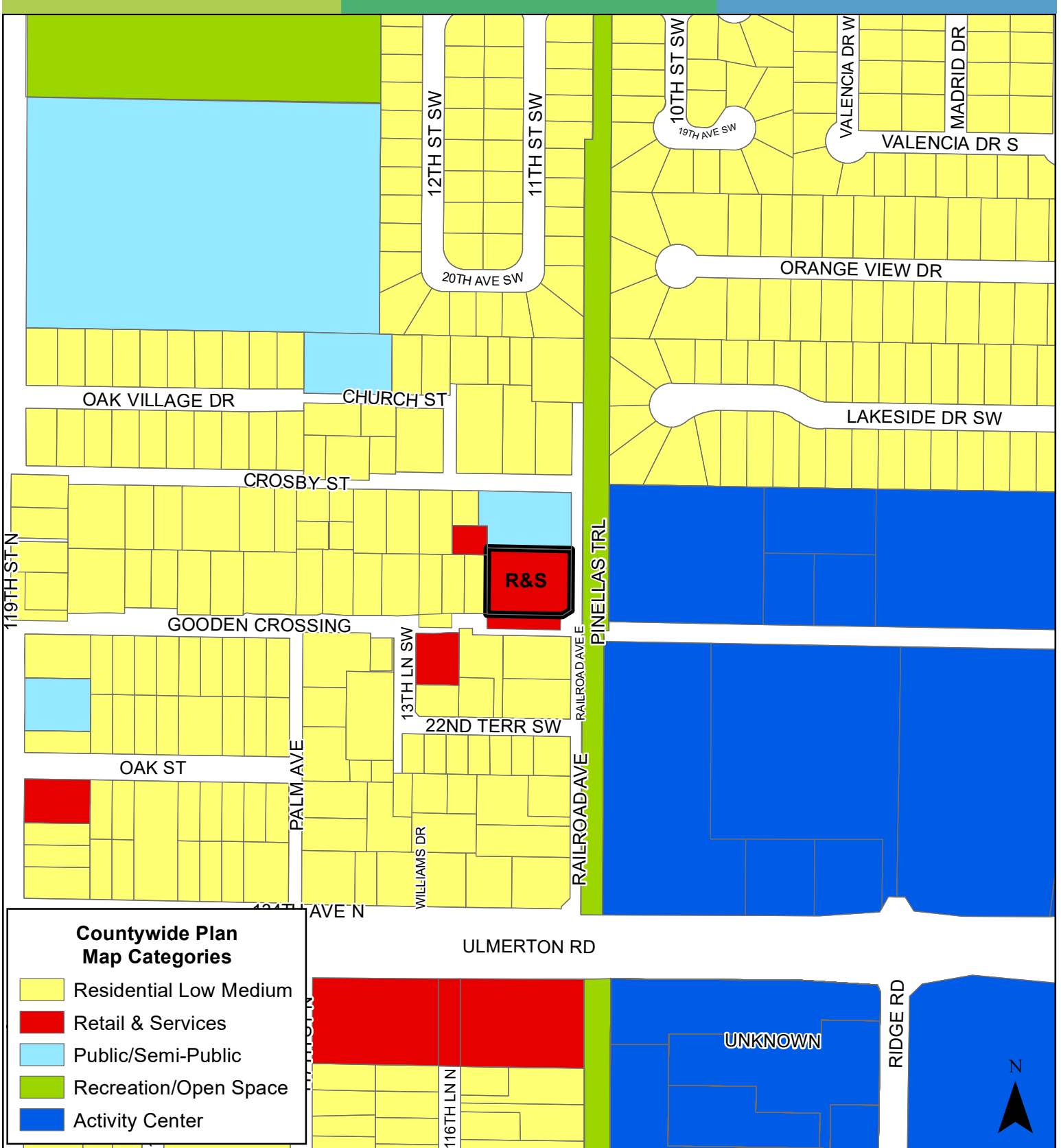

**JURISDICTION:** Pinellas County **FROM:** Retail & Services

**AREA:** 0.65 Acres

**TO:** Residential Low Medium

